



Walder Close, Bolney, Haywards Heath RH17 5SH

welcome to

Walder Close, Bolney, Haywards Heath

Guide Price £850,000 - £900,00 This stunning four bedroom detached home offers a modern open-plan kitchen/dining area, living room, office, cloakroom, master bedroom with dressing area and en-suite, bedroom two with en-suite, two further bedrooms, family bathroom, double garage and driveway parking.





Ground Floor



First Floor

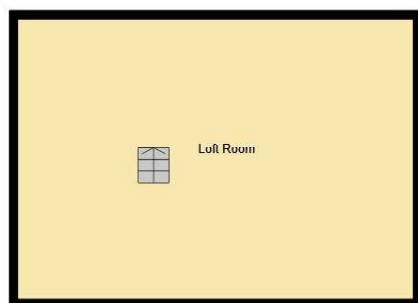

Second Floor

Total floor area 293.3 m² (3,157 sq.ft.) approx

This floor plan is for illustrative purposes only. It is not drawn to scale. Any measurements, floor areas (including any total floor area), openings and orientation are approximate. No details are guaranteed, they cannot be relied upon for any purpose and they do not form part of any agreement. No liability is taken for any error, omission or misstatement. A party must rely upon its own inspection(s). Powered by www.focalagent.com

Kitchen / Dining Room

24' 3" at max x 17' 10" at max (7.39m at max x 5.44m at max)

Living Room

16' 4" x 13' (4.98m x 3.96m)

Office

10' 6" x 6' 6" (3.20m x 1.98m)

W.C.

Bedroom 1

19' 5" to window x 15' 2" to window (5.92m to window x 4.62m to window)

Dressing Area

9' 11" x 8' 6" (3.02m x 2.59m)

En-Suite

Bedroom 2

14' x 10' 7" (4.27m x 3.23m)

En-Suite

Bedroom 3

14' 2" x 9' 5" (4.32m x 2.87m)

Bedroom 4

11' 7" x 9' 8" (3.53m x 2.95m)

Bathroom

Garage

20' 1" at max x 20' 1" at max (6.12m at max x 6.12m at max)

welcome to

Walder Close, Bolney Haywards Heath

- Guide Price £850,000 - £900,000
- Exceptional four bedroom detached house in peaceful development
- Modern open-plan kitchen/dining room with integrated appliances
- Spacious living room with French doors to the garden
- Galleried landing and luxurious master suite with dressing area and en-suite
- Large rear garden, patio, double garage and driveway parking
- Home office, ground floor WC and large boarded loft area
- Bolney has easy access to countryside walks and Haywards Heath station with direct links to London and the South Coast

Tenure: Freehold EPC Rating: C

Council Tax Band: G

guide price

£850.000-£900.000



Please note the marker reflects the postcode not the actual property

view this property online fox-and-sons.co.uk/Property/HHT110062



Property Ref:
HHT110062 - 0009

1. MONEY LAUNDERING REGULATIONS Intending purchasers will be asked to produce identification documentation at a later stage and we would ask for your co-operation in order that there is no delay in agreeing the sale. 2. These particulars do not constitute part or all of an offer or contract. 3. The measurements indicated are supplied for guidance only and as such must be considered incorrect. Potential buyers are advised to recheck measurements before committing to any expense. 4. We have not tested any apparatus, equipment, fixtures or services and it is in the buyers interest to check the working condition of any appliances. 5. Where an EPC, or a Home Report (Scotland only) is held for this property, it is available for inspection at the branch by appointment. If you require a printed version of a Home Report, you will need to pay a reasonable production charge reflecting printing and other costs. 6. We are not able to offer an opinion either written or verbal on the content of these reports and this must be obtained from your legal representative. 7. Whilst we take care in preparing these reports, a buyer should ensure that his/her legal representative confirms as soon as possible all matters relating to title including the extent and boundaries of the property and other important matters before exchange of contracts.

Fox & Sons is a trading name of Sequence (UK) Limited which is registered in England and Wales under company number 4268443, Registered Office is Cumbria House, 16-20 Hockliffe Street, Leighton Buzzard, Bedfordshire, LU7 1GN. VAT Registration Number is 500 2481 05.

fox & sons



01444 450105



HaywardsHeath@fox-and-sons.co.uk



115 South Road, HAYWARDS HEATH, West
Sussex, RH16 4LR



fox-and-sons.co.uk