



Stewart Close, Haywards Heath RH16 4ZQ

welcome to

Stewart Close, Haywards Heath

Guide Price £450,000 - £465,000... This three bedroom semi-detached home offers a bright living space, a modern kitchen/diner with built in appliances, a south facing paved garden perfect for entertaining, family bathroom, downstairs W.C. and two allocated parking spaces, this is a must see!



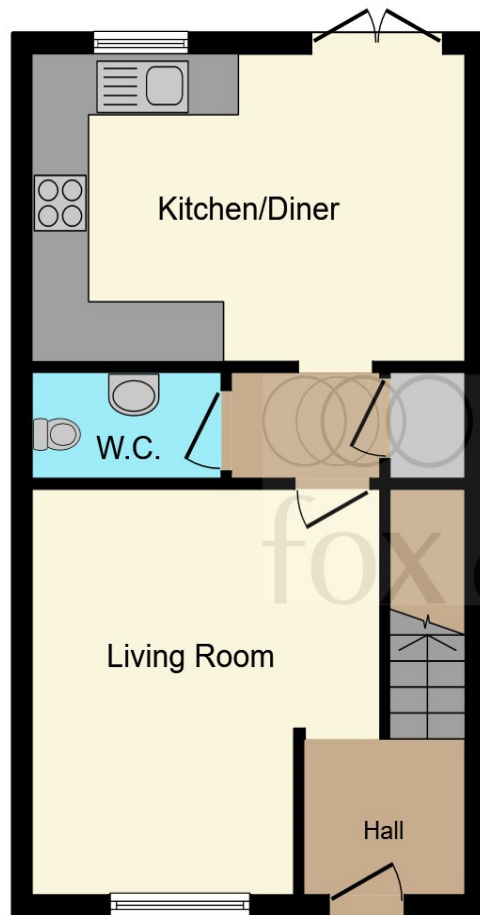

Ground Floor

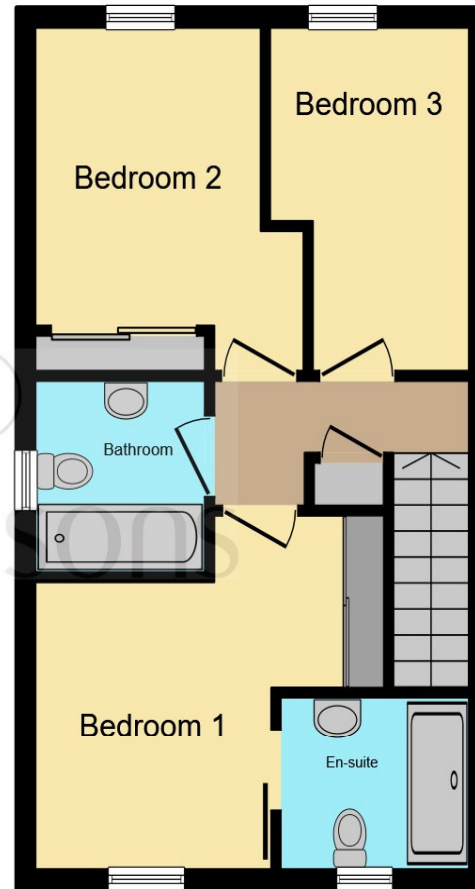

First Floor

Living Room

13' at max x 11' 8" at max (3.96m at max x 3.56m at max)

Kitchen / Diner

15' 1" x 9' 10" (4.60m x 3.00m)

W.C.

Bedroom 1

12' 1" at max x 9' 10" at max (3.68m at max x 3.00m at max)

En Suite

Bedroom 2

9' 6" at max x 8' 8" at max (2.90m at max x 2.64m at max)

Bedroom 3

9' 6" at max x 6' 9" at max (2.90m at max x 2.06m at max)

Bathroom

Total floor area 75.9 m² (817 sq.ft.) approx

This floor plan is for illustrative purposes only. It is not drawn to scale. Any measurements, floor areas (including any total floor area), openings and orientation are approximate. No details are guaranteed, they cannot be relied upon for any purpose and they do not form part of any agreement. No liability is taken for any error, omission or misstatement. A party must rely upon its own inspection(s). Powered by www.focalagent.com

welcome to

Stewart Close, Haywards Heath

- Guide Price £450,000 - £465,000
- Bright and spacious three bedroom semi-detached house
- Entrance hall leading into a bright living room
- Modern kitchen/diner with upgraded units and built in appliances
- Double doors opening onto a south facing paved garden
- Contemporary family bathroom and en-suite to bedroom one on the first floor and W.C. on the ground floor.
- Two allocated parking spaces at the front of the property
- Situated in a sought after area overlooking woodlands

Tenure: Freehold EPC Rating: B Council Tax Band: D

guide price

£450,000-£465,000



Please note the marker reflects the postcode not the actual property

view this property online fox-and-sons.co.uk/Property/HHT109802



Property Ref:
HHT109802 - 0004

1. MONEY LAUNDERING REGULATIONS Intending purchasers will be asked to produce identification documentation at a later stage and we would ask for your co-operation in order that there is no delay in agreeing the sale. 2. These particulars do not constitute part or all of an offer or contract. 3. The measurements indicated are supplied for guidance only and as such must be considered incorrect. Potential buyers are advised to recheck measurements before committing to any expense. 4. We have not tested any apparatus, equipment, fixtures or services and it is in the buyers interest to check the working condition of any appliances. 5. Where an EPC, or a Home Report (Scotland only) is held for this property, it is available for inspection at the branch by appointment. If you require a printed version of a Home Report, you will need to pay a reasonable production charge reflecting printing and other costs. 6. We are not able to offer an opinion either written or verbal on the content of these reports and this must be obtained from your legal representative. 7. Whilst we take care in preparing these reports, a buyer should ensure that his/her legal representative confirms as soon as possible all matters relating to title including the extent and boundaries of the property and other important matters before exchange of contracts.

Fox & Sons is a trading name of Sequence (UK) Limited which is registered in England and Wales under company number 4268443, Registered Office is Cumbria House, 16-20 Hockliffe Street, Leighton Buzzard, Bedfordshire, LU7 1GN. VAT Registration Number is 500 2481 05.

fox & sons



01444 450105



HaywardsHeath@fox-and-sons.co.uk



115 South Road, HAYWARDS HEATH, West
Sussex, RH16 4LR



fox-and-sons.co.uk