



Loders, Ardingly, Haywards Heath RH17 6UD

welcome to

Loders, Ardingly, Haywards Heath

A bright and well laid out two double bedroom first floor apartment with lounge and separate kitchen. This wonderful property boasts a large very private garden with patio area and shed. Additional benefits include a convenient garage and is offered with no on-going chain in this tranquil village.



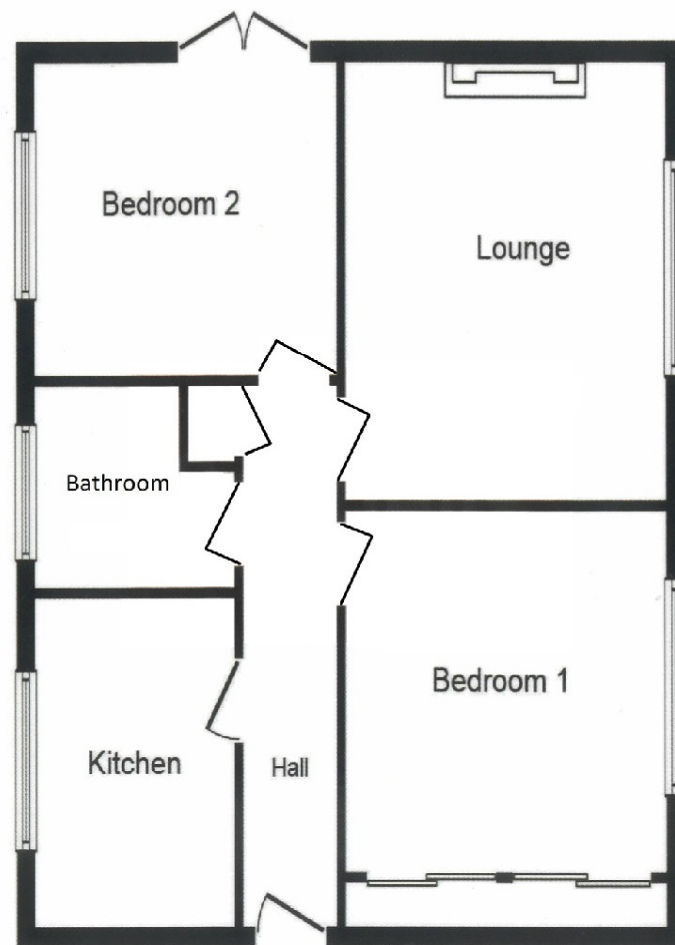

Floor Plan

Lounge

13' 11" at max x 11' 11" (4.24m at max x 3.63m)

Kitchen

10' 4" x 7' 5" (3.15m x 2.26m)

Bedroom 1

11' 11" x 11' 4" (3.63m x 3.45m)

Bedroom 2

11' 3" x 9' 10" (3.43m x 3.00m)

Bathroom

This floor plan is for illustrative purposes only. It is not drawn to scale. Any measurements, floor areas (including any total floor area), openings and orientation are approximate. No details are guaranteed, they cannot be relied upon for any purpose and they do not form part of any agreement. No liability is taken for any error, omission or misstatement. A party must rely upon its own inspection(s). Powered by

welcome to

Loders, Ardingly, Haywards Heath

- Peaceful village living
- Two double bedroom apartment
- Lounge and separate kitchen
- No on going chain
- Attractive garden with patio area
- Garage
- First floor
- Spiral staircase leading to the garden

Tenure: Leasehold EPC Rating: C

This is a Leasehold property. We are awaiting further details about the Term of the lease. For further information please contact the branch. Please note additional fees could be incurred for items such as Leasehold packs.

£300,000

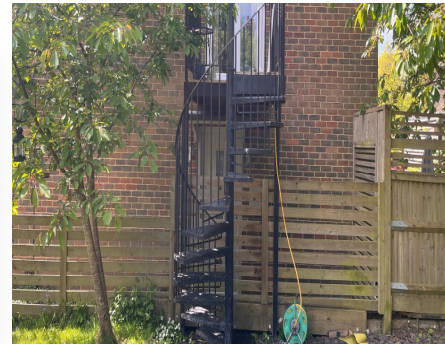

Please note the marker reflects the postcode not the actual property

view this property online fox-and-sons.co.uk/Property/HHT109747



Property Ref:
HHT109747 - 0004

1. MONEY LAUNDERING REGULATIONS Intending purchasers will be asked to produce identification documentation at a later stage and we would ask for your co-operation in order that there is no delay in agreeing the sale. 2. These particulars do not constitute part or all of an offer or contract. 3. The measurements indicated are supplied for guidance only and as such must be considered incorrect. Potential buyers are advised to recheck measurements before committing to any expense. 4. We have not tested any apparatus, equipment, fixtures or services and it is in the buyers interest to check the working condition of any appliances. 5. Where an EPC, or a Home Report (Scotland only) is held for this property, it is available for inspection at the branch by appointment. If you require a printed version of a Home Report, you will need to pay a reasonable production charge reflecting printing and other costs. 6. We are not able to offer an opinion either written or verbal on the content of these reports and this must be obtained from your legal representative. 7. Whilst we take care in preparing these reports, a buyer should ensure that his/her legal representative confirms as soon as possible all matters relating to title including the extent and boundaries of the property and other important matters before exchange of contracts.

Fox & Sons is a trading name of Sequence (UK) Limited which is registered in England and Wales under company number 4268443, Registered Office is Cumbria House, 16-20 Hockliffe Street, Leighton Buzzard, Bedfordshire, LU7 1GN. VAT Registration Number is 500 2481 05.

fox & sons



01444 450105



HaywardsHeath@fox-and-sons.co.uk



115 South Road, HAYWARDS HEATH, West
Sussex, RH16 4LR



fox-and-sons.co.uk