



Heather Close, North Wootton, King's Lynn, PE30 3RH

welcome to

Heather Close, North Wootton, King's Lynn

Beautifully Renovated Three Bedroom Bungalow Located in a Highly Desirable North Wootton. Viewing Highly Recommended!



Entrance Hall

Two Radiators, Storage Cupboard

Kitchen/Dining Room

24' 10" x 9' 4" (7.57m x 2.84m)

Wall and Base Units, Sink and Mixer Tap, Space for Dishwasher, Space for Freestanding Fridge/Freezer, Gas Hob, Double Oven, Double Glazed Window to Side, Bifolding Doors to Rear

Lounge

20' 5" x 12' 4" (6.22m x 3.76m)

Dual Aspect Windows One to Side and Double Glazed Bay Window to Rear, Log Burner, Two Radiators

Bedroom One

12' 11" x 12' 4" (3.94m x 3.76m)

Double Glazed Bay Window to Front, Radiator

Bedroom Two

10' x 9' 10" (3.05m x 3.00m)

Double Glazed Bay Window to Front, Radiator

Bedroom Three

10' x 6' 10" (3.05m x 2.08m)

Double Glazed Window to Side, radiator

Bathroom

Bath, Shower, WC, Hand Wash Basin, Heated Towel Rail and Radiator

Utility

9' 5" x 6' 6" (2.87m x 1.98m)

Base Units, Sink and Mixer Tap, Space for Washing Machine, Tumble Dryer and Fridge Freezer, Door to Garage, Door to Rear Garden

Outside

Driveway to Garage. Enclosed Rear Garden with Patio Area and Remainder Laid to Lawn with Decking Area and Studio

Garden Room

10' 9" x 10' 3" (3.28m x 3.12m)

Lighting and Electric, Window, Double Patio Doors to Garden

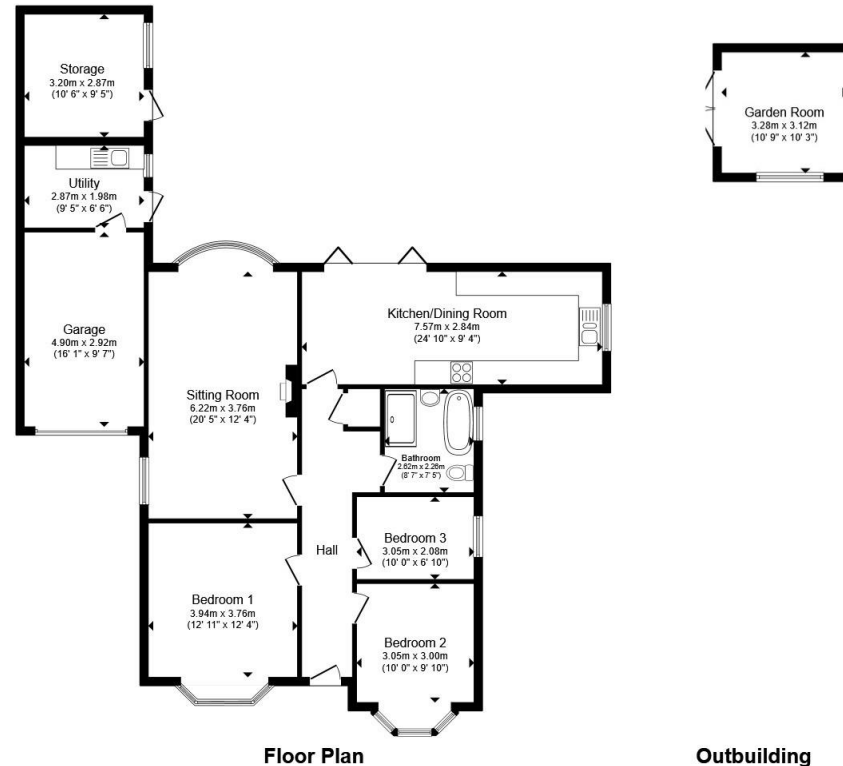

Total floor area 139.4 m² (1,501 sq.ft.) approx

This floor plan is for illustrative purposes only. It is not drawn to scale. Any measurements, floor areas (including any total floor area), openings and orientation are approximate. No details are guaranteed, they cannot be relied upon for any purpose and they do not form part of any agreement. No liability is taken for any error, omission or misstatement. A party must rely upon its own inspection(s). Powered by www.propertybox.io



welcome to

Heather Close, North Wootton, King's Lynn

- Beautifully Renovated Link Detached Bungalow Finished to an Exceptional Standard
- Located in the Highly Desirable Village of North Wootton
- Bright and Welcoming Hallway
- Generous Lounge filled with Natural Light
- Stunning Open Plan Kitchen/Dining Room

Tenure: Freehold EPC Rating: D
Council Tax Band: D



Please note the marker reflects the
postcode not the actual property

check out more properties at williamhbrown.co.uk



Property Ref:
KLN119509 - 0004

1. MONEY LAUNDERING REGULATIONS Intending purchasers will be asked to produce identification documentation at a later stage and we would ask for your co-operation in order that there is no delay in agreeing the sale. 2. These particulars do not constitute part or all of an offer or contract. 3. The measurements indicated are supplied for guidance only and as such must be considered incorrect. Potential buyers are advised to recheck measurements before committing to any expense. 4. We have not tested any apparatus, equipment, fixtures or services and it is in the buyers interest to check the working condition of any appliances. 5. Where an EPC, or a Home Report (Scotland only) is held for this property, it is available for inspection at the branch by appointment. If you require a printed version of a Home Report, you will need to pay a reasonable production charge reflecting printing and other costs. 6. We are not able to offer an opinion either written or verbal on the content of these reports and this must be obtained from your legal representative. 7. Whilst we take care in preparing these reports, a buyer should ensure that his/her legal representative confirms as soon as possible all matters relating to title including the extent and boundaries of the property and other important matters before exchange of contracts.

William H Brown is a trading name of Sequence (UK) Limited which is registered in England and Wales under company number 4268443, Registered Office is Cumbria House, 16-20 Hockliffe Street, Leighton Buzzard, Bedfordshire, LU7 1GN. VAT Registration Number is 500 2481 05.



01553 771337



KingsLynn@williamhbrown.co.uk



40-42 King Street, KING'S LYNN, Norfolk, PE30 1ES



williamhbrown.co.uk