



Punsfer Way, Tilney St. Lawrence, King's Lynn, PE34 4RJ

welcome to

Punsfer Way, Tilney St. Lawrence, King's Lynn

Located in the popular village of Tilney St Lawrence is this two bedroom mid terrace house which would suit a first time buyer or investor alike. This property is being offered with no onward chain.



Entrance Door To:-

Entrance Hall

Radiator, wood effect laminate floor

Kitchen

8' 5" x 7' 11" (2.57m x 2.41m)

Range of base and wall units, roll edge work top, inset stainless steel sink with mixer tap over, space for cooker, fridge freezer, washing machine and dryer, double glazed window

Lounge

15' 5" x 11' 9" (4.70m x 3.58m)

Wood effect laminate floor, stairs to first floor, double glazed window, door to rear

First Floor Landing

Bedroom One

12' 3" max x 11' 9" (3.73m max x 3.58m)

Double glazed window, radiator, storage space

Bedroom Two

11' 8" x 5' 7" (3.56m x 1.70m)

Double glazed window, radiator

Bathroom

8' 6" max x 5' 9" max (2.59m max x 1.75m max)

Bath, low level WC, wash hand basin, radiator, double glazed window, airing cupboard housing hot water tank

Outside

Enclosed rear garden. Single Garage and residents parking.

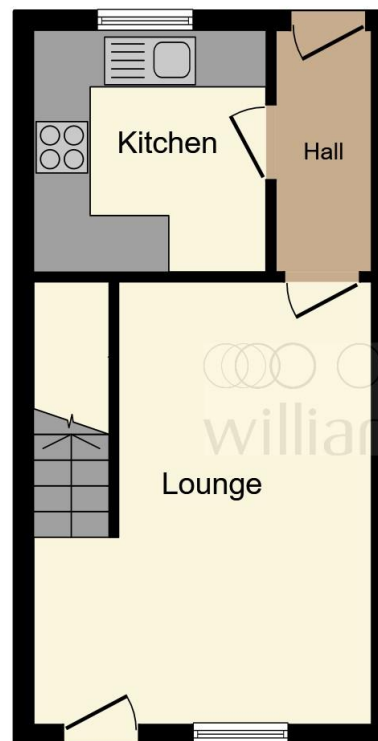

Ground Floor

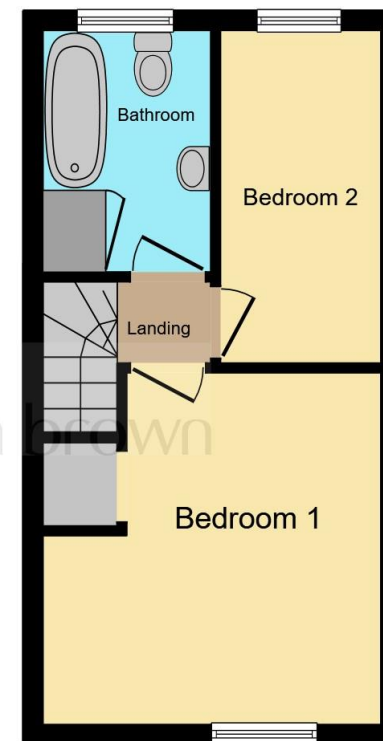

First Floor

This floor plan is for illustrative purposes only. It is not drawn to scale. Any measurements, floor areas (including any total floor area), openings and orientation are approximate. No details are guaranteed, they cannot be relied upon for any purpose and they do not form part of any agreement. No liability is taken for any error, omission or misstatement. A party must rely upon its own inspection(s). Powered by www.focalagent.com



view this property online williamhbrown.co.uk/Property/KLN119464



welcome to

Punsfer Way, Tilney St. Lawrence, King's Lynn

- Popular Village of Tilney St Lawrence
- Mid Terrace House
- Spacious Lounge
- Two Bedrooms
- Enclosed Garden

Tenure: Freehold EPC Rating: D
Council Tax Band: A

offers over
£150,000



Please note the marker reflects the
postcode not the actual property

view this property online [williamhbrown.co.uk/Property/KLN119464](https://www.williamhbrown.co.uk/Property/KLN119464)



Property Ref:
KLN119464 - 0005

1. MONEY LAUNDERING REGULATIONS Intending purchasers will be asked to produce identification documentation at a later stage and we would ask for your co-operation in order that there is no delay in agreeing the sale. 2. These particulars do not constitute part or all of an offer or contract. 3. The measurements indicated are supplied for guidance only and as such must be considered incorrect. Potential buyers are advised to recheck measurements before committing to any expense. 4. We have not tested any apparatus, equipment, fixtures or services and it is in the buyers interest to check the working condition of any appliances. 5. Where an EPC, or a Home Report (Scotland only) is held for this property, it is available for inspection at the branch by appointment. If you require a printed version of a Home Report, you will need to pay a reasonable production charge reflecting printing and other costs. 6. We are not able to offer an opinion either written or verbal on the content of these reports and this must be obtained from your legal representative. 7. Whilst we take care in preparing these reports, a buyer should ensure that his/her legal representative confirms as soon as possible all matters relating to title including the extent and boundaries of the property and other important matters before exchange of contracts.

William H Brown is a trading name of Sequence (UK) Limited which is registered in England and Wales under company number 4268443, Registered Office is Cumbria House, 16-20 Hockliffe Street, Leighton Buzzard, Bedfordshire, LU7 1GN. VAT Registration Number is 500 2481 05.



william h brown



01553 771337



KingsLynn@williamhbrown.co.uk



40-42 King Street, KING'S LYNN, Norfolk, PE30 1ES



[williamhbrown.co.uk](https://www.williamhbrown.co.uk)