



Tower Court, Tower Place, King's Lynn, PE30 5DF

welcome to

Tower Court, Tower Place, King's Lynn

Ideal first time buy or investment opportunity with this well presented two bedroom town house within walking distance of the town centre and is being offered with no onward chain. Viewing highly recommended.



Entrance Door To:-

Entrance Hall

Radiator, stairs to first floor, door to rear, opening to:-

Study Area

11' 2" x 8' (3.40m x 2.44m)

Cloakroom

Low level WC, wash hand basin, radiator

First Floor Landing

Radiator, double glazed window, stairs to 2nd floor

L-Shaped Lounge/Kitchen

25' 11" max x 15' 5" max (7.90m max x 4.70m max)

Kitchen area has base and wall units, roll edge work top, inset ceramic steel sink with mixer tap over, built-in oven, electric hob, extractor over, space for washing machine and fridge freezer, lounge area has two double glazed windows, radiator, storage cupboard, wood effect laminate floor,

2nd Floor Landing

Storage cupboard, skylight window

Bedroom One

14' 3" x 10' 11" (4.34m x 3.33m)

Double glazed window, radiator, storage cupboard

Bedroom Two

12' 2" x 8' 11" (3.71m x 2.72m)

Double glazed window, radiator, storage cupboard

Bathroom

8' 7" x 5' 4" (2.62m x 1.63m)

Bath with shower mixer tap and shower screen, low level Wc, wash hand basin, vinyl floor, heated towel rail, part tiled walls

Outside

Rear courtyard garden. Garage with up and over door, power and light

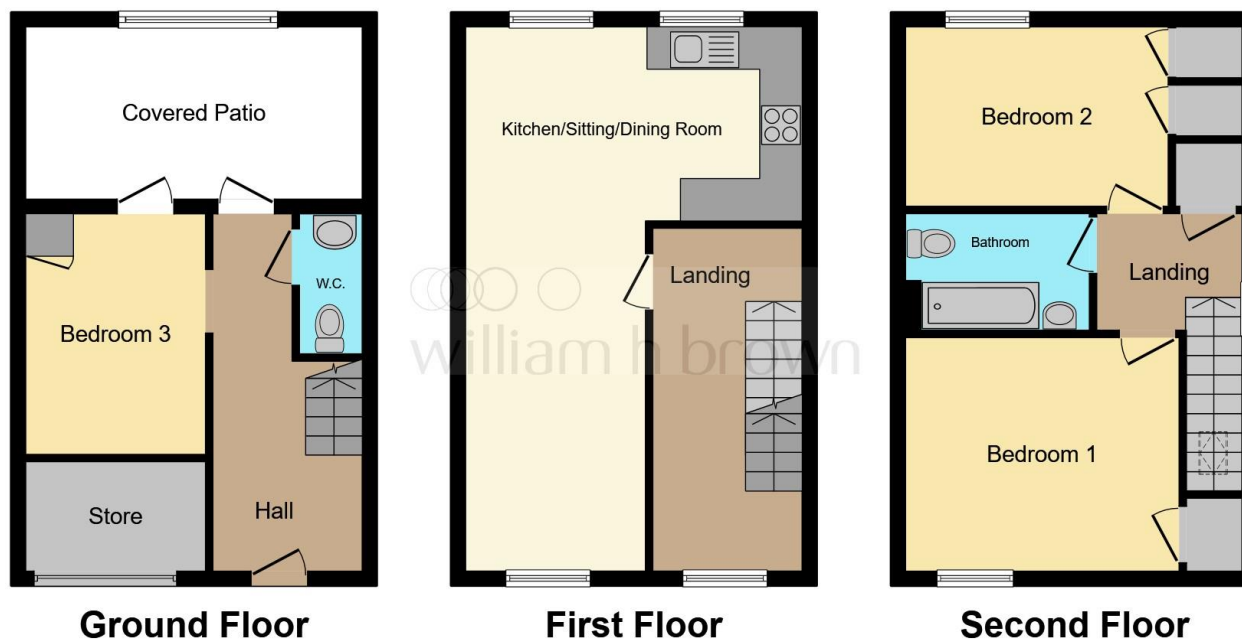

This floor plan is for illustrative purposes only. It is not drawn to scale. Any measurements, floor areas (including any total floor area), openings and orientation are approximate. No details are guaranteed, they cannot be relied upon for any purpose and they do not form part of any agreement. No liability is taken for any error, omission or misstatement. A party must rely upon its own inspection(s). Powered by www.focalagent.com



view this property online williamhbrown.co.uk/Property/KLN119184



welcome to

Tower Court, Tower Place, King's Lynn

- Tow Centre Location
- Three Storey Town House
- Two Bedrooms
- Open Plan Kitchen/Lounge Area
- Ground Floor Study Area and Cloakroom

Tenure: Freehold EPC Rating: B

Council Tax Band: B

£225,000



Please note the marker reflects the postcode not the actual property

view this property online williamhbrown.co.uk/Property/KLN119184



Property Ref:
KLN119184 - 0004

1. MONEY LAUNDERING REGULATIONS Intending purchasers will be asked to produce identification documentation at a later stage and we would ask for your co-operation in order that there is no delay in agreeing the sale. 2. These particulars do not constitute part or all of an offer or contract. 3. The measurements indicated are supplied for guidance only and as such must be considered incorrect. Potential buyers are advised to recheck measurements before committing to any expense. 4. We have not tested any apparatus, equipment, fixtures or services and it is in the buyers interest to check the working condition of any appliances. 5. Where an EPC, or a Home Report (Scotland only) is held for this property, it is available for inspection at the branch by appointment. If you require a printed version of a Home Report, you will need to pay a reasonable production charge reflecting printing and other costs. 6. We are not able to offer an opinion either written or verbal on the content of these reports and this must be obtained from your legal representative. 7. Whilst we take care in preparing these reports, a buyer should ensure that his/her legal representative confirms as soon as possible all matters relating to title including the extent and boundaries of the property and other important matters before exchange of contracts.

William H Brown is a trading name of Sequence (UK) Limited which is registered in England and Wales under company number 4268443, Registered Office is Cumbria House, 16-20 Hockliffe Street, Leighton Buzzard, Bedfordshire, LU7 1GN. VAT Registration Number is 500 2481 05.



william h brown



01553 771337



KingsLynn@williamhbrown.co.uk



40-42 King Street, KING'S LYNN, Norfolk, PE30 1ES



williamhbrown.co.uk