



**Rose Cottage, Marshland Street, Terrington St. Clement, King's Lynn, PE34 4NE**

**welcome to**

## **Rose Cottage, Marshland Street, Terrington St. Clement, King's Lynn**

Located in the popular village of Terrington St Clement and close to local amenities is this spacious two bedroom semi detached house which is being offered with no onward chain.

### **Double Glazed Entrance Door To**

#### **Lounge/ Diner**

19' 11" x 13' ( 6.07m x 3.96m )

Double glazed window, radiator, stairs to first floor

#### **Kitchen**

12' 5" max x 10' max ( 3.78m max x 3.05m max )

Range of base and wall units, roll edge work top, inset stainless steel sink with mixer tap over, built-in oven, electric hob, extractor over, space for fridge freezer and washing machine, wall mounted boiler, double glazed window, double glazed door to rear, ceramic tiled floor

#### **Bathroom**

6' 8" x 5' 7" ( 2.03m x 1.70m )

Shower, wash hand basin, low level WC, radiator, double glazed window, ceramic tiled floor

### **First Floor Landing**

#### **Bedroom One**

9' 8" x 13' 2" into recess ( 2.95m x 4.01m into recess )

Double glazed window, radiator

#### **Bedroom Two**

10' 2" x 9' 6" ( 3.10m x 2.90m )

Double glazed window, radiator

### **Outside**

To the front is an enclosed gravel garden with side gate giving access to the good size rear garden which is laid mainly to lawn and enclosed by timber fencing.

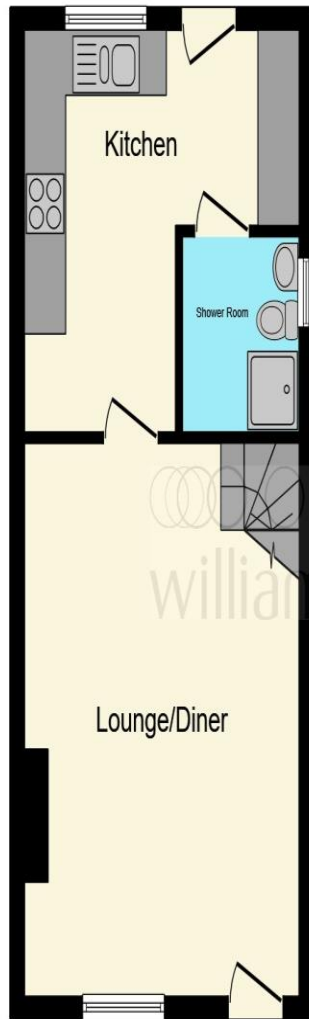

**Ground Floor**

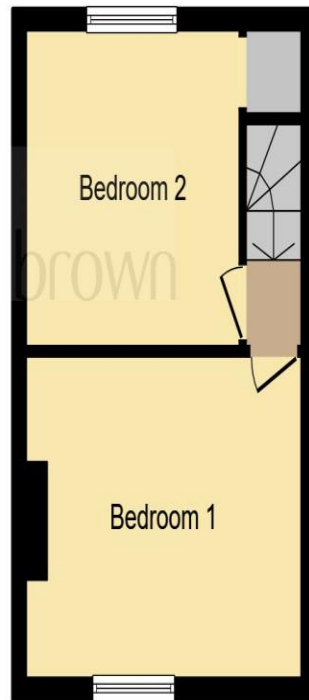

**First Floor**

This floor plan is for illustrative purposes only. It is not drawn to scale. Any measurements, floor areas (including any total floor area), openings and orientation are approximate. No details are guaranteed, they cannot be relied upon for any purpose and they do not form part of any agreement. No liability is taken for any error, omission or misstatement. A party must rely upon its own inspection(s). Powered by [www.focalagent.com](http://www.focalagent.com)



welcome to

**Rose Cottage Marshland Street,  
Terrington St. Clement King's Lynn**

- Popular Village of Terrington St Clement
- Semi Detached House
- Two Bedrooms
- Lounge/Dining Room
- Good Size Garden

Tenure: Freehold EPC Rating: F

**£180,000**



**view this property online** [williamhbrown.co.uk/Property/KLN118121](http://williamhbrown.co.uk/Property/KLN118121)



Property Ref:  
KLN118121 - 0009

1. MONEY LAUNDERING REGULATIONS Intending purchasers will be asked to produce identification documentation at a later stage and we would ask for your co-operation in order that there is no delay in agreeing the sale. 2. These particulars do not constitute part or all of an offer or contract. 3. The measurements indicated are supplied for guidance only and as such must be considered incorrect. Potential buyers are advised to recheck measurements before committing to any expense. 4. We have not tested any apparatus, equipment, fixtures or services and it is in the buyers interest to check the working condition of any appliances. 5. Where an EPC, or a Home Report (Scotland only) is held for this property, it is available for inspection at the branch by appointment. If you require a printed version of a Home Report, you will need to pay a reasonable production charge reflecting printing and other costs. 6. We are not able to offer an opinion either written or verbal on the content of these reports and this must be obtained from your legal representative. 7. Whilst we take care in preparing these reports, a buyer should ensure that his/her legal representative confirms as soon as possible all matters relating to title including the extent and boundaries of the property and other important matters before exchange of contracts.

William H Brown is a trading name of Sequence (UK) Limited which is registered in England and Wales under company number 4268443, Registered Office is Cumbria House, 16-20 Hockliffe Street, Leighton Buzzard, Bedfordshire, LU7 1GN. VAT Registration Number is 500 2481 05.



**william h brown**



**01553 771337**



[KingsLynn@williamhbrown.co.uk](mailto:KingsLynn@williamhbrown.co.uk)



40-42 King Street, KING'S LYNN, Norfolk, PE30 1ES



**[williamhbrown.co.uk](http://williamhbrown.co.uk)**