



Meadow Close, St. Leonards-On-Sea TN38 9QD

welcome to

Meadow Close, St. Leonards-On-Sea

The property has front courtyard garden with private front door into entrance hall, downstairs cloakroom, lounge, and dining room/kitchen whilst the first floor has three bedrooms and family bathroom. To the rear of the property is private paved gardens with flower beds and gated access.



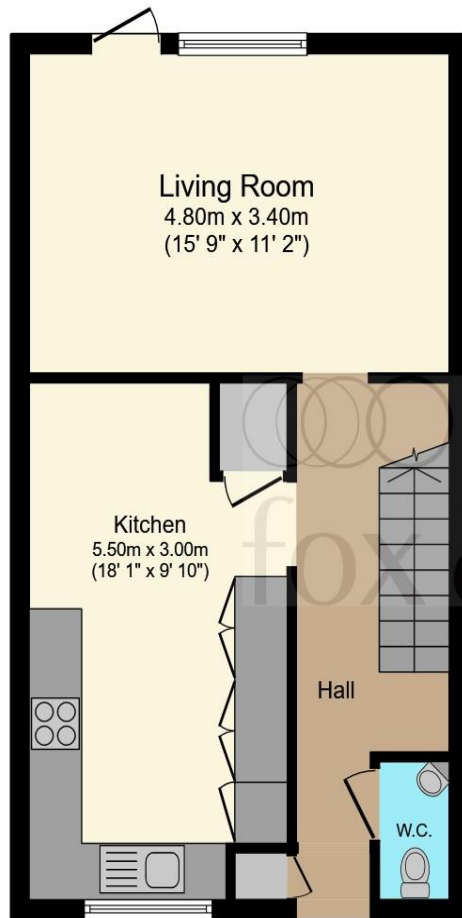

Ground Floor

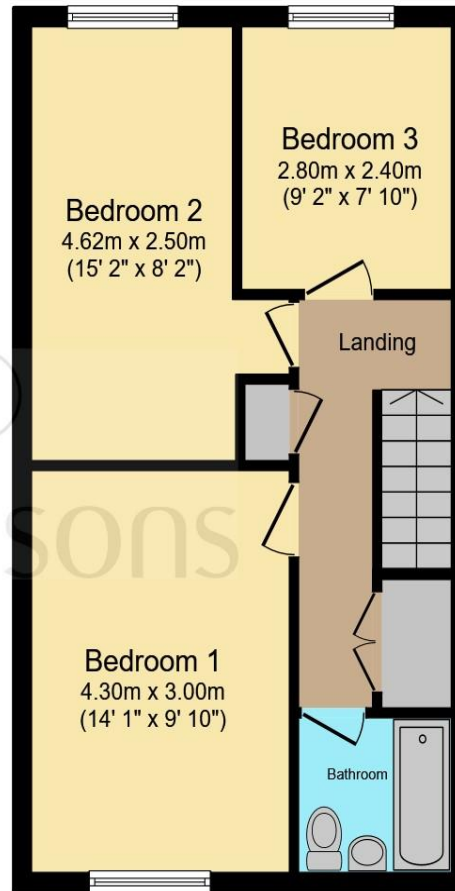

First Floor

Entrance Hall

Cloakroom

Lounge

15' 5" x 11' 9" (4.70m x 3.58m)

Kitchen / Dining Room

18' 1" x 9' 8" (5.51m x 2.95m)

First Floor Landing

Bedroom One

14' 4" x 9' 5" (4.37m x 2.87m)

Bedroom Two

15' 7" x 8' 3" (4.75m x 2.51m)

Bedroom Three

9' 6" x 7' 7" (2.90m x 2.31m)

Bathroom

Front Garden

Rear Garden

Total floor area 86.4 m² (930 sq.ft.) approx

This floor plan is for illustrative purposes only. It is not drawn to scale. Any measurements, floor areas (including any total floor area), openings and orientation are approximate. No details are guaranteed, they cannot be relied upon for any purpose and they do not form part of any agreement. No liability is taken for any error, omission or misstatement. A party must rely upon its own inspection(s). Powered by www.focalagent.com

welcome to

Meadow Close, St. Leonards-On-Sea

- END TERRACED HOUSE
- THREE BEDROOMS
- KITCHEN / DINING ROOM
- COURTYARD STYLE GARDEN
- PERFECT FIRST OR FAMILY HOME

Tenure: Freehold EPC Rating: Awaited
Council Tax Band: B

£270,000



Please note the marker reflects the
postcode not the actual property

view this property online fox-and-sons.co.uk/Property/HAS114395



Property Ref:
HAS114395 - 0002

1. MONEY LAUNDERING REGULATIONS Intending purchasers will be asked to produce identification documentation at a later stage and we would ask for your co-operation in order that there is no delay in agreeing the sale. 2. These particulars do not constitute part or all of an offer or contract. 3. The measurements indicated are supplied for guidance only and as such must be considered incorrect. Potential buyers are advised to recheck measurements before committing to any expense. 4. We have not tested any apparatus, equipment, fixtures or services and it is in the buyers interest to check the working condition of any appliances. 5. Where an EPC, or a Home Report (Scotland only) is held for this property, it is available for inspection at the branch by appointment. If you require a printed version of a Home Report, you will need to pay a reasonable production charge reflecting printing and other costs. 6. We are not able to offer an opinion either written or verbal on the content of these reports and this must be obtained from your legal representative. 7. Whilst we take care in preparing these reports, a buyer should ensure that his/her legal representative confirms as soon as possible all matters relating to title including the extent and boundaries of the property and other important matters before exchange of contracts.

Fox & Sons is a trading name of Sequence (UK) Limited which is registered in England and Wales under company number 4268443, Registered Office is Cumbria House, 16-20 Hockliffe Street, Leighton Buzzard, Bedfordshire, LU7 1GN. VAT Registration Number is 500 2481 05.

fox & sons



01424 722177



hastings@fox-and-sons.co.uk



33 Havelock Road, HASTINGS, East Sussex,
TN34 1BE



fox-and-sons.co.uk