

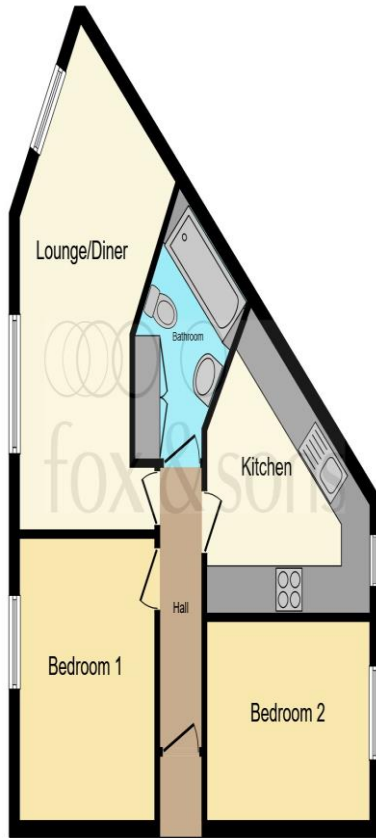

Crown Mews, Clarence Road, Gosport PO12 1DH



This floor plan is for illustrative purposes only. It is not drawn to scale. Any measurements, floor areas (including any total floor area), openings and orientation are approximate. No details are guaranteed, they cannot be relied upon for any purpose and they do not form part of any agreement. No liability is taken for any error, omission or misstatement. A party must rely upon its own inspection(s). Powered by www.localagent.com

welcome to Crown Mews Clarence Road, Gosport

- TWO DOUBLE BEDROOMS
- SITUATED IN THE TOWN CENTRE
- NO FORWARD CHAIN

Tenure: Leasehold

EPC Rating: D

This is a Leasehold property. We are awaiting further details about the Term of the lease. For further information please contact the branch. Please note additional fees could be incurred for items such as Leasehold packs.

- UNDERGROUND ALLOCATED PARKING
- DOUBLE GLAZING THROUGHOUT

Council Tax Band: C Service Charge: Ask Agent
Ground Rent: Ask Agent

£150,000



Entrance Hall

Lounge

21' 4" max x 9' 7" max (6.50m max x 2.92m max)

Kitchen

11' 2" max x 11' 1" max (3.40m max x 3.38m max)

Bedroom 1

9' 7" max x 10' 10" max (2.92m max x 3.30m max)



Bedroom 2

11' 3" max x 8' 4" max (3.43m max x 2.54m max)

Bathroom

Allocated Parking

view this property online fox-and-sons.co.uk/Property/GOS112501



Property Ref:

GOS112501 - 0003

1. MONEY LAUNDERING REGULATIONS Intending purchasers will be asked to produce identification documentation at a later stage and we would ask for your co-operation in order that there is no delay in agreeing the sale. 2. These particulars do not constitute part or all of an offer or contract. 3. The measurements indicated are supplied for guidance only and as such must be considered incorrect. Potential buyers are advised to recheck measurements before committing to any expense. 4. We have not tested any apparatus, equipment, fixtures or services and it is in the buyers interest to check the working condition of any appliances. 5. Where an EPC, or a Home Report (Scotland only) is held for this property, it is available for inspection at the branch by appointment. If you require a printed version of a Home Report, you will need to pay a reasonable production charge reflecting printing and other costs. 6. We are not able to offer an opinion either written or verbal on the content of these reports and this must be obtained from your legal representative. 7. Whilst we take care in preparing these reports, a buyer should ensure that his/her legal representative confirms as soon as possible all matters relating to title including the extent and boundaries of the property and other important matters before exchange of contracts.

Fox & Sons is a trading name of Sequence (UK) Limited which is registered in England and Wales under company number 4268443, Registered Office is Cumbria House, 16-20 Hockliffe Street, Leighton Buzzard, Bedfordshire, LU7 1GN. VAT Registration Number is 500 2481 05.



fox & sons



023 9250 3733



Gosport@fox-and-sons.co.uk



10 High Street, GOSPORT, Hampshire, PO12 1BX



fox-and-sons.co.uk