



**Compton Close, Lee-On-The-Solent, PO13 8JP**

**welcome to**

## **Compton Close, Lee-On-The-Solent**

\*\* Double Glazed \*\* Two Bedrooms \*\* No Onward Chain \*\* Conservatory \*\* Garage in a Block \*\*

### **Entrance Porch**

Double glazed front door leading to glazed inner door.

### **Lounge/Diner**

18' 10" x 12' 4" ( 5.74m x 3.76m )  
Double glazed window to front aspect, two radiators, stairs to the first floor.

### **Kitchen**

12' 4" x 8' 1" ( 3.76m x 2.46m )  
Range of wall and base level units, space for cooker, wall mounted gas boiler, space for fridge/freezer, space for washing machine, stainless steel single drainer sink unit with mixer tap, tiled surrounds, window and door to conservatory.

### **Conservatory**

9' 3" x 6' 3" ( 2.82m x 1.91m )  
Double glazed windows to side and rear aspect, double glazed door to rear garden.

### **On The First Floor**

Radiator, loft access.

### **Bedroom One**

12' 4" x 10' 4" ( 3.76m x 3.15m )  
Double glazed window to front aspect.

### **Bedroom Two**

12' 5" x 8' 2" ( 3.78m x 2.49m )  
Double glazed window to rear aspect.

### **Bathroom**

Panelled bath, low level WC, wash hand basin, double glazed window to side aspect, tiled floor and surrounds.

### **Rear Garden**

Laid to lawn, rear pedestrian access, side pedestrian access.





***view this property online*** [fox-and-sons.co.uk/Property/GOS111825](https://fox-and-sons.co.uk/Property/GOS111825)



welcome to

## Compton Close, Lee-On-The-Solent

- Cul-de-Sac Location
- Two Bedrooms
- Conservatory
- Fitted Kitchen
- Garage in a Block

Tenure: Freehold EPC Rating: D

**£270,000**

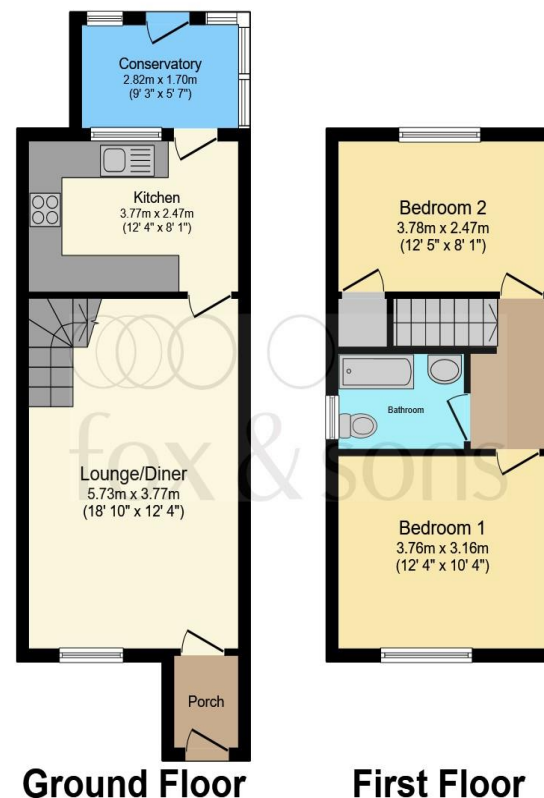

Total floor area 69.8 m<sup>2</sup> (752 sq.ft.) approx

This floor plan is for illustrative purposes only. It is not drawn to scale. Any measurements, floor areas (including any total floor area), openings and orientation are approximate. No details are guaranteed, they cannot be relied upon for any purpose and they do not form part of any agreement. No liability is taken for any error, omission or misstatement. A party must rely upon its own inspection(s). Powered by [www.focalagent.com](http://www.focalagent.com)

Total floor area 69.8 m<sup>2</sup> (752 sq.ft.) approx

view this property online [fox-and-sons.co.uk/Property/GOS111825](http://fox-and-sons.co.uk/Property/GOS111825)



Property Ref:  
GOS111825 - 0004

1. MONEY LAUNDERING REGULATIONS Intending purchasers will be asked to produce identification documentation at a later stage and we would ask for your co-operation in order that there is no delay in agreeing the sale. 2. These particulars do not constitute part or all of an offer or contract. 3. The measurements indicated are supplied for guidance only and as such must be considered incorrect. Potential buyers are advised to recheck measurements before committing to any expense. 4. We have not tested any apparatus, equipment, fixtures or services and it is in the buyers interest to check the working condition of any appliances. 5. Where an EPC, or a Home Report (Scotland only) is held for this property, it is available for inspection at the branch by appointment. If you require a printed version of a Home Report, you will need to pay a reasonable production charge reflecting printing and other costs. 6. We are not able to offer an opinion either written or verbal on the content of these reports and this must be obtained from your legal representative. 7. Whilst we take care in preparing these reports, a buyer should ensure that his/her legal representative confirms as soon as possible all matters relating to title including the extent and boundaries of the property and other important matters before exchange of contracts.

Fox & Sons is a trading name of Sequence (UK) Limited which is registered in England and Wales under company number 4268443, Registered Office is Cumbria House, 16-20 Hockliffe Street, Leighton Buzzard, Bedfordshire, LU7 1GN. VAT Registration Number is 500 2481 05.

fox & sons



**023 9250 3733**



Gosport@fox-and-sons.co.uk



10 High Street, GOSPORT, Hampshire, PO12 1BX



**fox-and-sons.co.uk**