



Elmore Close, Lee-On-The-Solent PO13 9ET

welcome to

Elmore Close, Lee-On-The-Solent

-- Three Bedroom End of Terrace -- No Onward Chain -- Open Plan Kitchen / Dining Room -- Gas Central Heating & Double Glazing -- Requested Location -- Close To Schools & Parks --

##Invalid Field Name##

Entrance Hall

Cloakroom

Lounge

12' 4" max x 11' 3" max (3.76m max x 3.43m max)

Kitchen / Diner

17' 6" max x 9' 4" max (5.33m max x 2.84m max)

First Floor Landing

Bedroom One

12' 5" max x 11' 4" max (3.78m max x 3.45m max)

Bedroom Two

11' 9" max x 11' 4" max (3.58m max x 3.45m max)

Bedroom Three

8' 5" max x 8' 3" max (2.57m max x 2.51m max)

Bathroom

Enclosed Rear Garden





view this property online fox-and-sons.co.uk/Property/GOS111584



welcome to

Elmore Close, Lee-On-The-Solent

- Three Bedroom End of Terrace
- No Onward Chain
- Open Plan Kitchen / Dining Room
- Gas Central Heating & Double Glazing
- Requested Location

Tenure: Freehold EPC Rating: D

offers over

£250,000

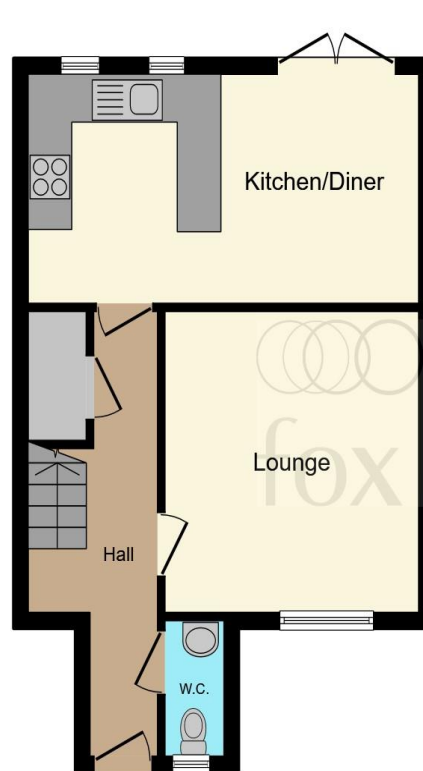

Ground Floor

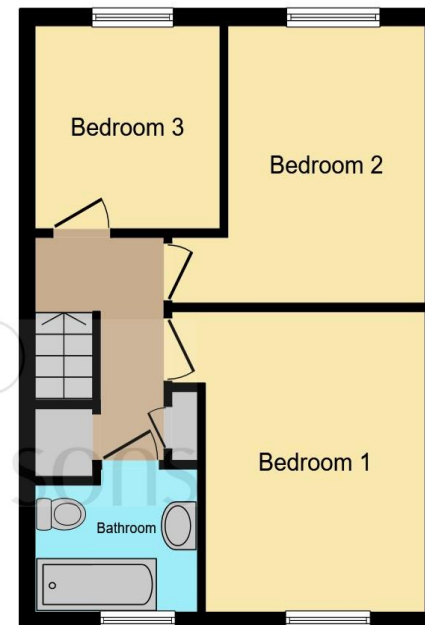

First Floor

This floor plan is for illustrative purposes only. It is not drawn to scale. Any measurements, floor areas (including any total floor area), openings and orientation are approximate. No details are guaranteed, they cannot be relied upon for any purpose and they do not form part of any agreement. No liability is taken for any error, omission or misstatement. A party must rely upon its own inspection(s). Powered by www.focalagent.com

view this property online fox-and-sons.co.uk/Property/GOS111584



Property Ref:
GOS111584 - 0005

1. MONEY LAUNDERING REGULATIONS Intending purchasers will be asked to produce identification documentation at a later stage and we would ask for your co-operation in order that there is no delay in agreeing the sale. 2. These particulars do not constitute part or all of an offer or contract. 3. The measurements indicated are supplied for guidance only and as such must be considered incorrect. Potential buyers are advised to recheck measurements before committing to any expense. 4. We have not tested any apparatus, equipment, fixtures or services and it is in the buyers interest to check the working condition of any appliances. 5. Where an EPC, or a Home Report (Scotland only) is held for this property, it is available for inspection at the branch by appointment. If you require a printed version of a Home Report, you will need to pay a reasonable production charge reflecting printing and other costs. 6. We are not able to offer an opinion either written or verbal on the content of these reports and this must be obtained from your legal representative. 7. Whilst we take care in preparing these reports, a buyer should ensure that his/her legal representative confirms as soon as possible all matters relating to title including the extent and boundaries of the property and other important matters before exchange of contracts.

fox & sons



023 9250 3733



Gosport@fox-and-sons.co.uk



10 High Street, GOSPORT, Hampshire, PO12 1BX



fox-and-sons.co.uk