



Desborough Road, Eastleigh SO50 5NY

welcome to
Desborough Road, Eastleigh

Beautifully presented three-bedroom home in a prime central location. Features include a spacious lounge with bay windows, modern kitchen/diner, stylish bathroom, and low-maintenance garden. Benefits from a garage with utility space and allocated parking. Ideal for families or investors.



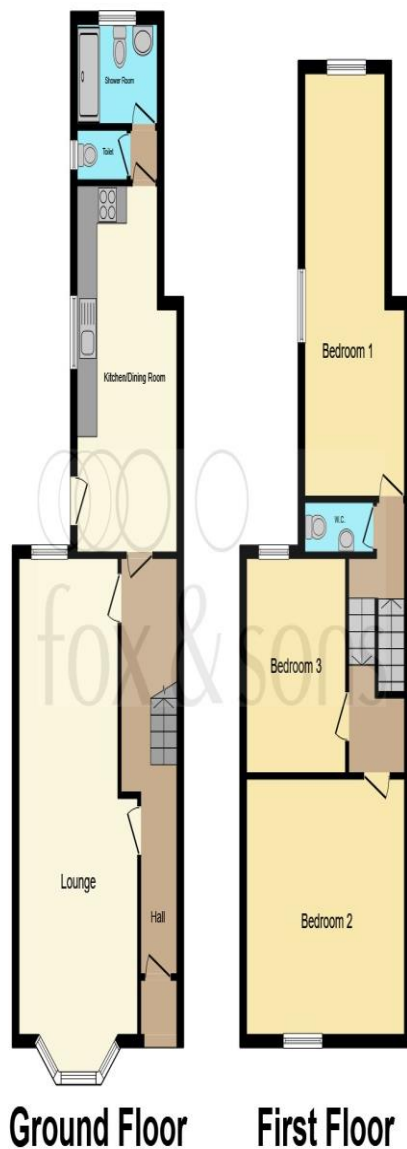

This floor plan is for illustrative purposes only. It is not drawn to scale. Any measurements, floor areas (including any total floor area), openings and orientation are approximate. No details are guaranteed, they cannot be relied upon for any purpose and they do not form part of any agreement. No liability is taken for any error, omission or misstatement. A party must rely upon its own inspection(s). Powered by www.focalagent.com



Entrance Hall

Lounge

25' 2" MAX x 11' 10" MAX (7.67m MAX x 3.61m MAX)

Kitchen/ Dining Room

19' 4" MAX x 9' 11" MAX (5.89m MAX x 3.02m MAX)

Cloakroom (ground Floor)

Bathroom

Landing

Bedroom 1

22' 3" MAX x 9' 10" MAX (6.78m MAX x 3.00m MAX)

Bedroom 2

15' 3" x 11' (4.65m x 3.35m)

Bedroom 3

11' 3" x 9' 10" (3.43m x 3.00m)

Upstairs Cloakroom

Front Garden

Rear Garden

Garage

18' 11" x 13' 3" (5.77m x 4.04m)

Parking

welcome to

Desborough Road, Eastleigh

- CENTRAL LOCATION
- THREE BEDROOMS
- TWO RECEPTIONS
- GARAGE & UTILITY AREA
- LOW MAINTENANCE GARDEN

Tenure: Leasehold EPC Rating: Awaited

Council Tax Band: B Service Charge: Ask Agent

Ground Rent: Ask Agent

This is a Leasehold property with details as follows; Term of Lease 999 years from 25 Mar 1896.

Should you require further information please contact the branch. Please Note additional fees could be incurred for items such as Leasehold packs.

£375,000



Please note the marker reflects the postcode not the actual property

view this property online fox-and-sons.co.uk/Property/ELH106593



Property Ref:
ELH106593 - 0002

1. MONEY LAUNDERING REGULATIONS Intending purchasers will be asked to produce identification documentation at a later stage and we would ask for your co-operation in order that there is no delay in agreeing the sale. 2. These particulars do not constitute part or all of an offer or contract. 3. The measurements indicated are supplied for guidance only and as such must be considered incorrect. Potential buyers are advised to recheck measurements before committing to any expense. 4. We have not tested any apparatus, equipment, fixtures or services and it is in the buyers interest to check the working condition of any appliances. 5. Where an EPC, or a Home Report (Scotland only) is held for this property, it is available for inspection at the branch by appointment. If you require a printed version of a Home Report, you will need to pay a reasonable production charge reflecting printing and other costs. 6. We are not able to offer an opinion either written or verbal on the content of these reports and this must be obtained from your legal representative. 7. Whilst we take care in preparing these reports, a buyer should ensure that his/her legal representative confirms as soon as possible all matters relating to title including the extent and boundaries of the property and other important matters before exchange of contracts.

Fox & Sons is a trading name of Sequence (UK) Limited which is registered in England and Wales under company number 4268443, Registered Office is Cumbria House, 16-20 Hockliffe Street, Leighton Buzzard, Bedfordshire, LU7 1GN. VAT Registration Number is 500 2481 05.

fox & sons



023 8061 8522



Eastleigh@fox-and-sons.co.uk



44 Market Street, EASTLEIGH, Hampshire, SO50 5RA



fox-and-sons.co.uk