



Lovell Court Mill Road, Eastbourne BN21 2LW

welcome to

Lovell Court Mill Road, Eastbourne

A one bedroom first floor flat forming part of this popular development in Upperton. Offered to the market CHAIN FREE, the flat benefits from an allocated parking space and lease in excess of 900 years.



Communal Entrance

Entrance Hall

Cupboard.

Lounge

15' 10" max x 10' max (4.83m max x 3.05m max)

Double glazed window to the front and side aspect.
Storage heater.

Kitchen

8' 7" max x 6' 5" max (2.62m max x 1.96m max)

A range of wall and base units with work top over incorporating a stainless steel sink and drainer unit.
Space for cooker. Space for fridge / freezer. Double glazed window to the rear aspect.

Bedroom

10' 10" max x 9' 7" max (3.30m max x 2.92m max)

Double glazed window to the front aspect. Storage heater.

Bathroom

Comprising a bath with mixer taps and over head shower attachment. Low level W.C. Wash hand basin.
Double glazed window to the rear aspect.

Parking

Allocated parking space.

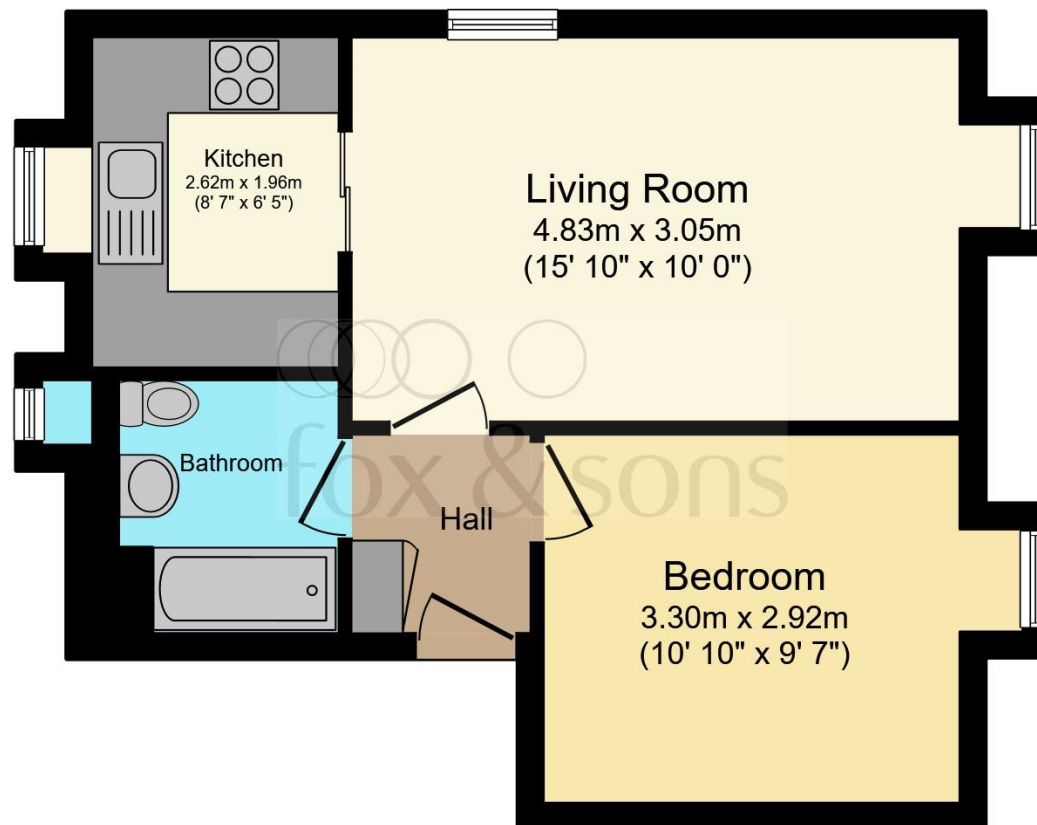

Total floor area 38.3 m² (412 sq.ft.) approx

This floor plan is for illustrative purposes only. It is not drawn to scale. Any measurements, floor areas (including any total floor area), openings and orientation are approximate. No details are guaranteed, they cannot be relied upon for any purpose and they do not form part of any agreement. No liability is taken for any error, omission or misstatement. A party must rely upon its own inspection(s). Powered by www.focalagent.com



view this property online fox-and-sons.co.uk/Property/EBN119685



welcome to

Lovell Court Mill Road, Eastbourne

- FIRST FLOOR FLAT
- ONE BEDROOM
- PURPOSE BUILT
- SOUGHT AFTER UPPERTON LOCATION
- CHAIN FREE

Tenure: Leasehold EPC Rating: Awaited

This is a Leasehold property with details as follows; Term of Lease 999 years from 01 Apr 1985. Should you require further information please contact the branch. Please Note additional fees could be incurred for items such as Leasehold packs.

£145,000



Please note the marker reflects the postcode not the actual property

view this property online fox-and-sons.co.uk/Property/EBN119685



Property Ref:
EBN119685 - 0002

1. MONEY LAUNDERING REGULATIONS Intending purchasers will be asked to produce identification documentation at a later stage and we would ask for your co-operation in order that there is no delay in agreeing the sale. 2. These particulars do not constitute part or all of an offer or contract. 3. The measurements indicated are supplied for guidance only and as such must be considered incorrect. Potential buyers are advised to recheck measurements before committing to any expense. 4. We have not tested any apparatus, equipment, fixtures or services and it is in the buyers interest to check the working condition of any appliances. 5. Where an EPC, or a Home Report (Scotland only) is held for this property, it is available for inspection at the branch by appointment. If you require a printed version of a Home Report, you will need to pay a reasonable production charge reflecting printing and other costs. 6. We are not able to offer an opinion either written or verbal on the content of these reports and this must be obtained from your legal representative. 7. Whilst we take care in preparing these reports, a buyer should ensure that his/her legal representative confirms as soon as possible all matters relating to title including the extent and boundaries of the property and other important matters before exchange of contracts.

Fox & Sons is a trading name of Sequence (UK) Limited which is registered in England and Wales under company number 4268443, Registered Office is Cumbria House, 16-20 Hockliffe Street, Leighton Buzzard, Bedfordshire, LU7 1GN. VAT Registration Number is 500 2481 05.

fox & sons



01323 410911



Eastbourne@fox-and-sons.co.uk



19 Cornfield Road, EASTBOURNE, East Sussex,
BN21 4QD



fox-and-sons.co.uk