



Falmer Close, EASTBOURNE BN20 9AB

Not for marketing purposes. INTERNAL USE ONLY

welcome to

Falmer Close, EASTBOURNE

This rarely available three bedroom semi detached house located within a quite cul-de-sac adjacent to Willingdon Golf Club in the most exclusive of locations in Ratton. Boasting three spacious reception rooms, en suite to master bedroom, garage and off road parking.



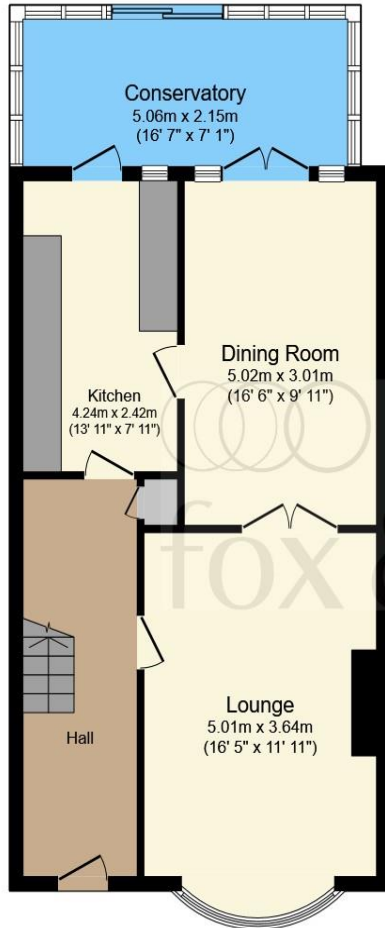

Ground Floor

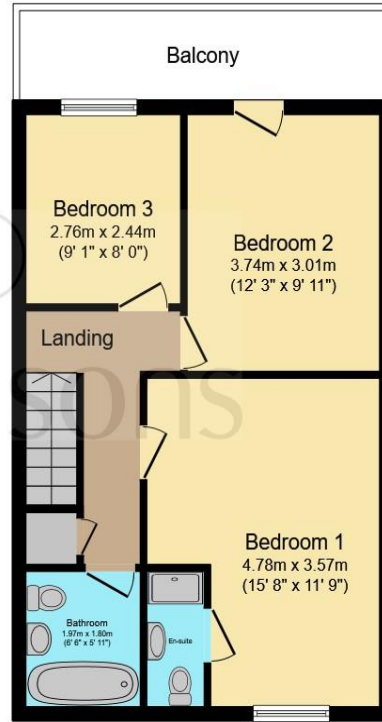

First Floor

Total floor area 116.7 m² (1,256 sq.ft.) approx

This floor plan is for illustrative purposes only. It is not drawn to scale. Any measurements, floor areas (including any total floor area), openings and orientation are approximate. No details are guaranteed, they cannot be relied upon for any purpose and they do not form part of any agreement. No liability is taken for any error, omission or misstatement. A party must rely upon its own inspection(s). Powered by www.focalagent.com

Entrance Hall

Lounge

11' 11" into recess x 16' 5" plus recess (3.63m into recess x 5.00m plus recess)

Dining Room

16' 5" x 7' 10" (5.00m x 2.39m)

Kitchen

13' 10" x 7' 11" (4.22m x 2.41m)

Upvc Conservatory

16' 7" x 6' 10" (5.05m x 2.08m)

Cloakroom

First Floor Landing

Bedroom 1

15' 8" max x 11' 8" max (4.78m max x 3.56m max)

En Suite

Bedroom 2

12' 3" x 9' 10" (3.73m x 3.00m)

Bedroom 3

9' max x 8' max (2.74m max x 2.44m max)

Bathroom

Rear Garden

Off Road Parking

-

welcome to

Falmer Close, EASTBOURNE

- RARELY AVAILABLE
- SEMI DETACHED HOUSE
- THREE BEDROOMS
- EN SUITE
- LOUNGE, DINING ROOM & CONSERVATORY

Tenure: Freehold EPC Rating: E

£485,000



Please note the marker reflects the postcode not the actual property

check out more properties at fox-and-sons.co.uk



Property Ref:
EBN118736 - 0002

1. MONEY LAUNDERING REGULATIONS Intending purchasers will be asked to produce identification documentation at a later stage and we would ask for your co-operation in order that there is no delay in agreeing the sale. 2. These particulars do not constitute part or all of an offer or contract. 3. The measurements indicated are supplied for guidance only and as such must be considered incorrect. Potential buyers are advised to recheck measurements before committing to any expense. 4. We have not tested any apparatus, equipment, fixtures or services and it is in the buyers interest to check the working condition of any appliances. 5. Where an EPC, or a Home Report (Scotland only) is held for this property, it is available for inspection at the branch by appointment. If you require a printed version of a Home Report, you will need to pay a reasonable production charge reflecting printing and other costs. 6. We are not able to offer an opinion either written or verbal on the content of these reports and this must be obtained from your legal representative. 7. Whilst we take care in preparing these reports, a buyer should ensure that his/her legal representative confirms as soon as possible all matters relating to title including the extent and boundaries of the property and other important matters before exchange of contracts.



01323 410911



Eastbourne@fox-and-sons.co.uk



19 Cornfield Road, EASTBOURNE, East Sussex,
BN21 4QD



fox-and-sons.co.uk