



Jevington House, Upperton Road, Eastbourne, BN21 1LW



welcome to

Jevington House, Upperton Road, Eastbourne

*****CASH BUYERS ONLY - 38 YEAR REMAINING LEASE TERM*****

Fox & Sons are delighted to present to market this two bedroom apartment enjoying spectacular far reaching views from the fourth floor of this popular development in Upperton.



Auctioneer's Comments

This property is offered through Modern Method of Auction. Should you view, offer or bid your data will be shared with the Auctioneer, iamsold Limited. This method requires both parties to complete the transaction within 56 days, allowing buyers to proceed with mortgage finance (subject to lending criteria, affordability and survey).

The buyer is required to sign a reservation agreement and make payment of a non-refundable Reservation Fee of 4.5% of the purchase price including VAT, subject to a minimum of £6600.00 including VAT. This fee is paid in addition to purchase price and will be considered as part of the chargeable consideration for the property in the calculation for stamp duty liability. Buyers will be required to complete an identification process with iamsold and provide proof of how the purchase would be funded.

The property has a Buyer Information Pack containing documents about the property. The documents may not tell you everything you need to know, so you must complete your own due diligence before bidding. A sample of the Reservation Agreement and terms and conditions are contained within this pack. The buyer will also make payment of £300 inc VAT towards the preparation cost of the pack.

The estate agent and auctioneer may recommend the services of other providers to you, in which they will be paid for the referral. These services are optional, and you will be advised of any payment, in writing before any services are accepted. Listing is subject to a start price and undisclosed reserve price that can change.

Communal Entrance Hall

Lift to all floors.

Entrance Hall

Entry phone system. Airing cupboard. Radiator.

Lounge

12' 11" x 15' 11" (3.94m x 4.85m)

Double glazed patio doors leading to balcony. Stunning views across Old Town. Radiator.

Kitchen

8' 8" x 7' 1" (2.64m x 2.16m)

A range of wall and base units with work top over incorporating a stainless steel sink and drainer unit. Electric oven and hob. Space and plumbing for washing machine. Boiler. Sea views.

Bedroom 1

12' 11" x 10' 9" (3.94m x 3.28m)

Double glazed window to the rear aspect. Fitted wardrobe. Radiator.

Bedroom 2

10' 7" x 8' 9" (3.23m x 2.67m)

Double glazed window to the side aspect. Sea views. Radiator.

Bathroom

Comprising a bath with mixer taps and over head shower attachment. Low level W.C. Wash hand basin. Heated towel rail. Double glazed window to the side aspect.

Balcony

Private balcony to the rear aspect. Stunning views across Old Town and the South Downs.

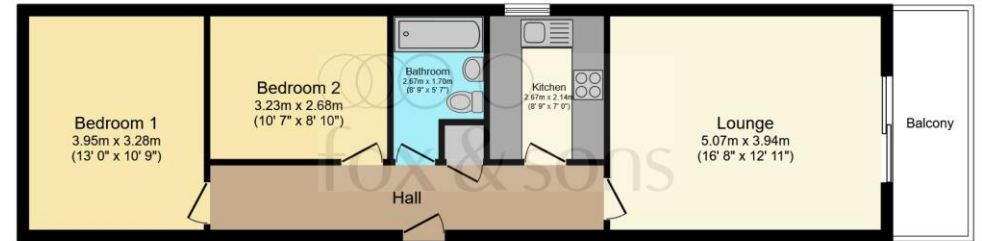

Total floor area 63.6 m² (685 sq.ft.) approx

This floor plan is for illustrative purposes only. It is not drawn to scale. Any measurements, floor areas (including any total floor area), openings and orientation are approximate. No details are guaranteed, they cannot be relied upon for any purpose and they do not form part of any agreement. No liability is taken for any error, omission or misstatement. A party must rely upon its own inspection(s). Powered by www.focalagent.com



view this property online fox-and-sons.co.uk/Property/EBN118847



welcome to

Jevington House, Upperton Road, Eastbourne

- Sale by Modern Auction (T&Cs apply)
- Subject to an undisclosed Reserve Price
- Buyers fees apply
- ***CASH BUYERS ONLY - 38 YEAR REMAINING LEASE TERM***
- TWO BEDROOM APARTMENT

Tenure: Leasehold EPC Rating: C

This is a Leasehold property. We are awaiting further details about the Term of the lease. For further information please contact the branch. Please note additional fees could be incurred for items such as Leasehold packs.

guide price

£100,000



Please note the marker reflects the postcode not the actual property

view this property online fox-and-sons.co.uk/Property/EBN118847



Property Ref:
EBN118847 - 0003

1. MONEY LAUNDERING REGULATIONS Intending purchasers will be asked to produce identification documentation at a later stage and we would ask for your co-operation in order that there is no delay in agreeing the sale. 2. These particulars do not constitute part or all of an offer or contract. 3. The measurements indicated are supplied for guidance only and as such must be considered incorrect. Potential buyers are advised to recheck measurements before committing to any expense. 4. We have not tested any apparatus, equipment, fixtures or services and it is in the buyers interest to check the working condition of any appliances. 5. Where an EPC, or a Home Report (Scotland only) is held for this property, it is available for inspection at the branch by appointment. If you require a printed version of a Home Report, you will need to pay a reasonable production charge reflecting printing and other costs. 6. We are not able to offer an opinion either written or verbal on the content of these reports and this must be obtained from your legal representative. 7. Whilst we take care in preparing these reports, a buyer should ensure that his/her legal representative confirms as soon as possible all matters relating to title including the extent and boundaries of the property and other important matters before exchange of contracts.

Fox & Sons is a trading name of Sequence (UK) Limited which is registered in England and Wales under company number 4268443, Registered Office is Cumbria House, 16-20 Hockliffe Street, Leighton Buzzard, Bedfordshire, LU7 1GN. VAT Registration Number is 500 2481 05.

fox & sons



01323 410911



Eastbourne@fox-and-sons.co.uk



19 Cornfield Road, EASTBOURNE, East Sussex,
BN21 4QD



fox-and-sons.co.uk