



**Fairfield Lodge Fairfield Road, Eastbourne BN20 7NF**



**welcome to**

**Fairfield Lodge Fairfield Road, Eastbourne**

Forming part of the prestigious retirement development in the incredibly sought after Meads - this well presented one bedroom third floor retirement apartment benefits from views of the stunning communal gardens.



### Communal Entrance

Communal entrance with security entry phone system. Stairs and lift to third floor private entrance door to:

### Entrance Hall

Entryphone. Built in cupboards with fixed shelving and hanging rails. Airing cupboard housing hot water cylinder.

### Living Room

17' 10" x 10' 4" ( 5.44m x 3.15m )

Double glazed door leading to communal gardens. Double glazed windows to the front with views over communal gardens. Electric storage heater. Television point.

### Kitchen

7' 10" x 6' 11" ( 2.39m x 2.11m )

Fitted kitchen with a range of wall and base units incorporating a one bowl stainless steel sink and drainer unit, built in electric hob and eye level oven, space for washing machine and fridge/freezer. Double glazed window to the side.

### Bedroom

14' 3" x 8' 11" ( 4.34m x 2.72m )

Double glazed windows to the side. Mirrored sliding wardrobes. Electric storage heater.

### Shower Room

Partly tiled suite comprising shower cubicle, low level w.c, wash hand basin with vanity unit, extractor fan and heated towel rail.

### Communal Facilities

Fairfield Lodge benefits from wonderful communal gardens, a residents lounge and laundry room and residents parking facilities.

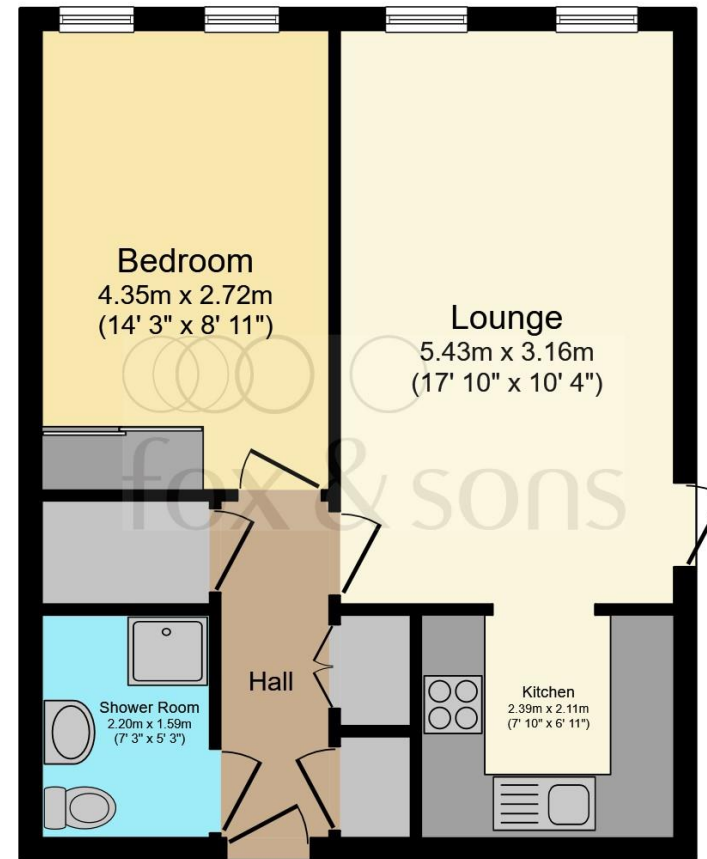

Total floor area 45.7 sq.m. (492 sq.ft.) approx

This floorplan is for illustrative purposes only and is not drawn to scale. Measurements, floor-areas, openings and orientations are approximate. They should not be relied upon for any purpose and do not form any part of an agreement. No liability is taken for any error or mis-statement. All parties must rely on their own inspections.



**view this property online** [fox-and-sons.co.uk/Property/EBN118712](http://fox-and-sons.co.uk/Property/EBN118712)



welcome to

## Fairfield Lodge Fairfield Road, Eastbourne

- RETIREMENT APARTMENT
- ONE BEDROOM
- THIRD FLOOR
- VIEWS OVER COMMUNAL GARDENS
- RESIDENTS PARKING

Tenure: Leasehold EPC Rating: C

This is a Leasehold property with details as follows; Term of Lease 189 years from 25 Mar 1987. Should you require further information please contact the branch. Please Note additional fees could be incurred for items such as Leasehold packs.

# £155,000



Please note the marker reflects the postcode not the actual property

view this property online [fox-and-sons.co.uk/Property/EBN118712](https://fox-and-sons.co.uk/Property/EBN118712)



Property Ref:  
EBN118712 - 0005

1. MONEY LAUNDERING REGULATIONS Intending purchasers will be asked to produce identification documentation at a later stage and we would ask for your co-operation in order that there is no delay in agreeing the sale. 2. These particulars do not constitute part or all of an offer or contract. 3. The measurements indicated are supplied for guidance only and as such must be considered incorrect. Potential buyers are advised to recheck measurements before committing to any expense. 4. We have not tested any apparatus, equipment, fixtures or services and it is in the buyers interest to check the working condition of any appliances. 5. Where an EPC, or a Home Report (Scotland only) is held for this property, it is available for inspection at the branch by appointment. If you require a printed version of a Home Report, you will need to pay a reasonable production charge reflecting printing and other costs. 6. We are not able to offer an opinion either written or verbal on the content of these reports and this must be obtained from your legal representative. 7. Whilst we take care in preparing these reports, a buyer should ensure that his/her legal representative confirms as soon as possible all matters relating to title including the extent and boundaries of the property and other important matters before exchange of contracts.

Fox & Sons is a trading name of Sequence (UK) Limited which is registered in England and Wales under company number 4268443, Registered Office is Cumbria House, 16-20 Hockliffe Street, Leighton Buzzard, Bedfordshire, LU7 1GN. VAT Registration Number is 500 2481 05.

fox & sons



01323 410911



Eastbourne@fox-and-sons.co.uk



19 Cornfield Road, EASTBOURNE, East Sussex,  
BN21 4QD



[fox-and-sons.co.uk](https://fox-and-sons.co.uk)