



**Tower House Silverdale Road, Burgess Hill, RH15 0EQ**



**welcome to**

**Tower House Silverdale Road, Burgess Hill**

**\*\*NO ONWARD CHAIN\*\***Two bedroom ground floor flat with 48 years left on lease and South West facing balcony. Located a stones throw away from Station and town Centre.



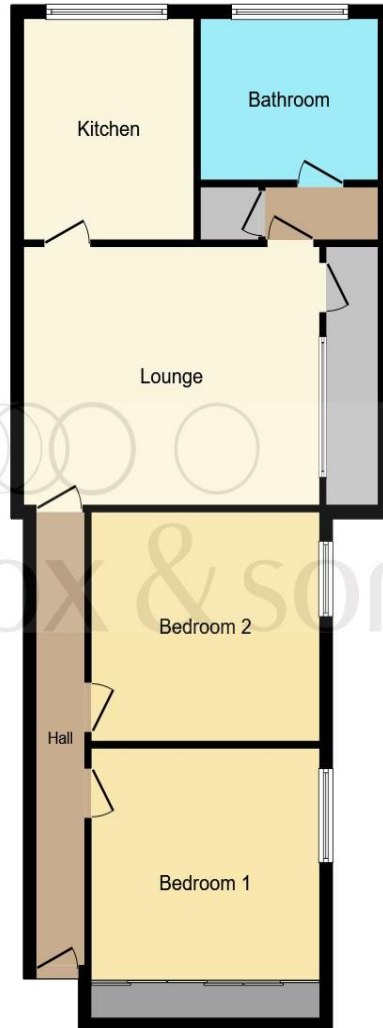

### **Lounge**

14' 6" x 13' 8" @ max ( 4.42m x 4.17m @ max )

### **Kitchen**

9' 10" x 7' ( 3.00m x 2.13m )

### **Bedroom One**

11' 1" @ max x 11' 8" @ max ( 3.38m @ max x 3.56m @ max )

### **Bedroom Two**

10' 8" x 8' 3" ( 3.25m x 2.51m )

### **Bathroom**

This floorplan is for illustrative purposes only and is not drawn to scale. Measurements, floor-areas, openings and orientations are approximate. They should not be relied upon for any purpose and do not form any part of an agreement. No liability is taken for any error or mis-statement. All parties must rely on their own inspections.

welcome to

## Tower House Silverdale Road, Burgess Hill

- No Onward Chain
- Ground Floor Apartment
- Two Double Bedrooms
- Lounge with South West Facing Balcony
- Close to Train Station

Tenure: Leasehold EPC Rating: E

**£200,000**



Please note the marker reflects the postcode not the actual property

**view this property online** [fox-and-sons.co.uk/Property/BUH105093](https://fox-and-sons.co.uk/Property/BUH105093)

This is a Leasehold property with details as follows; Term of Lease 99 years from 29 Nov 1972. Should you require further information please contact the branch. Please Note additional fees could be incurred for items such as Leasehold packs.

1. MONEY LAUNDERING REGULATIONS Intending purchasers will be asked to produce identification documentation at a later stage and we would ask for your co-operation in order that there is no delay in agreeing the sale. 2. These particulars do not constitute part or all of an offer or contract. 3. The measurements indicated are supplied for guidance only and as such must be considered incorrect. Potential buyers are advised to recheck measurements before committing to any expense. 4. We have not tested any apparatus, equipment, fixtures or services and it is in the buyers interest to check the working condition of any appliances. 5. Where an EPC, or a Home Report (Scotland only) is held for this property, it is available for inspection at the branch by appointment. If you require a printed version of a Home Report, you will need to pay a reasonable production charge reflecting printing and other costs. 6. We are not able to offer an opinion either written or verbal on the content of these reports and this must be obtained from your legal representative. 7. Whilst we take care in preparing these reports, a buyer should ensure that his/her legal representative confirms as soon as possible all matters relating to title including the extent and boundaries of the property and other important matters before exchange of contracts.



Property Ref:  
BUH105093 - 0006

  
fox & sons



**01444 232849**



BurgessHill@fox-and-sons.co.uk



16 Station Road, BURGESS HILL, West Sussex,  
RH15 9DQ



**fox-and-sons.co.uk**