

1 Hagart Road, Houston. PA6 7JH

Offers Over £335,000

Penny Lane Homes
Johnstone Ltd,
36 High Street,
Johnstone,
PA5 8AH

To make an
appointment to view:

Call:
01505 331114

Click:
PennyLaneHomes.com

Come In:
To your nearest
branch



JOHNSTONE * PAISLEY * RENFREW

1 Hagart Road, Houston. PA6 7JH

Description

Stunning detached bungalow enjoying a corner position, enjoying views to the park and just a stroll from the village centre. Positioned in a after cul de sac that rarely comes to the market. This well maintained home sits in level easy to look after gardens with excellent privacy to the rear.

The accommodation comprises entrance porch, reception hallway with cloakroom, generous lounge with dining area and dual aspect doors leading out to the rear garden. The kitchen incorporates a range of modern floor and wall mounted units with solid oak worktop and breakfast bar, including a double oven with air fryer, hob, integrated fridge, freezer and door into the garage. Bedroom one is front facing with sliding wardrobes and bedroom two is rear facing with fitted mirrored wardrobes and bedroom three is rear facing. Finally, is the fully tiled shower room which comprises of a wash hand basin, WC and walkin shower.

There are mature gardens to the front, side and rear which have lawn areas and plant beds. There is a private driveway leading to the attached single garage.

Renfrewshire Council, Tax Band E.

EPC Rating D.

The property is located within the school catchments for the respected Gryffe High School and two Primary Schools. Houston is a residential area which is an ideal base for the commuting client, being a short drive away from the bypass which links up with the M8 motorway for connection to Glasgow International Airport, Paisley, Braehead Shopping Centre, and Glasgow city centre. Houston village offers a range of local shops and amenities with social and recreational facilities such as tennis/squash club, bowling club, village pubs and restaurants.

MONEY LAUNDERING REGULATIONS: Intending purchasers will be asked to produce identification documentation at a later stage and we would ask for your cooperation in order that there will be no delay in agreeing the sale.

Vestibule
5'0" (1.52m) x 7'3" (2.21m)

Hallway
17'10" (5.44m) x 11'2" (3.4m)

Lounge
18'8" (5.69m) x 21'1" (6.43m)

Kitchen
10'7" (3.23m) x 11'10" (3.61m)

Bedroom One
11'6" (3.51m) x 11'10" (3.61m)

Bedroom Two
11'6" (3.51m) x 12'2" (3.71m)

Bedroom Three
11'6" (3.51m) x 7'3" (2.21m)

Shower Room
5'11" (1.8m) x 8'2" (2.49m)

WC

Garage
18'7" (5.66m) x 8'11" (2.72m)

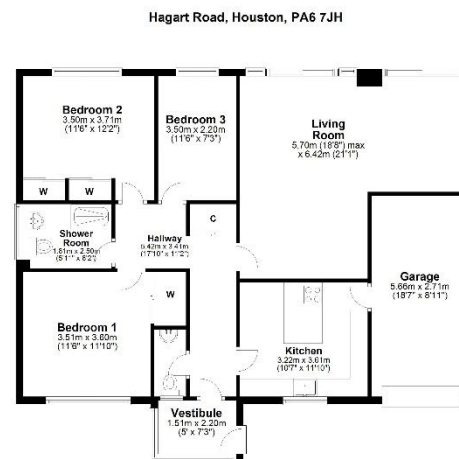

Total area: approx. 116.6 sq. metres (1255.3 sq. feet)