

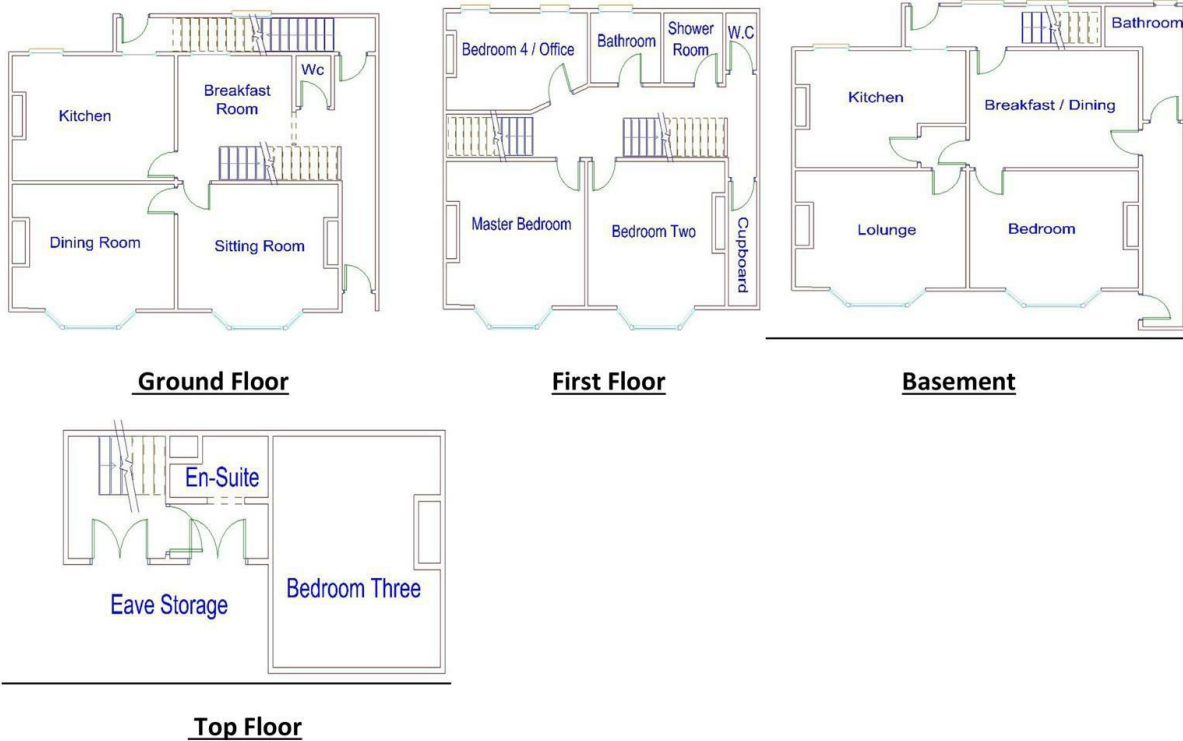

49 Granada Road, Southsea, Portsmouth, Hampshire, PO4

Asking Price £635,000

- POTENTIAL GRANNY ANNEX
- DOUBLE GLAZING WHERE STATED
- SIX BEDROOMS
- OFF ROAD PARKING FOR SEVERAL VEHICLES
- FRONT AND REAR GARDENS
- FOUR RECEPTION ROOMS
- EN SUITE TO BEDROOM THREE
- GAS CENTRAL HEATING
- TWO KITCHENS



Whilst every attempt has been made to ensure the accuracy of the floor plan contained here, measurements of doors, windows, rooms and any other item are approximate and no responsibility is taken for any error, omission, or misstatement. This plan is for illustrative purposes only and should only be used as such by any prospective purchaser. All check must be made prior to any contractual obligation.

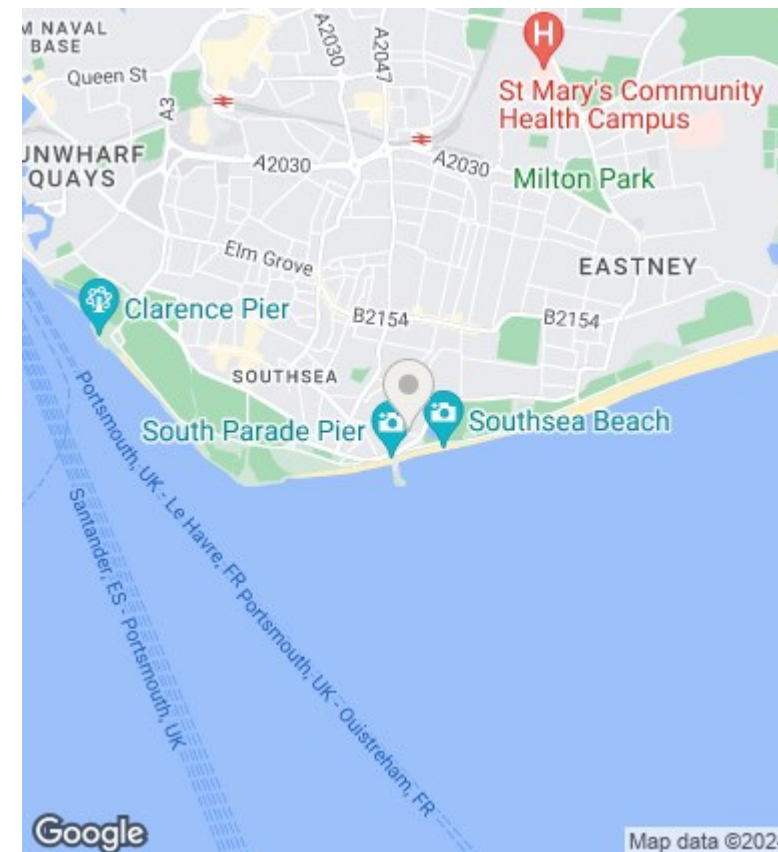

Directions

Viewings

Viewings by arrangement only. Call 02392 877458 to make an appointment.

Council Tax Band

F

EPC Rating:

Energy Efficiency Rating		
	Current	Potential
<i>Very energy efficient - lower running costs</i>		
(92 plus) A		
(81-91) B		
(69-80) C		
(55-68) D		
(39-54) E		
(21-38) F		
(1-20) G		
<i>Not energy efficient - higher running costs</i>		
England & Wales	EU Directive 2002/91/EC	