



Notice of Offer

Property Address: 22 Hewley Street TS6 0RD

We advise that an offer has been made for the above property in the sum of £48,000 Any persons wishing to increase on this offer should notify the agents of their best offer prior to exchange of contracts.

Agents Address: 26 Stokesley Road TS7 8DX
Agents Telephone Number 01642 313666

Hewley Street, Middlesbrough, TS6 0RD

1 Bed - Flat

£50,000

EPC Rating: C

Council Tax Band: A

Tenure: Leasehold



**SMITH &
FRIENDS**
ESTATE AGENTS

Hewley Street, Middlesbrough, TS6 0RD

Hewley Street

Approximate Gross Internal Area
420 sq ft - 39 sq m

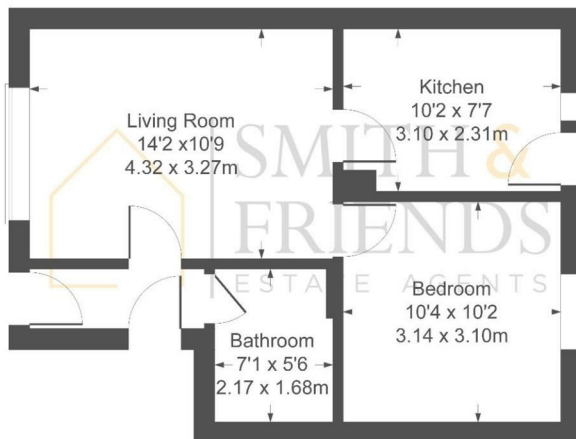

Not to Scale. Produced by The Plan Portal 2024
For Illustrative Purposes Only.

For clarification we wish to inform prospective purchasers that we have prepared these sales particulars as a general guide. We have not carried out a detailed survey, nor tested the services, appliances and specific fittings. Room sizes should not be relied upon for carpets and furnishings, if there are important matters which are likely to affect your decision to buy, please contact us before viewing the property. Smith & Friends Estate Agents can recommend financial services, surveying, conveyancing and removal services to sellers and buyers. Smith & Friends Estate Agents staff may benefit from referral incentives relating to these services.

Energy Efficiency Rating		Current	Potential
Very energy efficient - lower running costs			
(92 plus) A			
(81-91) B			
(69-80) C		76	78
(55-68) D			
(39-54) E			
(21-38) F			
(1-20) G			
Not energy efficient - higher running costs			
England & Wales		EU Directive 2002/91/EC	

26 Stokesley Road, Marton, Middlesbrough,
TS7 8DX

01642 313666

middlesbrough@smith-and-friends.co.uk

www.smith-and-friends.co.uk



SMITH &
FRIENDS
ESTATE AGENTS