



## Maryland Road, N22 5AP

**£399,950 SHARE OF FREEHOLD**

This two bedroom, ground floor garden maisonette set within this charming, period residence. The property offers adaptable living space throughout. This character filled property is in need of full refurbishment and currently comprises; two bedrooms, kitchen, dining room, a bathroom, and direct access to a South facing rear garden. Further benefitting from gas central heating, double glazing, Ideally located on a quiet residential road off Green Lanes, within walking distance of both Wood Green Underground Station, Bowes Park British Rail Station and served by several local bus routes offering easy access to Central London and the City. Woodside Park is also within walking distance as well as several recreational grounds.

T: 0208 365 8900 E: [boundsgreen@wilkinsonbyrne.com](mailto:boundsgreen@wilkinsonbyrne.com) W: [www.wilkinsonbyrne.com](http://www.wilkinsonbyrne.com)

The Property Misdescriptions Act 1991: None of the statements contained in these particulars as to this property are to be relied on as statements of representations of fact. Wilkinson Byrne has no tested any equipment, fixtures or fittings or services and so cannot confirm that they are in working order. Wilkinson Byrne have not sight of the title documents and any reference to the tenure of the property is based on information supplied by the seller. Wilkinson Byrne are unable to confirm that the relevant Planning Permission and/or Building Regulation Approval has been obtained where any structural alterations have occurred. A buyer is advised to obtain verification from their solicitor or surveyor of any of the above or any other fact prior to making an offer. Photographs are provided for illustration purposes only and do not depict what is included in the sale. All measurements are taken using a sonic tape, are approximate and for guidance only.



These particulars, whilst believed to be accurate set out as a general outline only for guidance and do not constitute any part of an offer or contract. Intending purchasers should not rely on them as fittings. Room sizes should not be relied upon for carpets and furnishings. The measurements given are approximate. No person in this firm's employment has the authority to make or give any representation or warranty in respect of the property.

# Maryland Road, Wood Green, London, N22

Approximate Area = 679 sq ft / 63 sq m

Limited Use Area(s) = 15 sq ft / 1.3 sq m

Total = 694 sq ft / 64.3 sq m

For identification only - Not to scale



Denotes restricted head height

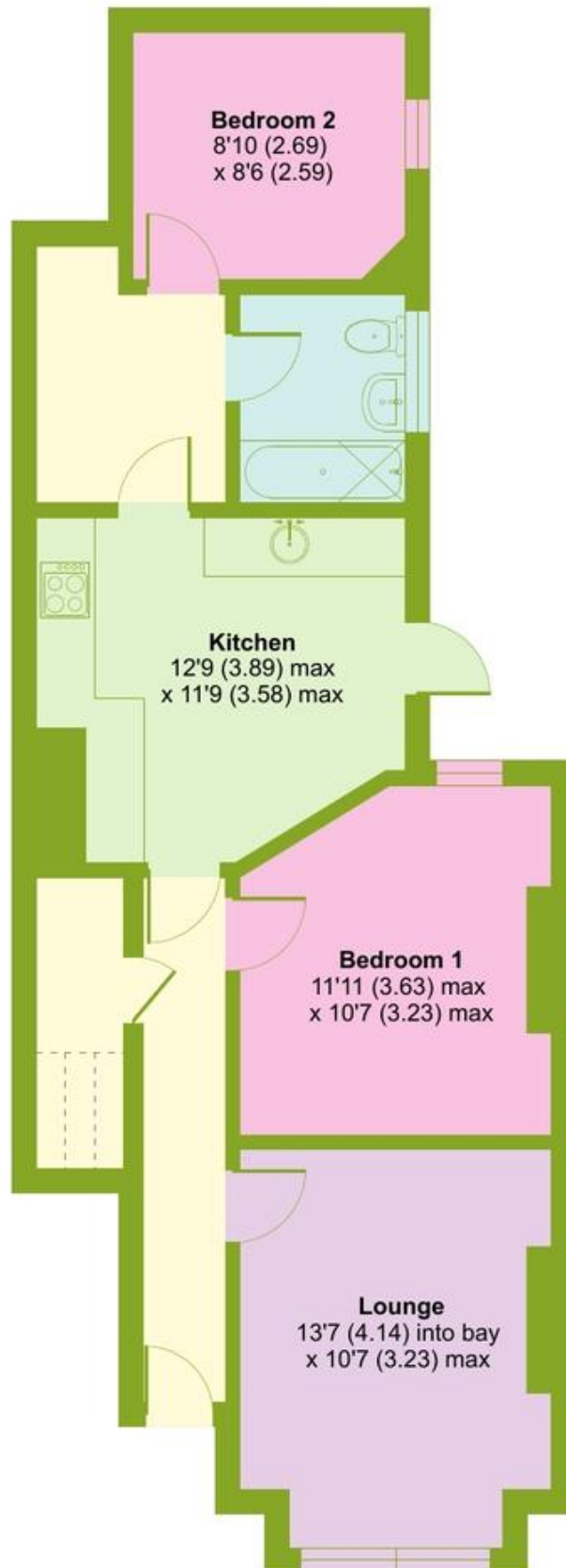

**NINTH FLOOR**



Floor plan produced in accordance with RICS Property Measurement Standards incorporating International Property Measurement Standards (IPMS2 Residential). © nichecom 2024. Produced for Wilkinson Byrne. REF: 1161183



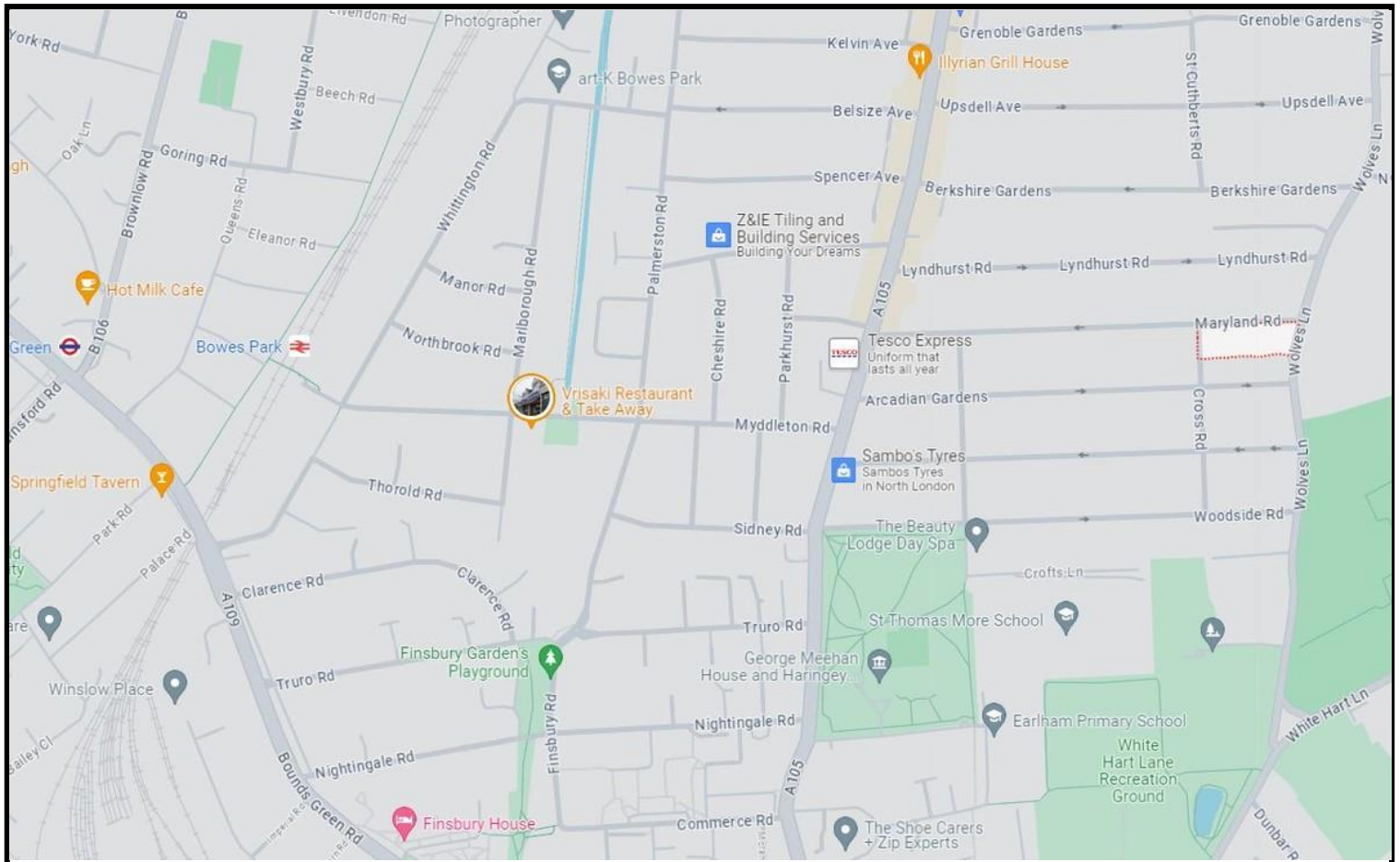

Score	Energy rating	Current	Potential
92+	A		
81-91	B		86 B
69-80	C		
55-68	D	55 D	
39-54	E		
21-38	F		
1-20	G		

Bouds Green Office  
 3 Latham Court  
 Brownlow Road  
 London N11 2ES  
 0208 - 365 - 8900

[boudsgreen@wilkinsonbyrne.com](mailto:boudsgreen@wilkinsonbyrne.com)

Turnpike Lane Office  
 8 Turnpike Parade  
 Green Lanes  
 London N15 3EA  
 0208 - 888 - 0022

[turnpikelane@wilkinsonbyrne.com](mailto:turnpikelane@wilkinsonbyrne.com)