



Rectory Gardens | | Worlingham | NR34 7RF

Asking Price £540,000

DURRANTS
SINCE 1853

Key features

- Estimated completion - Autumn 2025
- Detached family home
- Four double bedrooms
- Open plan kitchen dining room with bi fold doors leading to the garden
- EV Charging point
- Fully fitted security alarm
- Small development of only 19 homes
- Air source heating
- 10 year NHBC Warranty, with 2 year Badger Home warranty

Description

PLOT 9 THE WRENTHAM - A delightful 4 double bedroom detached house, located on a corner plot, presented on an exclusive Badger Homes development of only 19 homes in the popular village of Worlingham.



Directions





Floor plans

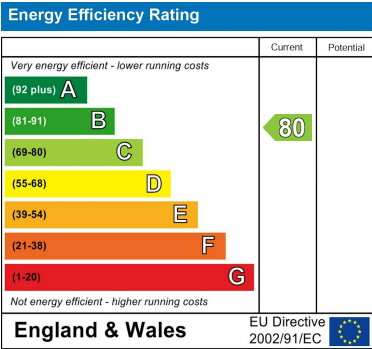
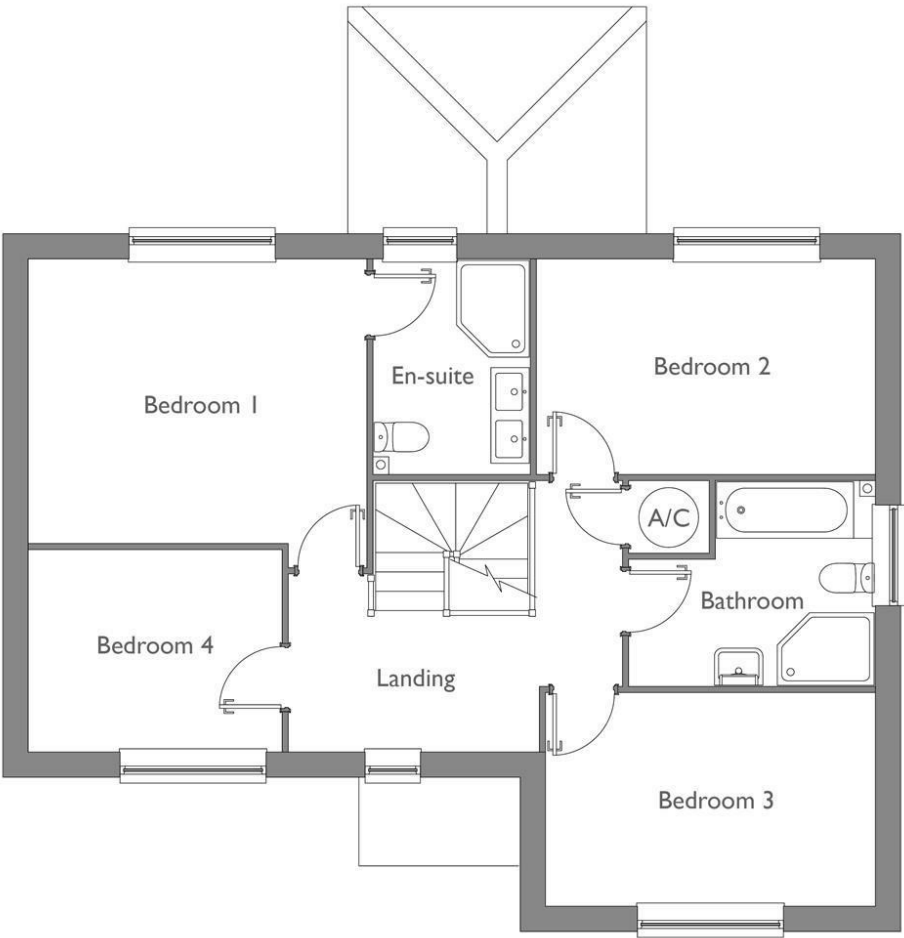

10 New Market
Beccles
Suffolk
NR34 9HA
01502 712122

infobeccles@durrants.com
<https://durrants.com/>