

19 Lime Kiln Lane Estate , Holbury , Southampton , Hampshire , SO45 2HF

£120,000



2



1



1



☎ 02380 243 866

✉ sales@eastonresidential.co.uk

Further Details

- Council Tax Band - A - New Forest District Council
- MODERN CENTRAL HEATING BOILER
- DOUBLE GLAZED
- OVER 50'S, NO DOGS OR CHILDREN ALLOWED BUT CATS ARE PERMITTED
- OVERLOOKS FIELDS AND THE FOREST BEYOND
- MONTHLY PITCH FEE - APPROX £140.00
- ELECTRIC AND WATER PURCHASED FROM SITE - APPROX £50.00 PER MONTH

Enjoying what we would argue to be the best positioned unit on the site comes this immaculately presented two bedroom mobile home. Enjoying an open outlook to the front over fields and the New Forest Park beyond the unit is offered for sale with the incentive of NO ONWARD CHAIN and has been vastly improved by the current seller boasting internal accommodation comprising of entrance hall, lounge, white suite kitchen/breakfast room, two bedrooms and a white suite bathroom. With further benefits including gas central heating from a newly installed boiler and double glazing, call us now to book a viewing.

SCAN HERE TO VIEW ONLINE



Property Images



Front Shot



Kitchen



Kitchen



Living Room



Rear Garden

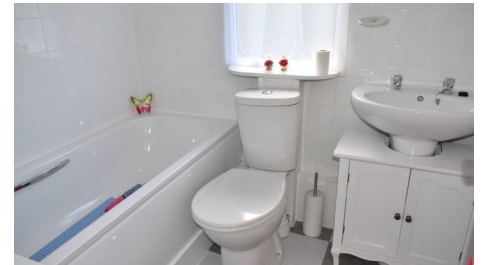

Bathroom

Floorplan

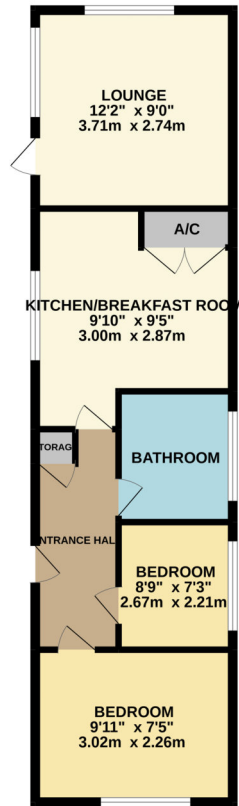

Energy Performance Certificate

N/A

**Only
With Us !!**

**See all our
properties on our
website , Facebook
and Instagram 24
Hours Before The
Portals !!**



Scan the QR code above and register with us to get a notification once we make a property live !!

easton
removals

Removals & Clearance

For a free no-obligation quote for removals or
clearance, please contact us today.



Holbury Office

93-95 Long Lane
Holbury
Southampton
SO45 2ND

☎ 02380 243 866

✉ sales@eastonresidential.co.uk