



3 Zetland Court, Richmond

Offers in the Region of £145,000

Forming part of a very quiet courtyard development, conveniently positioned a short walk into the Market Place, this very nicely presented duplex apartment provides well planned living spaces that will appeal to a range of buyers. Laid out over two floors, the apartment features a dual aspect living room, a dining kitchen, two bedrooms and a bathroom. Externally there is communal parking. An early inspection is strongly recommended!

21 Market Place, Richmond, North Yorkshire, DL10 4QG

3 Zetland Court, Richmond

Forming part of a very quiet courtyard development, conveniently positioned a short walk into the Market Place, this very nicely presented duplex apartment provides well planned living spaces that will appeal to a range of buyers. Laid out over two floors, the apartment features a dual aspect living room, a dining kitchen, two bedrooms and a bathroom. Externally there is communal parking. An early inspection is strongly recommended!

Dining Kitchen:

Accessed through a part glazed upvc door, the kitchen provides space for a small table and is fitted with a range of cream coloured wall and base units with complimenting countertops.



Integrated into the units are a gas hob and an electric oven. There is plumbing for a washing machine, space for an under counter fridge, a radiator and a sliding sash window to the front of the property. The staircase leads to the upper floor.



Living Room:

A dual aspect living room having sliding sash windows to the front and rear of the property.



There is a TV point and a radiator.



Bedroom 1:

A dual aspect double bedroom having a radiator, a sliding sash window to the front with a view of the Castle Keep, and a sliding sash window to the rear overlooking the Cricket Pitch.



Bedroom 2:

With a radiator and a sliding sash window to the rear with a view of The Friary Tower.



Bathroom:

Fitted with a white suite that comprises a bath with a shower over, a WC, a wash hand basin and a heated towel rail.



External

The apartment forms part of a quiet courtyard development and is accessed via a set of stone steps that lead to the first floor entrance door. There is communal parking and a useful shared store.



Additional Information

The postcode is DL10 4AS and the Council Tax Band is B.

The property has the benefit of gas central heating.

The property is leasehold and is subject to a 999 year lease dated June 2013.

There is a £30 a month service charge.

Please note this property can not be a commercial let or air BNB. It can be a residential let or second home.



3 Zetland Court

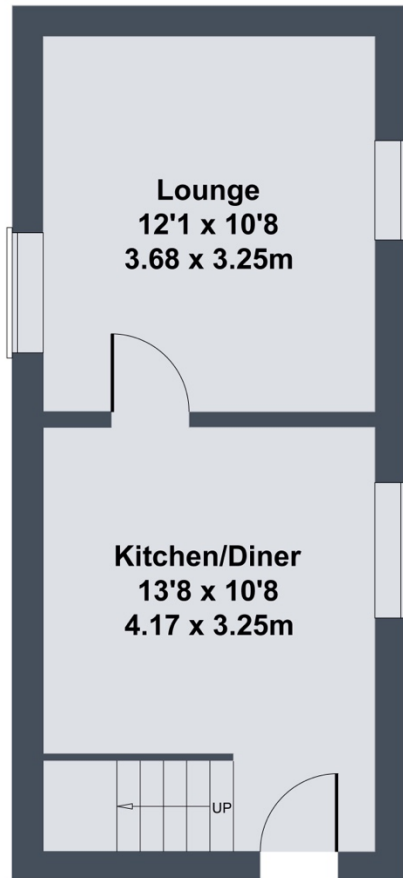

FIRST FLOOR

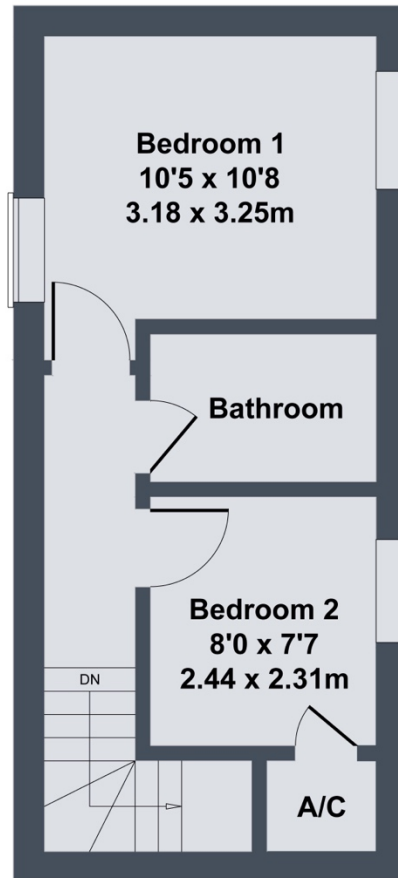

SECOND FLOOR

SKETCH PLAN FOR ILLUSTRATIVE PURPOSES ONLY

All measurements walls, doors, windows, fittings and appliances, their sizes and locations, are approximate only. They cannot be regarded as being a representation by the seller, nor their agent.

Produced by Potterplans Ltd. 2024