



19 Tower Street, Richmond

Offers in the Region of £150,000

Sitting on a cobbled street, with views of Richmond Castle and a stones throw the Market Square, this quaint one bedroomed cottage would make an ideal holiday cottage or second home. With some scope to put your own stamp onto, it is being offered CHAIN FREE and offers excellent potential.

An early inspection is strongly recommended.

Market Place Location – One Bedroom – Kitchen – Living Room – Bathroom – Offered to The Market Chain Free

21 Market Place, Richmond, North Yorkshire, DL10 4QG

19 Tower Street, Richmond

Sitting on a cobbled street, with views of Richmond Castle and a stones throw the Market Square, this quaint one bedroomed cottage would make an ideal holiday cottage or second home. With some scope to put your own stamp onto, it is being offered CHAIN FREE and offers excellent potential. An early inspection is strongly recommended.

Entrance Hallway:

Accessed through a timber door with black hardware, the hallway has a tiled floor and doors to the living room, kitchen and bathroom.

Living Room:

The living room provides perfect space for relaxing, with a characterful window seat, an Elkatherm electric radiator and a single glazed window to the side of the property.



Bedroom:

A double bedroom with built in storage, an Elkatherm electric radiator and a window to the rear of the property.



Bathroom:

A white three piece suite comprising a wc, pedestal sink and panelled bath with shower attachment. The splashbacks are tiled, there is an Elkatherm radiator and a window to the front of the property.



Kitchen:

A cottage style kitchen, with a range of cream wall and base units and complimenting tiles and worksurfaces. Integrated is an electric hob and oven with an extractor over, a stainless steel sink and a fridge freezer. The kitchen has dual aspect, with a window to the side of the property, a window to the front giving views of Richmond Castle and a warm air heating system at floor level.





External

The property sits at the end of Tower Street, with steps down to Castle Terrace and further onto The Batts.

The property has the benefit of a bin store which is access through the neighbouring property's yard (Rose Cottage).

Additional Information

The postcode is DL10 4QW and the Council Tax Band is A.

19 Tower Street, Richmond

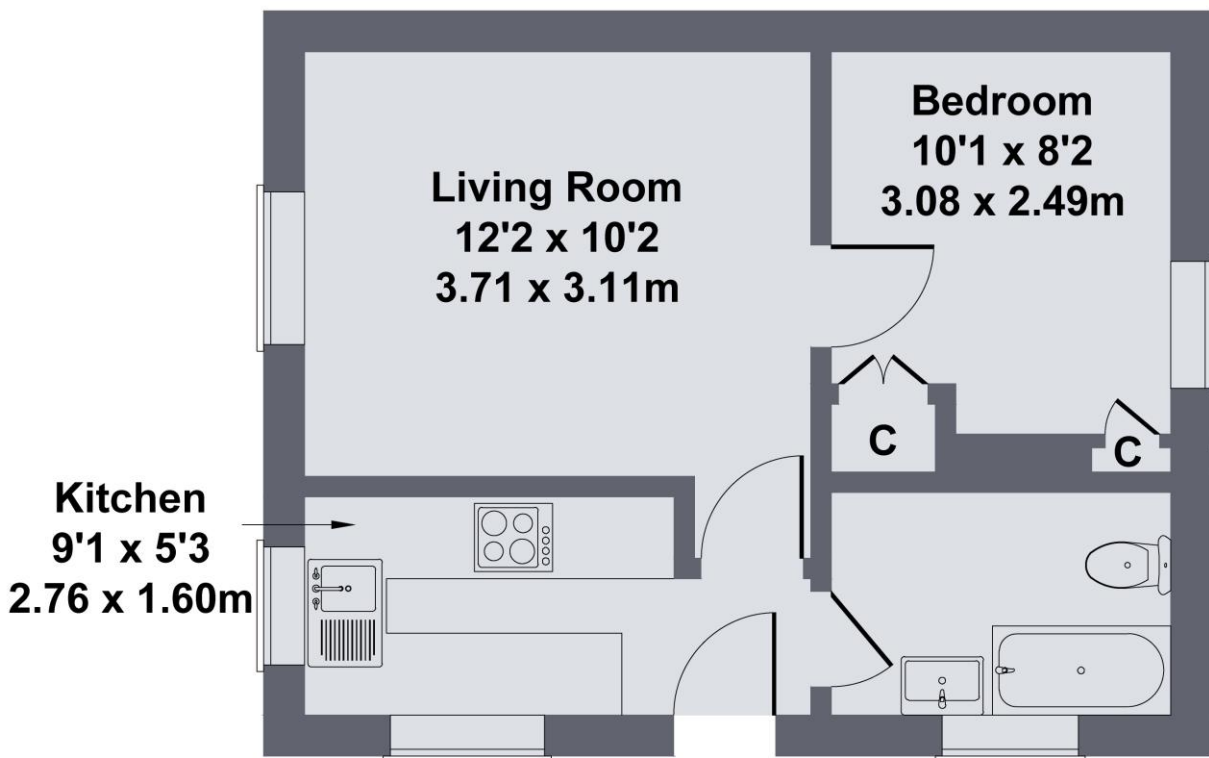

SKETCH PLAN FOR ILLUSTRATIVE PURPOSES ONLY

All measurements walls, doors, windows, fittings and appliances, their sizes and locations, are approximate only. They cannot be regarded as being a representation by the seller, nor their agent.

Produced by Potterplans Ltd. 2024

Viewing Arrangements - by appointment with Irvings Property Ltd

Property Misdescriptions Act 1991 - PLEASE NOTE CAREFULLY

These particulars have been prepared for guidance only. We have not carried out a detailed survey, nor tested the services, appliances or specific fittings. Floor plans are not drawn to scale unless stated, measurements and distances are approximate only. Do not rely on them for carpets and furnishings. Photographs are not necessarily current and you should not assume that contents shown are included in the sale.