



## High Street, Whixley £1,800 Per Month

Stephensons are pleased to offer for rent this beautifully presented 4 bedroom detached property enjoying an enviable position set back off the picturesque village High Street and providing over 1,400 sq ft of flexible living accommodation and delightful gardens and grounds extending to approximately .20 of an acre.



## Inside

An entrance porch leads through to a spacious reception hall with staircase and doors leading off into a formal dining room and a sitting room with wood burning stove and double doors opening out into the front garden. The stylish kitchen provides a generous range of base and wall storage cupboards complemented by white quartz worktops and integrated appliances to include touch induction hob with stylish Faber filter hood above, dishwasher and eye level double oven and grill.



The ground floor also features a conservatory leading off the kitchen, a versatile study/4th bedroom and a shower room with underfloor heating.

The 1st floor landing leads off into a stunning principal bedroom with built-in wardrobes, 2 further bedrooms and a luxuriously appointed bathroom with both bath and separate walk-in shower.

Other internal features of note include oil fired radiator central heating, double glazing and cottage style latch doors throughout.



## Outside

Externally, a gated driveway provides generous parking and access into a single garage. The rear garden enjoys a high degree of privacy and the larger than average front garden sets the property back from the village High Street.



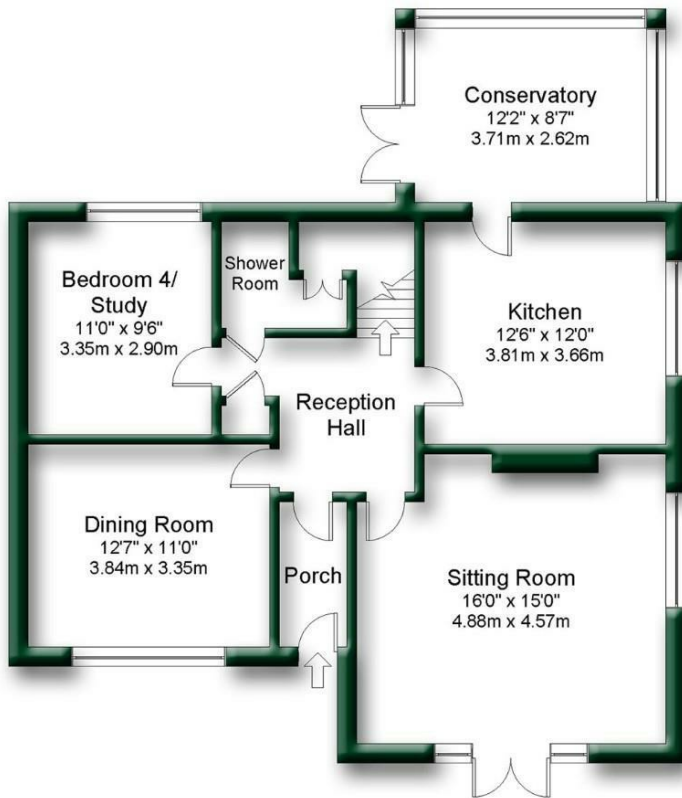

Ground Floor

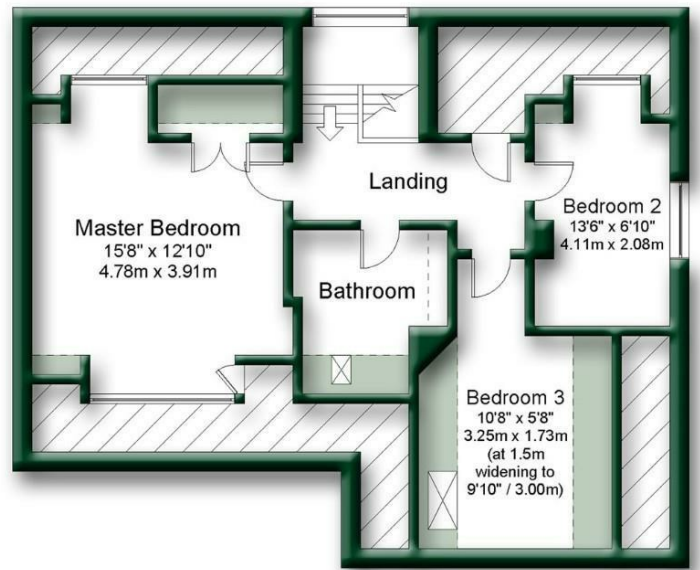

First Floor

Gross internal floor area excluding Eaves (approx.): 132.9 sq m (1,431 sq ft)

Please Note, The Highlighted Areas Are Below 1.5m in Height & Are Not Included In The Gross Internal Floor Area.

Not to Scale. Copyright © Apex Plans.

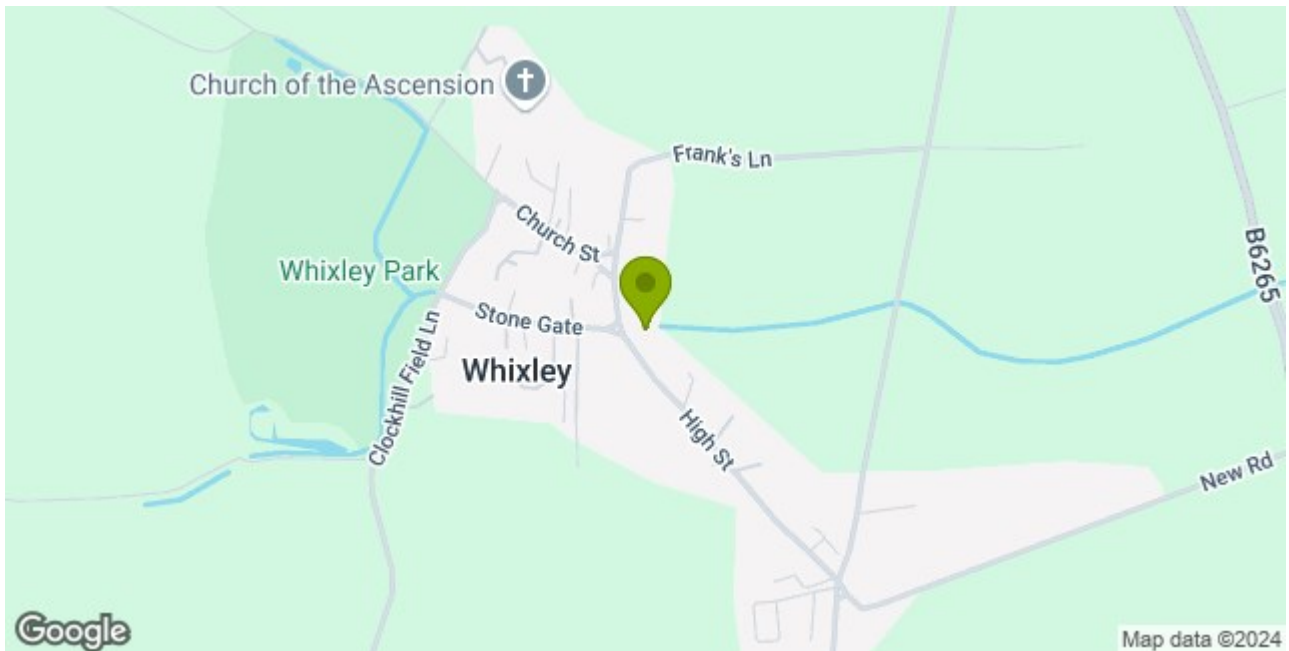

**Stephensons**

York	01904 625533
Knarborough	01423 867700
Selby	01757 706707
Boroughbridge	01423 324324
Easingwold	01347 821145
York Auction Centre	01904 489731
Haxby	01904 809900

**Partners**

- J F Stephenson MA (cantab) FRICS FAAV
- I E Reynolds BSc (Est Man) FRICS
- R E F Stephenson BSc (Est Man) MRICS FAAV
- N J C Kay BA (Hons) pg dip MRICS
- O J Newby MNAEA
- J E Reynolds BA (Hons) MRICS
- R L Cordingley BSc FRICS FAAV
- J C Drewniak BA (Hons)

**Associates**

N Lawrence

