



## Boroughbridge Road, Green Hammerton, York £750 Per Month

\*\*\*\* PARTIALLY FURNISHED \*\*\*\*

A comprehensively upgraded 1 bedroom period cottage located centrally within this ever-popular Village with off street parking and front garden.

The property benefits from modern kitchen and bathroom fittings in addition to double glazing throughout.

It is a partially furnished property with the Landlords looking for a 12-month minimum term.

Sorry, No Pets, Smokers or Children





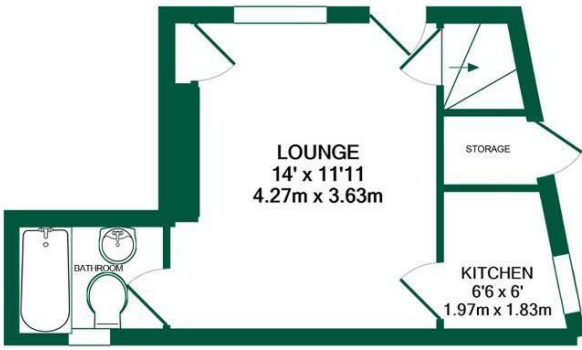

GROUND FLOOR  
APPROX. FLOOR  
AREA 311 SQ.FT.  
(28.9 SQ.M.)



FIRST FLOOR  
APPROX. FLOOR  
AREA 225 SQ.FT.  
(20.9 SQ.M.)



TOTAL APPROX. FLOOR AREA 476 SQ.FT. (44.2 SQ.M.)

Whilst every attempt has been made to ensure the accuracy of the floor plan contained here, measurements of doors, windows, rooms and any other items are approximate and no responsibility is taken for any error, omission, or mis-statement. This plan is for illustrative purposes only and should be used as such by any prospective purchaser. The services, systems and appliances shown have not been tested and no guarantee as to their operability or efficiency can be given

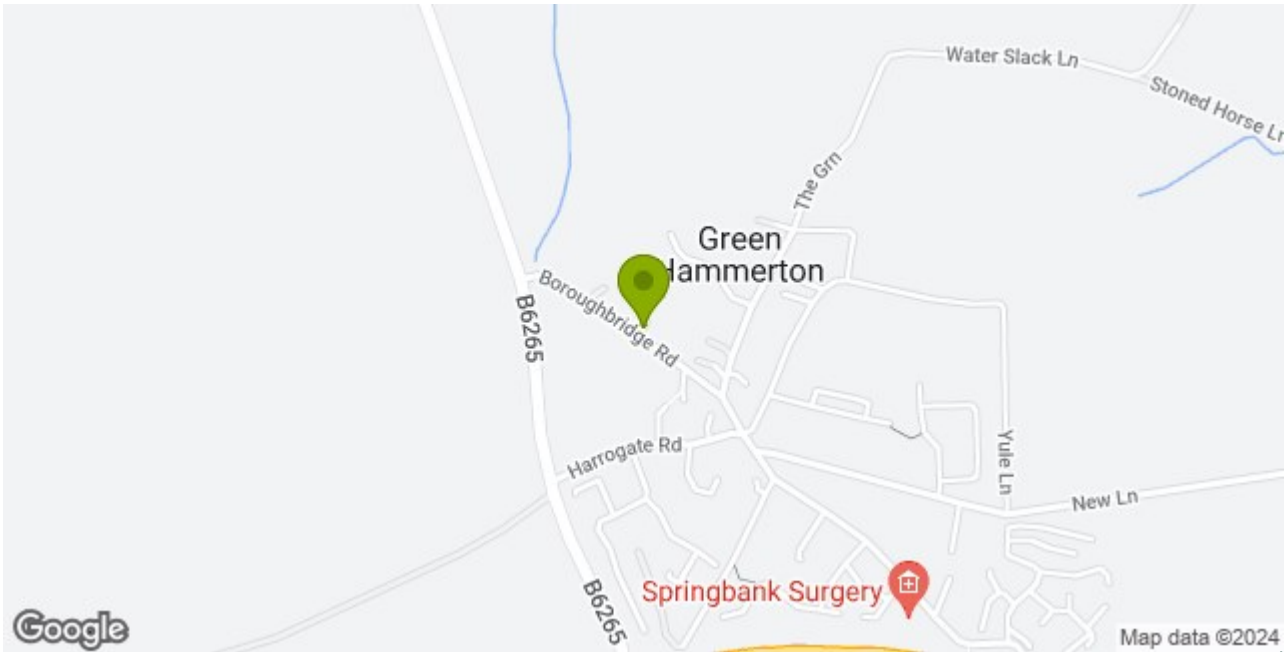

**Stephensons**

York	01904 625533
Knarborough	01423 867700
Selby	01757 706707
Boroughbridge	01423 324324
Easingwold	01347 821145
York Auction Centre	01904 489731
Haxby	01904 809900

**Partners**

- J F Stephenson MA (cantab) FRICS FAAV
- I E Reynolds BSc (Est Man) FRICS
- R E F Stephenson BSc (Est Man) MRICS FAAV
- N J C Kay BA (Hons) pg dip MRICS
- O J Newby MNAEA
- J E Reynolds BA (Hons) MRICS
- R L Cordingley BSc FRICS FAAV
- J C Drewniak BA (Hons)

**Associates**

- N Lawrence

