



TWEED WALK, E14

£450,000 LH

- 784 sq ft
- Canal & Cityscape Views
- Air Quality Filtration System
- West Facing
- 999 Year Lease
- Chain Free

wj.
meade

Yeoman Court

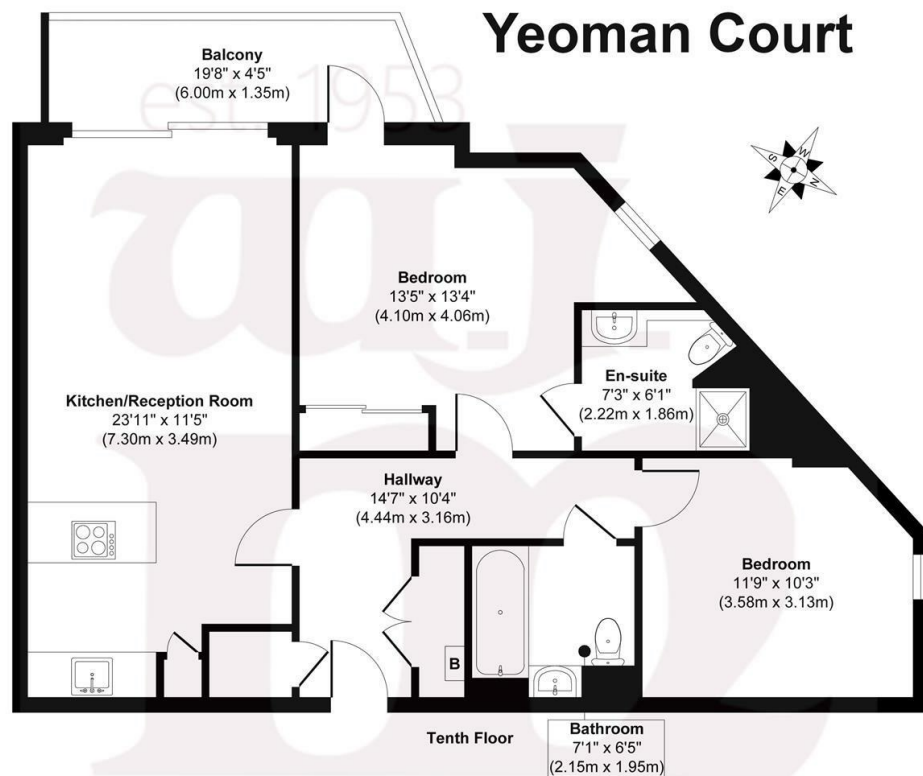

Approx. Gross Internal Floor Area 784 sq. ft / 72.88 sq. m

Illustration for identification purposes only, measurements are approximate, not to scale.

Produced by Elements Property

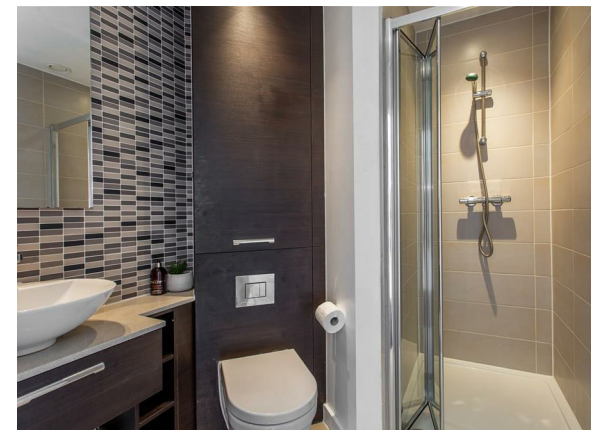

WJ Meade are pleased to offer this contemporary two bedroom apartment on the tenth floor of a modern development alongside the limehouse cut canal. Affording dramatic, far reaching views across the East London Skyline, well framed by the floor to ceiling glazing and best enjoyed from the covered balcony space accessed from both the reception and master bedroom. With the convenience of Bromley By Bow tube providing swift access into the City.

All sizes are approximate. The Agent has not tested any apparatus, equipment, fixtures and fittings, or services and so cannot verify that they are in working order or fit for the purpose. A buyer is advised to obtain verification from their Solicitors or Surveyor. Photographs are for illustration purposes only and may depict items, which are not for sale or included in the sale price. References to tenure of a property are based upon information supplied by the vendor. The agent has not had sight of the title documents, a buyer is advised to obtain verification from their solicitor. Money Laundering Regulations 2003: Intending purchasers will be asked to produce identification, documentation at a later stage and we would ask for your co-operation in order that there will be no delay in agreeing the sale.

These particulars are intended to give a fair description of the property only and are in no way guaranteed, nor do of any contract. They are issued on the express condition that all negotiations are conducted through W.J. Meade Estate Agents. All subject to contract and to being unsold.

Service charge £3,553.58 pa

Ground rent £250 pa

999 years lease

Council Tax Band D

Current EPC Rating 85

Tenure: Leasehold

