



TURNERS ROAD, E3

£375,000 SOF/H

- Internal Courtyard
- Residential Permit Parking
- Many Original Period Features
- Share of Freehold
- 509 Sq Ft
- Own Entrance

wj.  
meade



# Turners Road

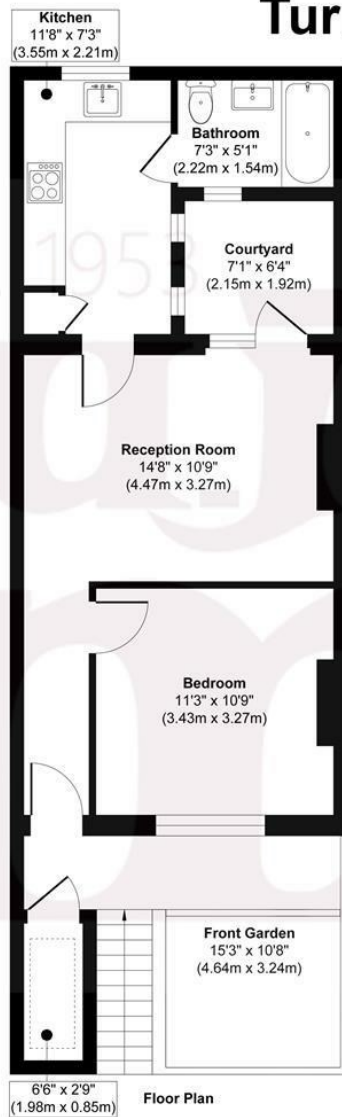

**Approx. Gross Internal Floor Area 509 sq. ft / 47.38 sq. m**

Illustration for identification purposes only, measurements are approximate, not to scale.

Produced by Elements Property



WJ Meade are pleased to present this charming one bedroom apartment on the lower ground floor of a Victorian house conversion. The social space flows from a fitted kitchen to a separate reception room with doors out to a delightful Mediterranean style courtyard, Ideal for alfresco dining and entertaining. Well connected for Canary Wharf and Mile End, this is a perfect first time purchase for anyone seeking an original character property with outside space.

Service charge £250

Ground rent £0

988 years lease

Council Tax Band B

Current EPC Rating 67

Tenure: Leasehold - Share of Freehold



All sizes are approximate. The Agent has not tested any apparatus, equipment, fixtures and fittings, or services and so cannot verify that they are in working order or fit for the purpose. A buyer is advised to obtain verification from their Solicitors or Surveyor. Photographs are for illustration purposes only and may depict items, which are not for sale or included in the sale price. References to tenure of a property are based upon information supplied by the vendor. The agent has not had sight of the title documents, a buyer is advised to obtain verification from their solicitor. Money Laundering Regulations 2003: Intending purchasers will be asked to produce identification, documentation at a later stage and we would ask for your co-operation in order that there will be no delay in agreeing the sale.

These particulars are intended to give a fair description of the property only and are in no way guaranteed, nor do of any contract. They are issued on the express condition that all negotiations are conducted through W.J. Meade Estate Agents. All subject to contract and to being unsold.