



ANNIE BESANT CLOSE, BOW, E3

£3,800 PER MONTH

- HMO Licence - suitable for sharers
- Private Garden
- Town House
- 4 Double Bedrooms
- Available early August
- Near Victoria Park

wj.  
meade



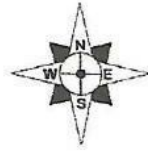
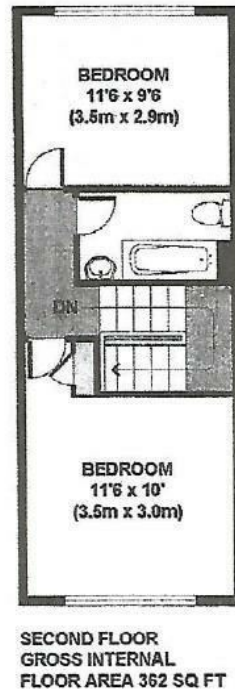
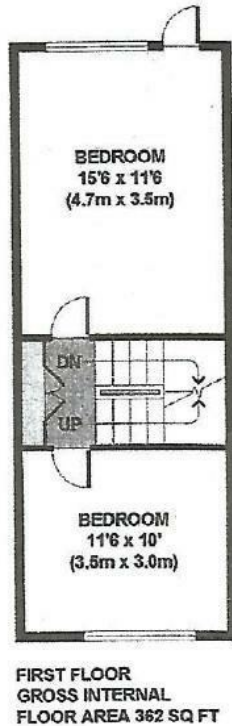
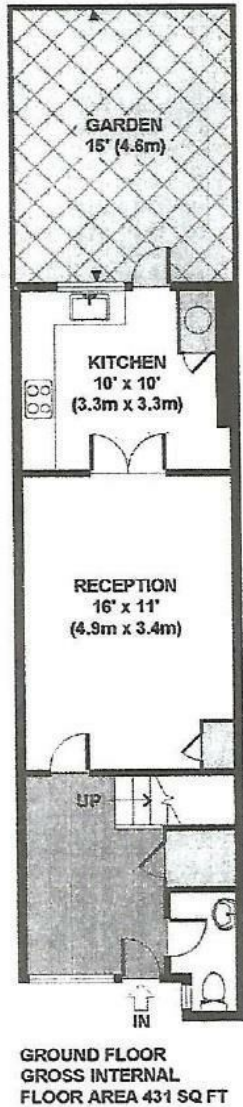

## ANNIE BESANT CLOSE E3



W J Meade are pleased to offer this four bedroom terraced house to rent in Annie Besant Close. The property comprises a large reception room, modern kitchen, small patio/garden area, downstairs toilet, four double bedrooms and family bathroom. The property is ideally located for local amenities, public transport and is a short walk to multiple train stations. The property has a HMO licence so is suitable for sharers.

Deposit is 5 week's rent.

Council Tax band D.

Service charge £n/a

Ground rent £n/a

Reserve fund £n/a

n/a years lease

Council tax band D

Current EPC Rating 63



All sizes are approximate. The Agent has not tested any apparatus, equipment, fixtures and fittings, or services and so cannot verify that they are in working order or fit for the purpose. A buyer is advised to obtain verification from their Solicitors or Surveyor. Photographs are for illustration purposes only and may depict items, which are not for sale or included in the sale price. References to tenure of a property are based upon information supplied by the vendor. The agent has not had sight of the title documents, a buyer is advised to obtain verification from their solicitor. Money Laundering Regulations 2003: Intending purchasers will be asked to produce identification, documentation at a later stage and we would ask for your co-operation in order that there will be no delay in agreeing the sale.

These particulars are intended to give a fair description of the property only and are in no way guaranteed, nor do of any contract. They are issued on the express condition that all negotiations are conducted through W.J. Meade Estate Agents. All subject to contract and to being unsold.