

## WINDSOR COURT,, MOSTYN GROVE E3

£399,995

- Central communal gardens
- Concierge & work space
- Underground parking
- Chain free
- Resident's bicycle storage
- Biomass community heating system

wj.  
meade

## Windsor Court

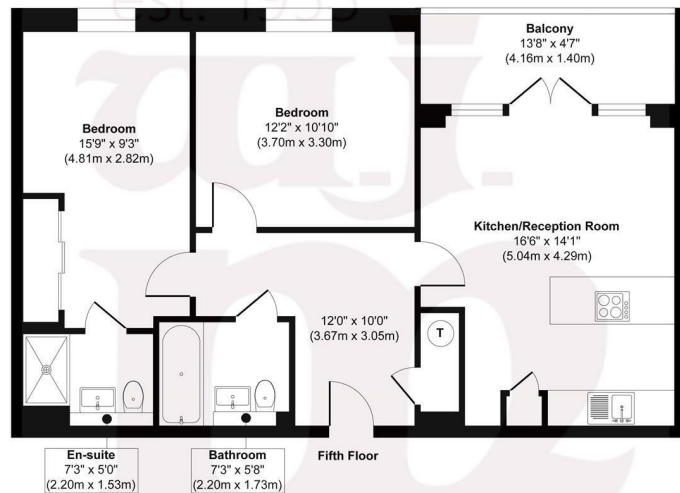

WJ Meade are delighted to offer this modern two double bedroom apartment on the fifth floor of a private development. Overlooking the beautiful landscaped gardens, the accommodation is configured with an open plan kitchen/reception, sizable entrance hall and two contemporary bathrooms. Situated in a residential part of Bow, close to transport links, public parks, the amenities of Roman Road and the buzz of Hackney Wick.

All sizes are approximate. The Agent has not tested any apparatus, equipment, fixtures and fittings, or services and so cannot verify that they are in working order or fit for the purpose. A buyer is advised to obtain verification from their Solicitors or Surveyor. Photographs are for illustration purposes only and may depict items, which are not for sale or included in the sale price. References to tenure of a property are based upon information supplied by the vendor. The agent has not had sight of the title documents, a buyer is advised to obtain verification from their solicitor. Money Laundering Regulations 2003: Intending purchasers will be asked to produce identification, documentation at a later stage and we would ask for your co-operation in order that there will be no delay in agreeing the sale.

These particulars are intended to give a fair description of the property only and are in no way guaranteed, nor do of any contract. They are issued on the express condition that all negotiations are conducted through W.J. Meade Estate Agents. All subject to contract and to being unsold.

Service charge £n/a  
Ground rent £n/a  
Reserve fund £n/a  
n/a years lease  
Council tax band D  
Current EPC Rating 80

