



WHITE HORSE LANE, E1

£415,000 L/H

- Chain Free
- 767 sq ft
- Direct access into enclosed communal gardens
- Two Double Bedrooms
- Newly Fitted Bathroom
- Access to private patio

wj.  
meade



# Galway House

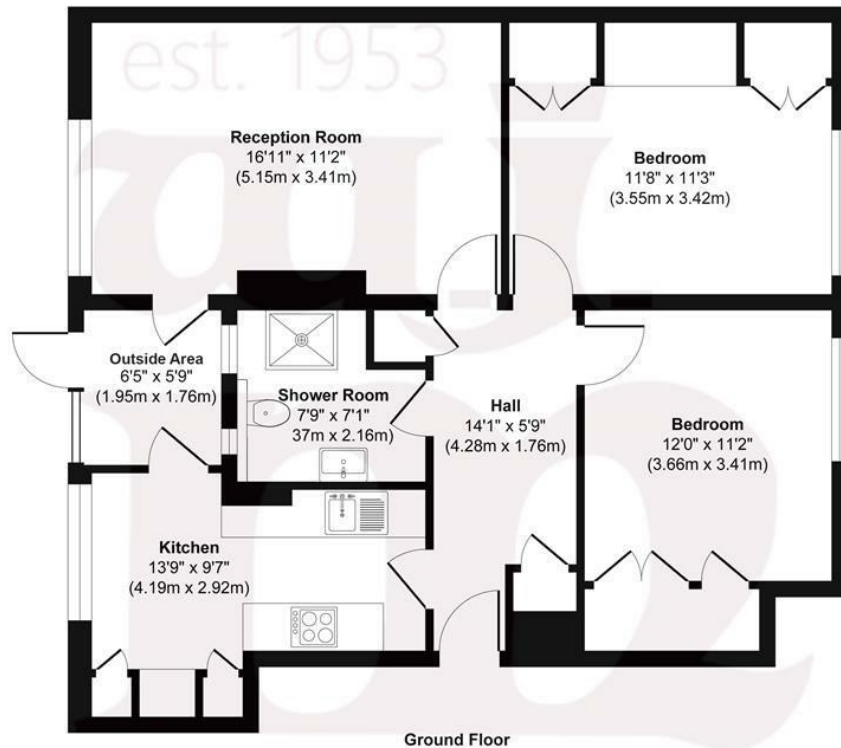

**Approx. Gross Internal Floor Area 767 sq. ft / 71.32 sq. m**

Illustration for identification purposes only, measurements are approximate, not to scale.

Produced by Elements Property



WJ Meade are please to present this ground floor flat in White Horse Lane. Arranged over 767 sq ft, the property features two spacious double bedrooms, a newly fitted bathroom, the reception room provides a welcoming area for relaxation and entertainment with the benefit of a separate kitchen/diner. Situated in Stepney Green, with local shops, parks, and cafes all within easy reach, well-known for its excellent transport links, with Stepney Green Underground station just a short walk away, you will find yourself well-connected to the rest of The City.

Service charge £2,592.78

Ground rent £10

Lease 125 years from 29/09/1986

Council tax band B

Current EPC Rating 68



All sizes are approximate. The Agent has not tested any apparatus, equipment, fixtures and fittings, or services and so cannot verify that they are in working order or fit for the purpose. A buyer is advised to obtain verification from their Solicitors or Surveyor. Photographs are for illustration purposes only and may depict items, which are not for sale or included in the sale price. References to tenure of a property are based upon information supplied by the vendor. The agent has not had sight of the title documents, a buyer is advised to obtain verification from their solicitor. Money Laundering Regulations 2003: Intending purchasers will be asked to produce identification, documentation at a later stage and we would ask for your co-operation in order that there will be no delay in agreeing the sale.

These particulars are intended to give a fair description of the property only and are in no way guaranteed, nor do of any contract. They are issued on the express condition that all negotiations are conducted through W.J. Meade Estate Agents. All subject to contract and to being unsold.