



THEATRE BUILDINGS, BOW, E3

£3,000 OFFERS IN EXCESS

- Private Terrace
- Three Double Bedrooms
- Two Bathrooms
- HMO - Suitable for Sharers
- Offers over £3000pcm
- Great Location

wj.
meade



Theatre Building

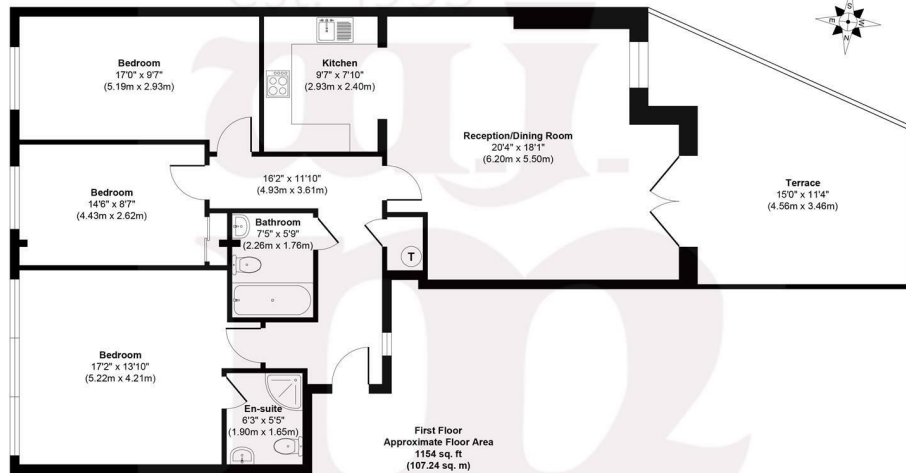

Approx. Gross Internal Floor Area 1154 sq. ft / 107.24 sq. m
Illustration for identification purposes only, measurements are approximate, not to scale.
Produced by Elements Property



Minutes away from Bow Road underground station, W J Meade are pleased to present this well presented three double bedroom ground floor apartment in a very popular block. The property has a open plan kitchen/lounge leading onto a private patio, three large bedrooms, one with en-suite, fully furnished and ideal for professional sharers. Close to all local amenities and easy access to the City.

Deposit is 5 week's rent.

All sizes are approximate. The Agent has not tested any apparatus, equipment, fixtures and fittings, or services and so cannot verify that they are in working order or fit for the purpose. A buyer is advised to obtain verification from their Solicitors or Surveyor. Photographs are for illustration purposes only and may depict items, which are not for sale or included in the sale price. References to tenure of a property are based upon information supplied by the vendor. The agent has not had sight of the title documents, a buyer is advised to obtain verification from their solicitor. Money Laundering Regulations 2003: Intending purchasers will be asked to produce identification, documentation at a later stage and we would ask for your co-operation in order that there will be no delay in agreeing the sale.

These particulars are intended to give a fair description of the property only and are in no way guaranteed, nor do of any contract. They are issued on the express condition that all negotiations are conducted through W.J. Meade Estate Agents. All subject to contract and to being unsold.

Service charge £n/a
Ground rent £n/a
Reserve fund £n/a
n/a years lease
Council tax band
Current EPC Rating 50

