



## MERCER COURT, MILE END E1

£1,750

- Fully Furnished
- Close to Stepney Green & Mile End Tube Stations
- Development on Regent's Canal
- Security Gated Entrance
- Modern Stylish Flat
- Juliet Balcony

**wj.**  
**meade**

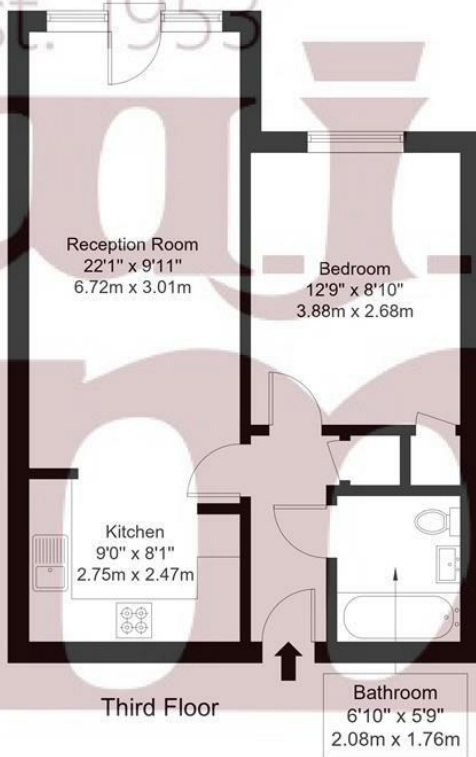

Approx Gross Internal Area = 46.2 sq m / 497 sq ft

The Floor plan is not to scale and measurements and areas shown are approximate and therefore should be used for illustrative purposes only. The plan has been prepared in accordance with the RICS code of Measuring Practice and whilst we have confidence in the information produced it must not be relied on. Maximum lengths and widths are represented on the floor plan. If there is any aspect of particular importance, you should carry out or commission your own inspection of the property.  
Copyright @ BleuPlan



W J Meade are pleased to present this spacious one double bedroom flat to rent in Mercer Court, E1. Located within a short walk of Mile End underground station, the property comes fully furnished with stylish furniture and benefits from a security gated entrance, open plan kitchen to lounge. The apartment also boasts a Juliette balcony. Seconds away from Mile End park, close to all local amenities and easy access to Canary Wharf and the City.

Deposit is 5 week's rent. Council Tax Band D

Service charge £n/a

Ground rent £n/a

Reserve fund £n/a

n/a years lease

Council tax band

Current EPC Rating 79



All sizes are approximate. The Agent has not tested any apparatus, equipment, fixtures and fittings, or services and so cannot verify that they are in working order or fit for the purpose. A buyer is advised to obtain verification from their Solicitors or Surveyor. Photographs are for illustration purposes only and may depict items, which are not for sale or included in the sale price. References to tenure of a property are based upon information supplied by the vendor. The agent has not had sight of the title documents, a buyer is advised to obtain verification from their solicitor. Money Laundering Regulations 2003: Intending purchasers will be asked to produce identification, documentation at a later stage and we would ask for your co-operation in order that there will be no delay in agreeing the sale.

These particulars are intended to give a fair description of the property only and are in no way guaranteed, nor do of any contract. They are issued on the express condition that all negotiations are conducted through W.J. Meade Estate Agents. All subject to contract and to being unsold.