



## High Street, Husthwaite Guide Price £675,000

\*\*\* WATCH OUR SOCIAL MEDIA REEL NOW \*\*\* Discreetly positioned off Husthwaite's picturesque High Street, this impressive 3 bedroom detached house stands within delightful gardens and grounds of around .28 of acre and provides over 1,900 sq ft of beautifully presented living accommodation, complemented by a gated driveway, generous parking and an attached double garage.

Follow Stephensons on your favourite social media platforms for exclusive video content, pre-market teasers, off market opportunities and a head start on other house hunters by getting to see many of our new listings before they appear online. Find us by searching for stephensons1871.



## Inside

The extended ground floor living accommodation provides a reception hall with timber flooring and doors leading off into a 27'0" (8.23m) long sitting room with wood burning stove and access out into the rear garden plus a generous 17'8" (5.38m) long snug/family room.

The stunning 21'0" (6.40m) long kitchen provides around 358 sq ft of flexible cooking, dining and living space with underfloor heating that features expansive Corian worktops, generous storage and an impressive central island with dining bar, complemented by a range of integrated appliances, high vaulted ceiling above the dining and living area plus double doors opening out into the south facing rear garden.

The ground floor also provides a spacious boot room/utility area with doors leading off into a cloakroom/wc and the attached double garage.

The first floor landing leads off into an impressive principal bedroom with superbly appointed dressing room and stylish en-suite shower room, 2 further double bedrooms (1 with fitted wardrobes) and a luxurious house bathroom with both bath and separate walk-in shower.

Other internal features of note include oil fired radiator central heating, double glazing and the benefit of supplementary energy and an income from solar panels.

## Outside

A 60 yard long driveway (shared with only 2 other neighbouring properties) leads up to a gated driveway that provides extensive parking and access into an attached double garage with a remote control door.

The plot itself extends to around .28 of acre and includes a lawned side garden and a generous south facing rear garden that features a paved seating area, lawn and well stocked flower and shrub bed borders.

## Tenure

Freehold

## Services/Utilities

Electricity, water and sewerage are understood to be connected.

## Broadband Coverage

Up to 76\* Mbps download speed

\*Download speeds vary by broadband providers so please check with them before purchasing.

## EPC Rating

C

## Council Tax

F - North Yorkshire Council

## Current Planning Permissions

No current valid planning permissions

## Viewings

Strictly via the selling agent - Stephensons Estate Agents, Easingwold



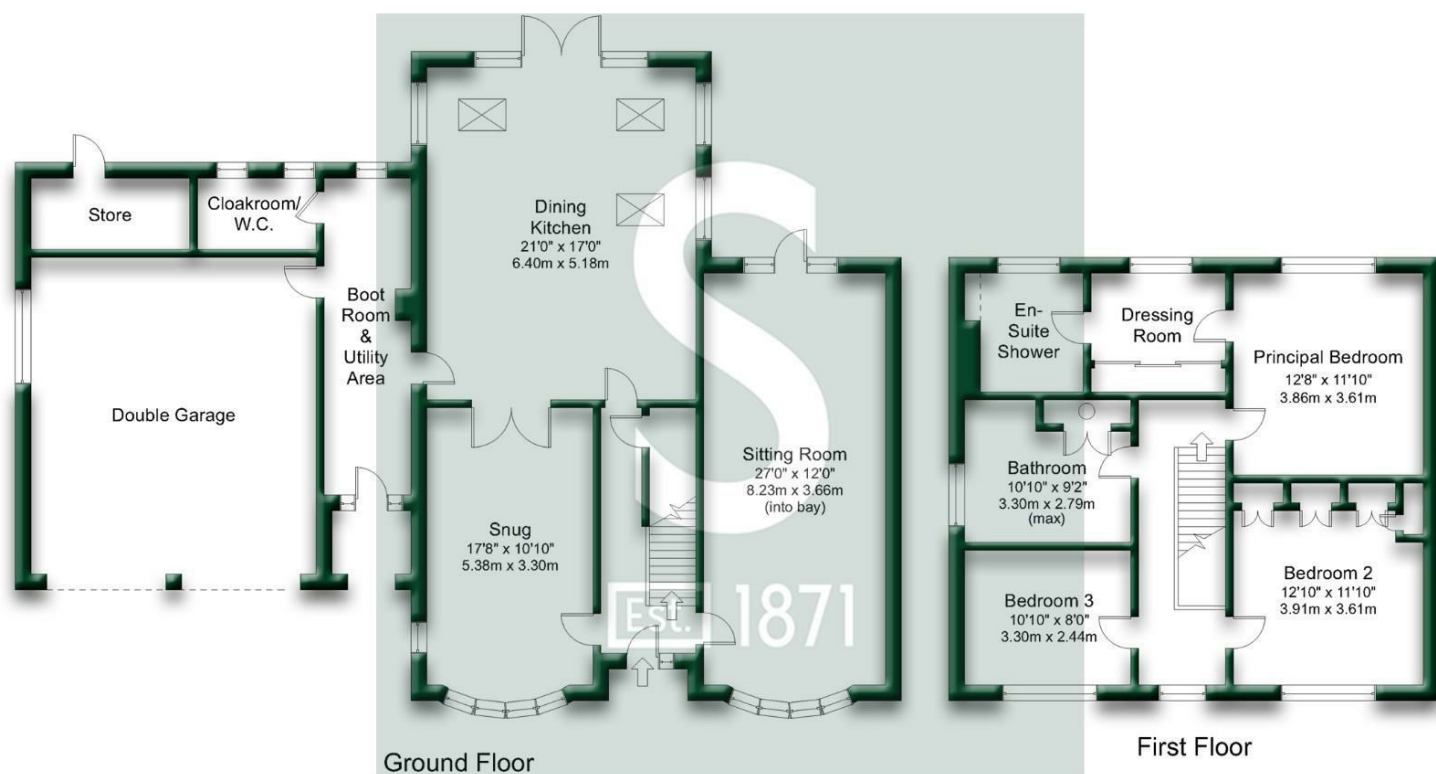

Gross internal floor area excluding Garage and Store (approx.): 177 sq m (1,905 sq ft)

Not to Scale.  
Copyright © Apex Plans.



## Stephensons

York	01904 625533
Knaresborough	01423 867700
Selby	01757 706707
Boroughbridge	01423 324324
Easingwold	01347 821145
York Auction Centre	01904 489731
Haxby	01904 809900

## Partners

J F Stephenson MA (cantab) FRICS FAAV  
I E Reynolds BSc (Est Man) FRICS  
R E F Stephenson BSc (Est Man) MRICS FAAV  
N J C Kay BA (Hons) pg dip MRICS  
O J Newby MNAEA  
J E Reynolds BA (Hons) MRICS  
R L Cordingley BSc FRICS FAAV  
J C Drewniak BA (Hons)

## Associates

N Lawrence

