

Mike  
**Dobson**



**4 Raper View**

Aberford, Leeds, LS25 3AF

**£240,000**



## 4 Raper View

A slightly elevated and extended three bedroom semi-detached chalet style house located in a cul-de-sac in the popular village of Aberford.

The accommodation briefly comprises entrance hall, lounge, dining area, kitchen/diner, first floor landing, bedroom one, bedroom two, bedroom three, and shower room/W.C.

In addition the property has PVCu double glazed windows and sliding doors from the kitchen/diner leading out to the rear garden, composite front entrance door, gas fired central heating, fitted kitchen with hob, oven, space for fridge, freezer, plumbing for washing machine, fitted wardrobes to bedroom one and bedroom three.

Externally, to the front of the property is a low maintenance garden and a pathway leads to the front door. There is a driveway which provides off road parking and leads to the integral garage with up and over door. To the rear of the property is a fully enclosed low maintenance garden being paved.









# Floor Plan

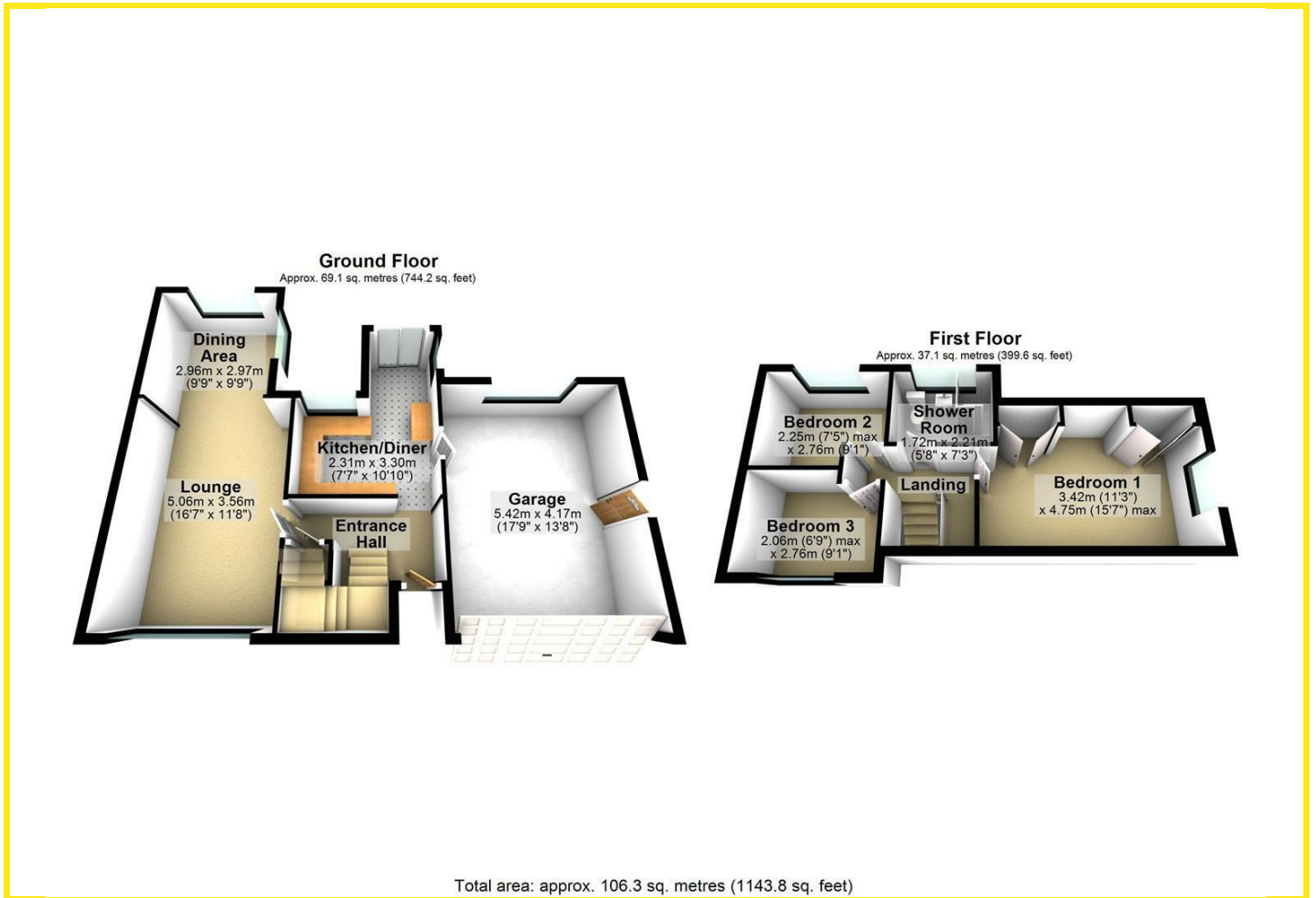

## Area Map

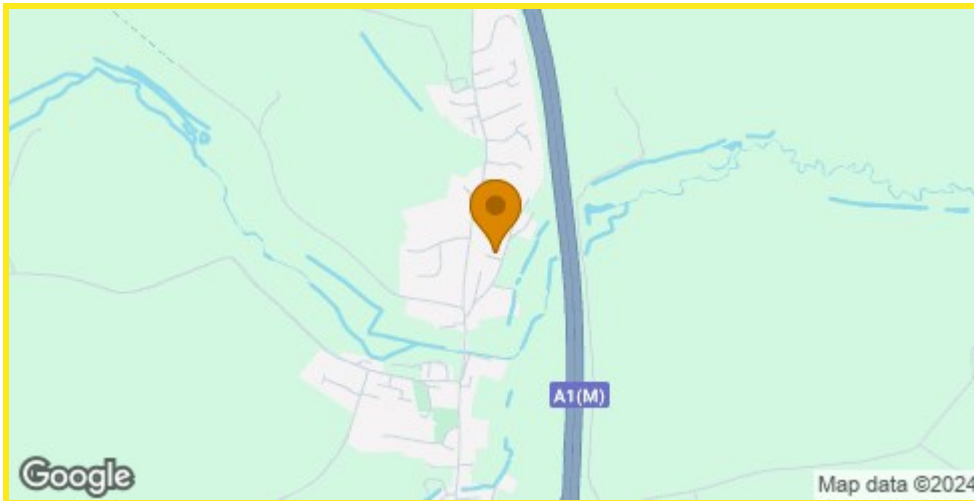

## Energy Efficiency Graph

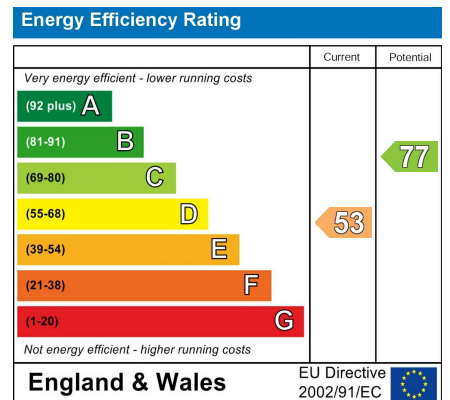

## Directions

In Aberford the Arabian Horse public house stands at the junction of Main Street and Field Lane. Turn up Field Lane. Follow Field Lane until you reach Raper View on the left hand side.

These particulars, whilst believed to be accurate are set out as a general outline only for guidance and do not constitute any part of an offer or contract. Intending purchasers should not rely on them as statements of representation of fact, but must satisfy themselves by inspection or otherwise as to their accuracy. No person in this firm's employment has the authority to make or give any representation or warranty in respect of the property.

4 Main Street, Garforth, LS25 1EZ

Tel: 0113 2864276 Email: [headoffice@mdobson.co.uk](mailto:headoffice@mdobson.co.uk) <https://www.mdobson.co.uk>