

Mike
Dobson



12 Primrose Dene

Byram, Knottingley, WF11 9DS

£230,000

12 Primrose Dene

Nestled in the charming Primrose Dene of Byram, Knottingley, this semi-detached house is a true gem waiting to be discovered. Boasting 2 reception rooms and 3 bedrooms, this property offers ample space for comfortable living.

Step inside to find a home that has been lovingly renovated and re-decorated throughout by its current owner, exuding a fresh and modern feel. The extended kitchen/dining area is a highlight, featuring a range of high gloss units and bi-fold doors that open seamlessly to the beautifully landscaped garden, with paved seating areas and AstroTurf, perfect for entertaining guests or enjoying a peaceful morning coffee.

The property also offers a modern three-piece white shower suite, with walk in double shower, vanity wash basin and low flush WC, adding a touch of luxury to everyday living. With off-road parking for multiple cars and a single garage, convenience is at the forefront of this home.

Don't miss the opportunity to make this property your own and experience the best of both indoor comfort and outdoor tranquillity in this delightful abode in Primrose Dene.





Floor Plan

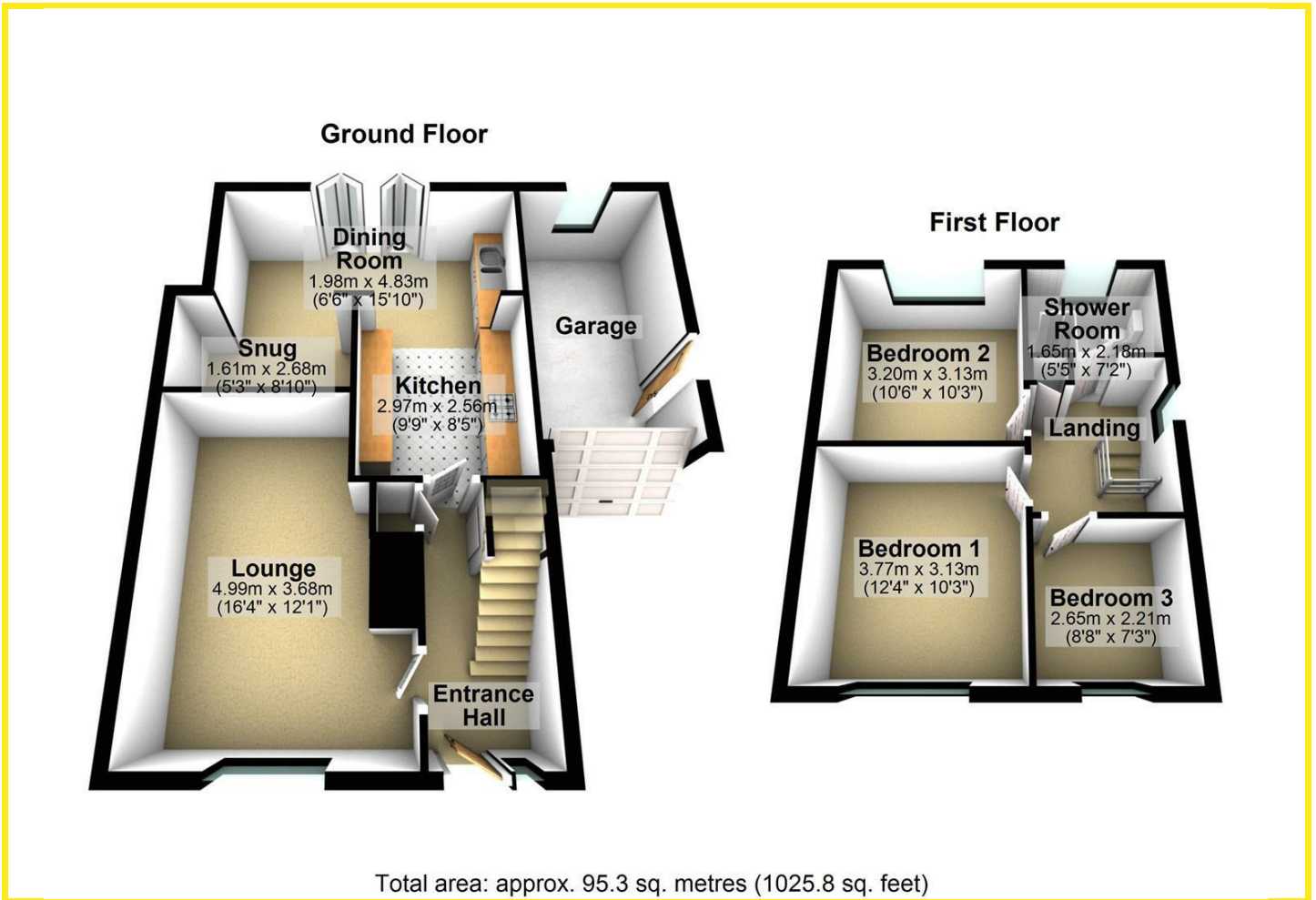

Area Map

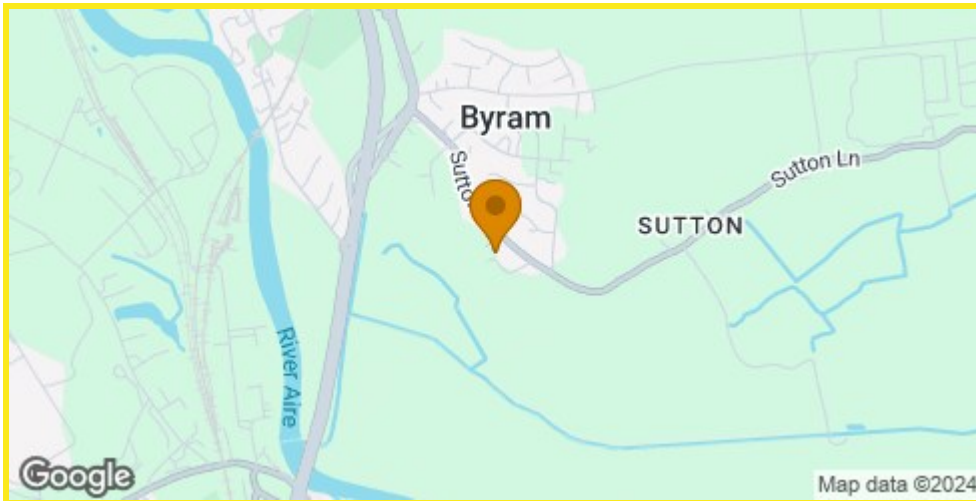

Energy Efficiency Graph

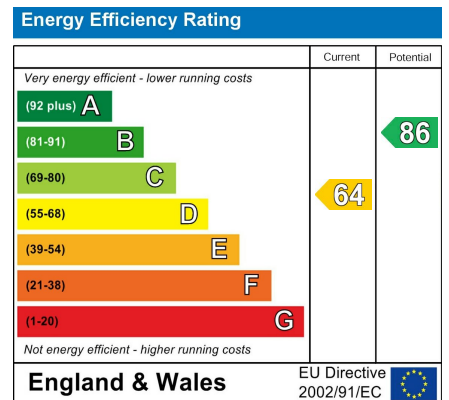

Directions

From our Sherburn office take a left at the junction onto Low Street. Continue along this road into South Milford, going past the BP petrol station on the left, to the roundabout, taking your third exit right onto the A162. Continue along this road to the next roundabout, taking your second exit straight on continuing along the A162 to the next mini roundabout, taking your first exit left onto Old Great North Road. Take your first left at the mini roundabout onto Sutton Lane, continuing on and taking your third right onto Primrose Dene where the property can be seen on the right hand side as indicated by the agents board.

These particulars, whilst believed to be accurate are set out as a general outline only for guidance and do not constitute any part of an offer or contract. Intending purchasers should not rely on them as statements of representation of fact, but must satisfy themselves by inspection or otherwise as to their accuracy. No person in this firm's employment has the authority to make or give any representation or warranty in respect of the property.

4 Main Street, Garforth, LS25 1EZ

Tel: 0113 2864276 Email: headoffice@mdobson.co.uk <http://www.mdobson.co.uk>