

Mike
Dobson



1 Maypole Cottages Elmwood Lane

Barwick In Elmet, Leeds, LS15 4JX

Chain Free £290,000

1 Maypole Cottages Elmwood Lane

Welcome to Elmwood Lane, a charming stone built property located in the picturesque village of Barwick In Elmet, Leeds. This delightful semi-detached house boasts 2 reception rooms, perfect for entertaining guests or simply relaxing with your loved ones, and three bedrooms so there's plenty of space for the whole family to unwind and recharge.

The property features two bathrooms, ensuring convenience and comfort for all residents. No more waiting in line during the morning rush! Additionally, parking is a breeze with space for one vehicle and a single garage, right at your doorstep.

Elmwood Lane offers a peaceful retreat from the hustle and bustle of city life, while still being conveniently located near local amenities and transport links.

The property has had some improvements done that require finishing along with other aspects of modernisation being required.

Don't miss out on the opportunity to make this house your home. Contact us today to arrange a viewing and take the first step towards creating your own slice of paradise in Barwick In Elmet.





Floor Plan

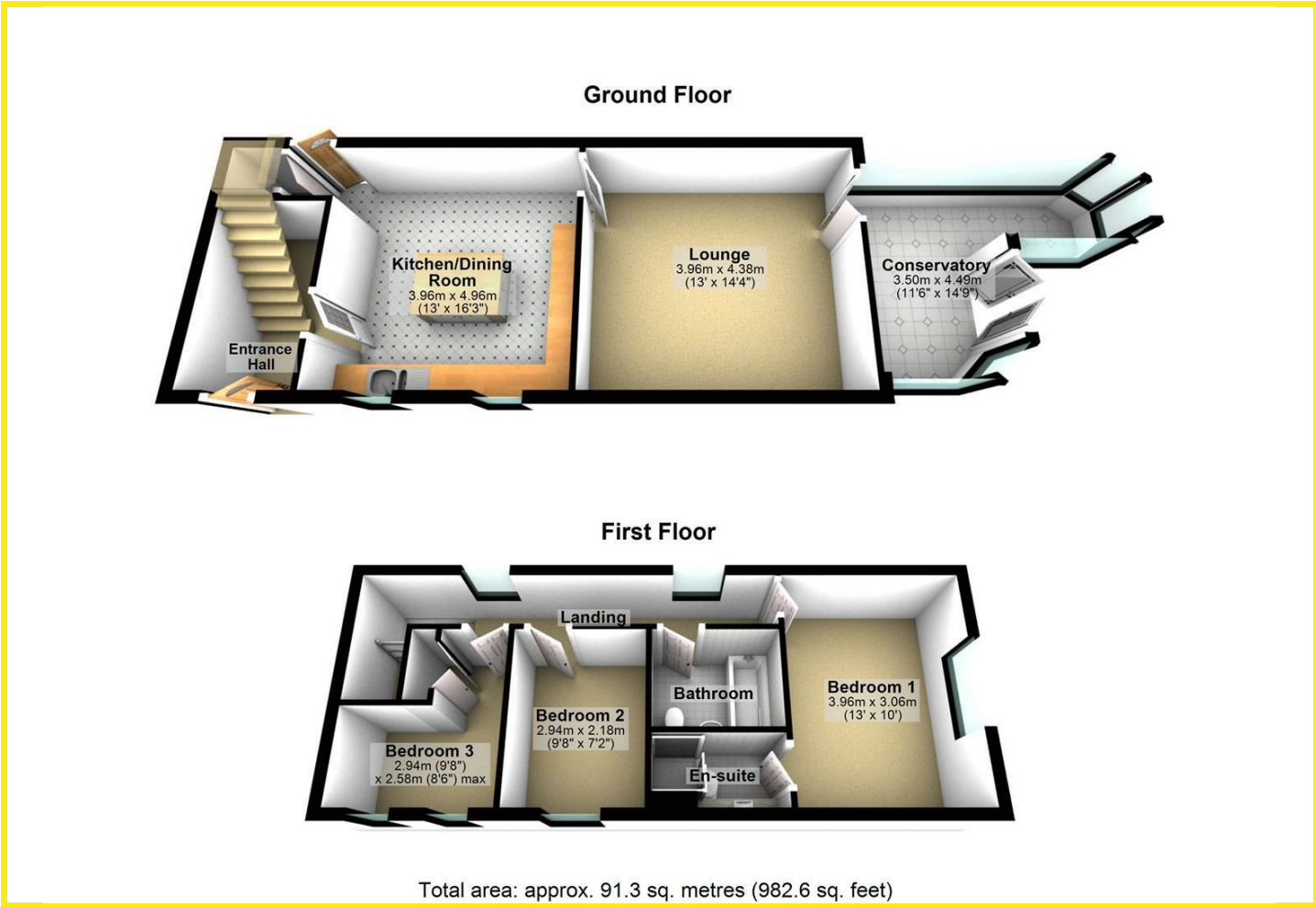

Area Map



Energy Efficiency Graph

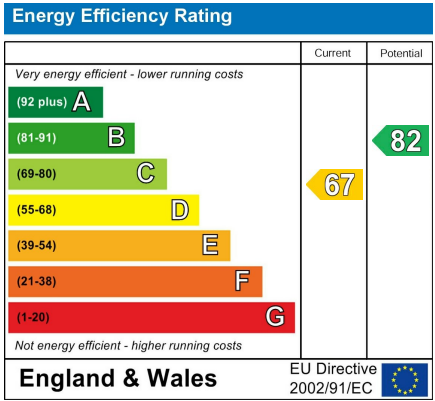

Directions

From our Garforth Office turn right on to Main Street following the road to the traffic lights. At the traffic lights proceed straight through onto Townend, which in turn becomes Barwick Road. Follow Barwick Road until entering the village of Barwick-in Elmet on Long Lane. Follow Long Lane to the 'T' junction with Main Street. Turn right onto Leeds Road and proceed to maypole, turning left onto Elmwood Lane where the property can be found on the left hand side.