

Mike
Dobson



8 Parlington Meadow

Barwick-In-Elmet, Leeds, LS15 4PB

Chain Free £365,000

8 Parlington Meadow

**** BEING OFFERED FOR SALE FREEHOLD PROPERTY WITH NO ONWARD CHAIN****

We are delighted to present to the market this four-bedroom detached family home, situated in the ever-popular village of Barwick In Elmet. The accommodation briefly comprises ground floor WC, lounge, open plan kitchen/dining, four bedrooms to the first floor with contemporary family bathroom. In addition, the property has PVCu double-glazing and gas central heating. Modern fitted kitchen with a range of integrated appliances to include built in oven, hob and extractor, integrated fridge freezer, washing machine and dishwasher and having French doors opening to the rear garden. Modern fitted bathroom suite being fully tiled with bath, shower over and side screen, vanity wash basin with cupboard below and low flush WC. Externally the property has a driveway providing off road parking and leading to a detached brick garage with up and over door, power and light and an EV charging point. The front garden has an open lawn and to the rear is a fully enclosed garden with lawn leading to a paved seating area.

Barwick-in-Elmet is located to the east of Leeds with local amenities including shops, Post Office, Public Houses and the historic Maypole. Local amenities include the shopping facilities of Garforth, 'The Springs' retail and leisure complex, Sainsbury's Retail Park in Colton and Crossgates which has a shopping centre, banks and a local railway station providing easy access to Leeds city centre.



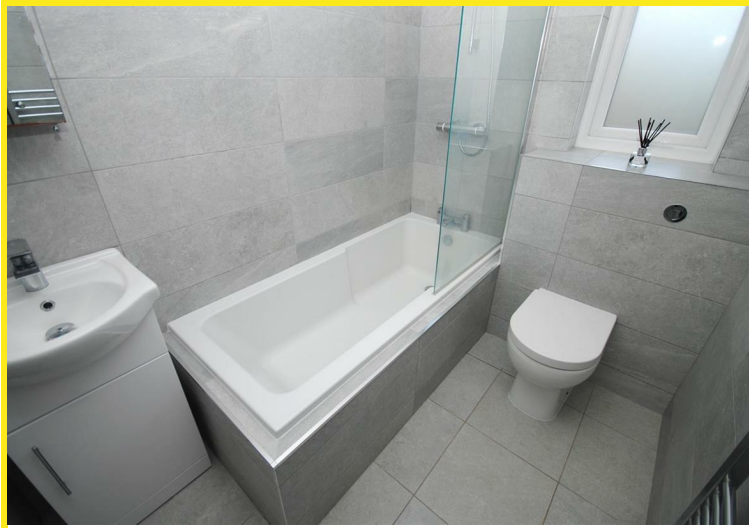

Floor Plan

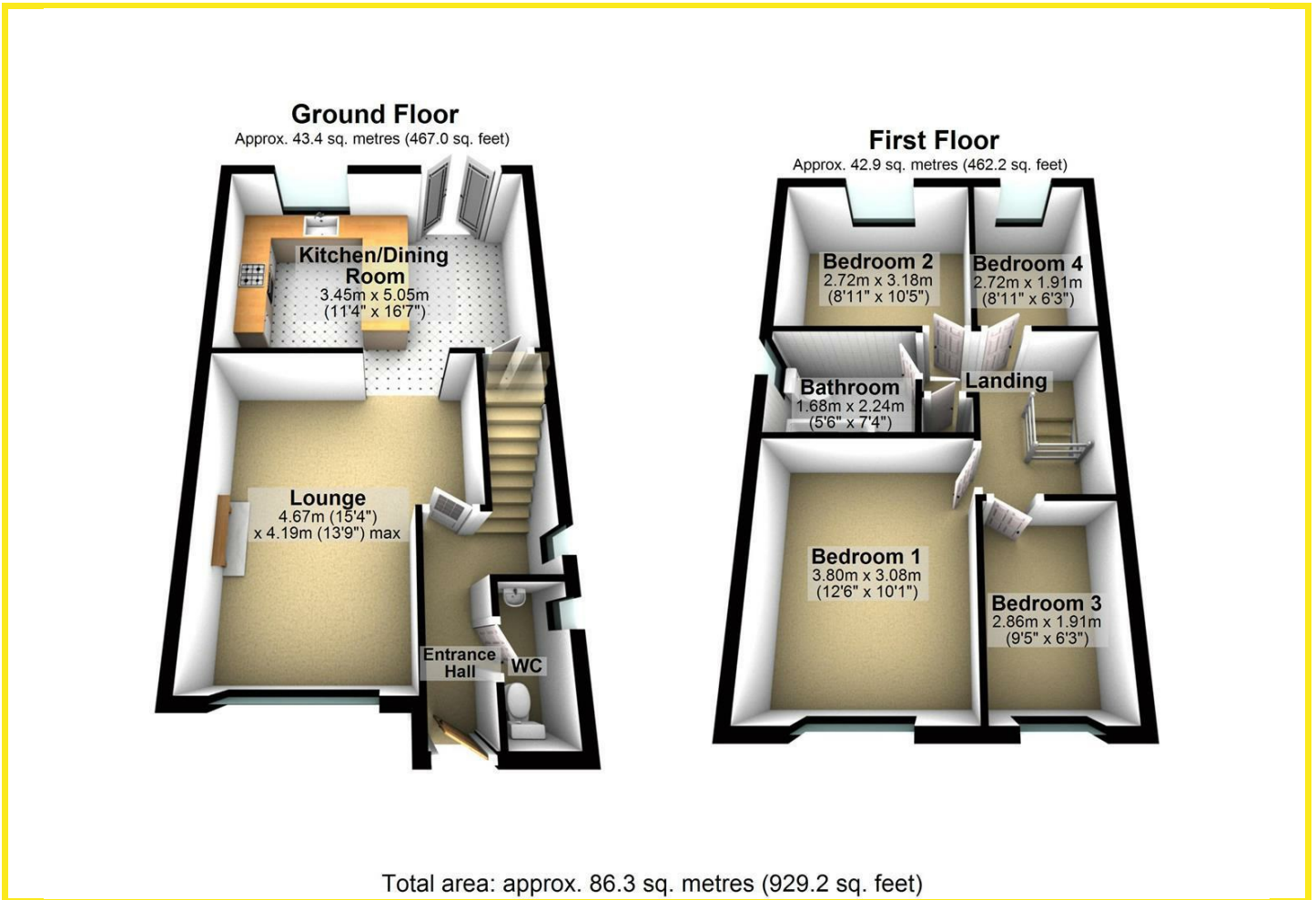

Area Map



Energy Efficiency Graph

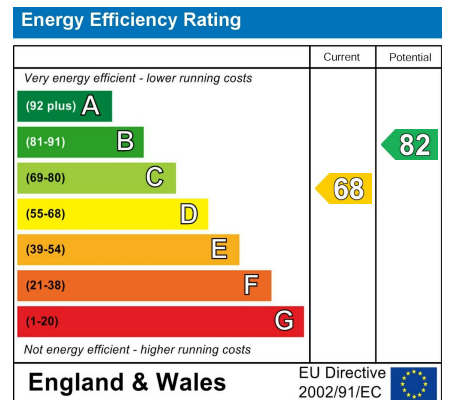

Directions

From our Garforth office turn right onto Main Street and continue to the traffic lights. Go straight ahead along Barwick Road and on reaching the village of Barwick In Elmet take the first right onto Parlington Meadow, where the property can be found as indicated by the agents board.

These particulars, whilst believed to be accurate are set out as a general outline only for guidance and do not constitute any part of an offer or contract. Intending purchasers should not rely on them as statements of representation of fact, but must satisfy themselves by inspection or otherwise as to their accuracy. No person in this firm's employment has the authority to make or give any representation or warranty in respect of the property.

4 Main Street, Garforth, LS25 1EZ

Tel: 0113 2864276 Email: headoffice@mdobson.co.uk <https://www.mdobson.co.uk>