



WHITEHORNES

Buy. Sell. Let. Relax!

0114 268 8533
info@whitehorns.com
www.whitehorns.com

2 Coniston Terrace, Abbeydale

Sheffield

Offers in Region of £160,000

2 Coniston Terrace

Abbeydale, Sheffield

A well presented and proportioned two double bedroom, mid Victorian terraced property. Quietly tucked away on this no through road in the very heart of fashionable Abbeydale. Offered to the open market with the benefit of no upward chain and immediate vacant possession it's easy to say this property will sure to be of interest to the professional couple, first time buyer those looking to downsize or the investors as it's previously been used as a successful buy to let investment. With easy on road parking to the front, private rear sunny garden and down stairs off shot bathroom. Perfectly placed within a short stroll of numerous independent cafes, eateries and shops within the buzzing high street, Millhouses park is close by as is The Peak District and central Sheffield. In brief the property comprises, sitting room, dining kitchen and bathroom are on the ground floor.

Council Tax band: A

Tenure: Leasehold

- LOVELY TWO BEDROOM MID VICTORIAN TERRACED
- QUIET NO THROUGH ROAD IN THE HEART OF FASHIONABLE ABBEYDALE
- AVAILABLE WITH NO UPWARD CHAIN AND VACANT POSSESSION
- PERFECT FOR THE FIRST TIME BUYER DOWN SIZER OR INVESTMENT
- EASY ACCESS TO MILLHOUSES PARK AND URBAN GREEN SPACES
- REAR PRIVATE TERRACED GARDEN AND EASY ON ROAD PARKING TO THE FRONT
- VIEWING ADVISED TO SEE THE FULL POTENTIAL ON OFFER
- NUMEROUS INDEPENDENT CAFES SHOPS AND EATERIES A SHORT STROLL AWAY





Ground Floor

Approx. 29.1 sq. metres (313.2 sq. feet)

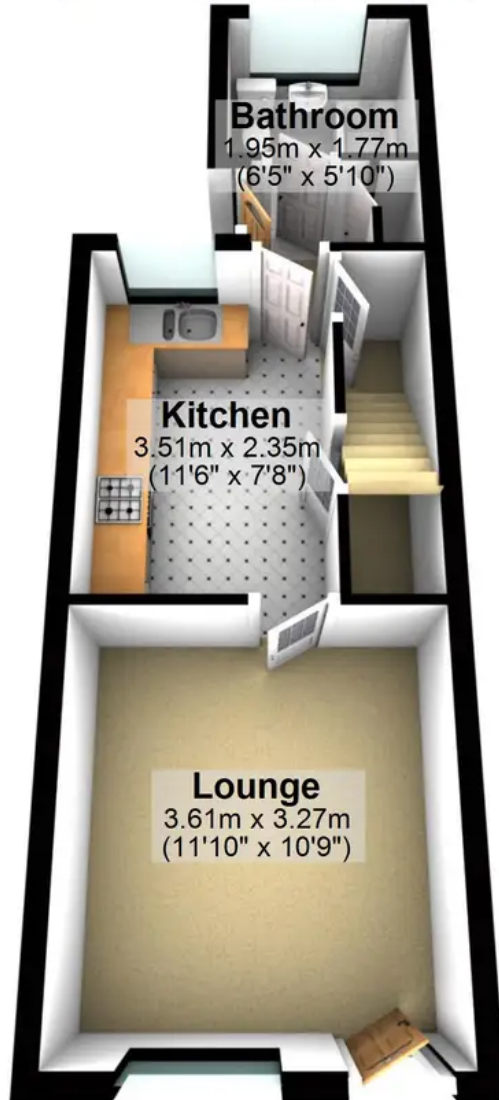

First Floor

Approx. 23.6 sq. metres (254.2 sq. feet)



Total area: approx. 52.7 sq. metres (567.4 sq. feet)

All measurements are approximate
Plan produced using PlanUp.