





WHARF LANE RICKMANSWORTH WD3
£1,750 PER MONTH AVAILABLE NOW

Hamptons
THE HOME EXPERTS

{ THE PARTICULARS

Wharf Lane Rickmansworth WD3

£1,750 Per Month
Unfurnished

 **2 Bedrooms**
 **2 Bathrooms**
 **1 Reception**

Features

- Two bedroom second floor flat, - Two bathrooms, - Modern kitchen and bathroom, - Balcony, - Gated allocated parking, - Town centre location, - Deposit equivalent to 5 weeks' rent, - Council Tax Band E

Council Tax

Council Tax Band E

Hamptons

2 Station Road
Rickmansworth, WD3 1QZ
01923 896444
rickmansworthlettings@hamptons.co.uk
www.hamptons.co.uk

{ A WELL PRESENTED SECOND FLOOR APARTMENT WITH A BALCONY

The Property

This lovely modern apartment is located in Rickmansworth, just a short walk to shops and the Met line station. Located on the second floor of this modern building the accommodation comprises: Entrance hallway with storage cupboards leading to open plan kitchen, living and dining room with direct access to the balcony, main bedroom with en-suite shower room and built in wardrobes, second double bedroom with fitted double wardrobes and modern main bathroom. Outside there is an allocated parking space behind secure electric gates. Deposit equivalent to 5 weeks' rent. Council tax Band E.

Location

Rickmansworth has a good selection of shops and supermarkets including Marks and Spencer, Waitrose and Tesco. The Metropolitan and Main Line railway services to The City, Baker Street and Marylebone are available from Rickmansworth Station. The M25 at Junction 18 connects with the national motorway network and airports. The Aquadrome in Rickmansworth offers two boating lakes and a network of paths around the park, a café, Grand Union Canal and wildlife sanctuary.



Wharf Lane, Rickmansworth, WD3

Approximate Area = 664 sq ft / 61.6 sq m

For identification only - Not to scale

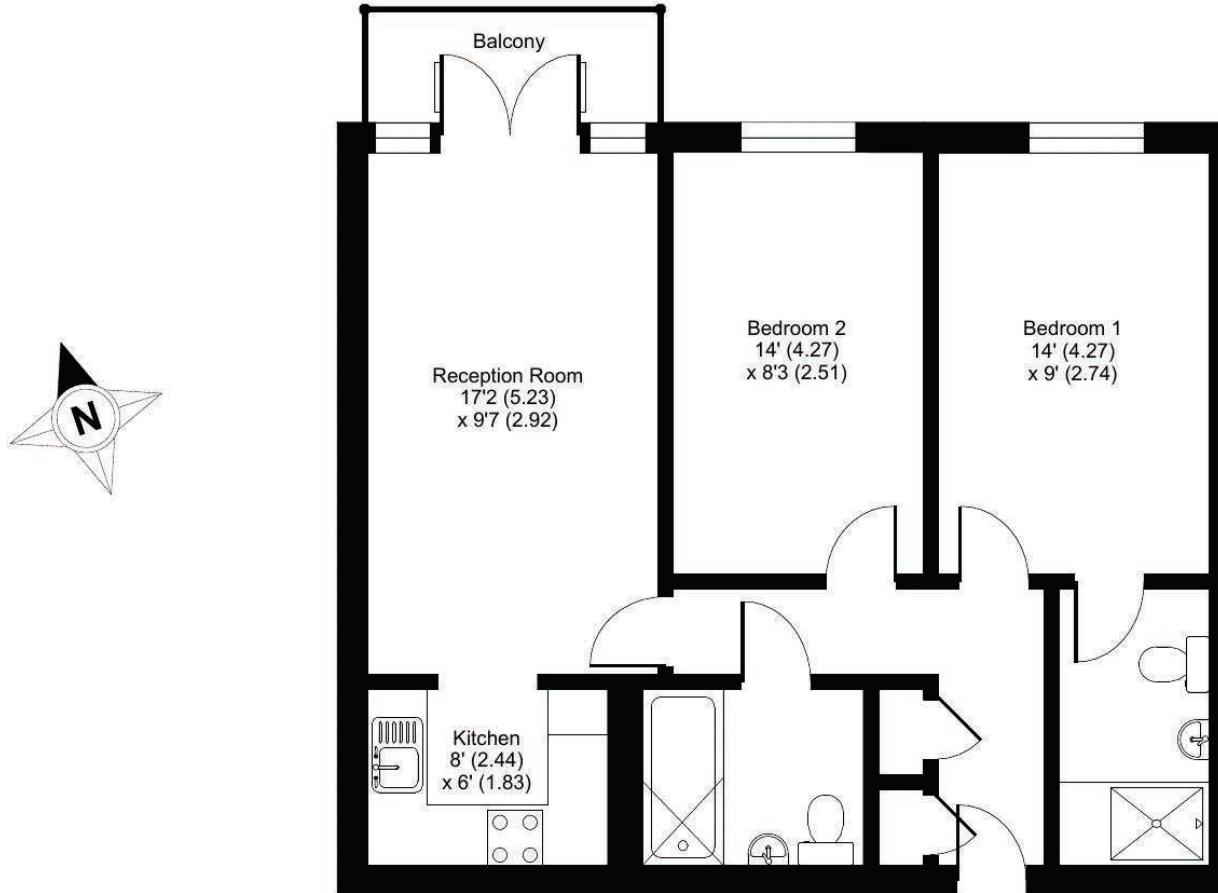

SECOND FLOOR



Floor plan produced in accordance with RICS Property Measurement Standards incorporating International Property Measurement Standards (IPMS2 Residential). © nichecom 2022. Produced for Hamptons Country Lettings. REF: 859716

For Clarification

We wish to inform prospective tenants that we have prepared these particulars as a general guide and they have been confirmed as accurate by the landlord. We have not verified permissions, nor carried out a survey, tested the services, appliances and specific fittings. Room sizes are approximate and measurement figures rounded: they are taken between internal wall surfaces and therefore include cupboards/shelves, etc. Accordingly, they should not be relied upon for

carpets and furnishings. It should also be noted that all fixtures and fittings, carpeted, curtains/blinds, kitchen equipment and garden statuary, whether fitted or not, are deemed removable by the landlord unless specifically itemised with these particulars. Please enquire in office or on our website for details on holding deposit and tenancy deposit figures.

