



17 Furry Way, Helston, TR13 8SN

£230,000 Freehold

CHRISTOPHERS
ESTATE AGENTS

17 Furry Way

- TWO BEDROOM TERRACED HOUSE
- SITUATED AT THE END OF A CUL-DE-SAC
- CLOSE TO HELSTON BOATING LAKE AND PENROSE
- IDEAL FOR FIRST TIME BUYERS OR INVESTORS
- FRONT AND REAR GARDENS
- COMMUNAL PARKING
- FREEHOLD
- COUNCIL TAX BAND B
- EPC C71

A very nicely presented two bedroom terraced house, situated in a well regarded residential area of Helston.

Nicely tucked away towards the end of this sought after cul-de-sac, the property benefits from mains gas fired central heating, double glazing and a communal parking area.

The residence is conveniently situated moments from the town and in particular the boating lake amenity area and nearby National Trust Penrose Estate with its woodland walks and trails to the sea beyond.

Presented to the market in good order throughout the property would make an ideal purchase for first time buyers or an investor seeking a rental return.

The accommodation in brief comprises an entrance porch, lounge and fitted kitchen, whilst on the first floor there are two bedrooms and a bathroom. There are pleasant gardens to the front and rear and communal parking.







Helston itself is a bustling market town that stands as a gateway to The Lizard Peninsula which is designated as an area of outstanding natural beauty with many beautiful beaches, coves and cliff top walks. The town has amenities that include, national stores, supermarkets, doctors' surgeries, churches and also many clubs and societies. There are a number of well regarded primary schools, a comprehensive school with sixth form college and a leisure centre with indoor heated pool.

THE ACCOMMODATION COMPRISES (DIMENSIONS APPROX)
Part glazed door with side panel to entrance porch.

ENTRANCE PORCH

With cupboard housing electric consumer unit, vinyl flooring and door to lounge.

LOUNGE 16'6 x 14'2 (inc stairs) (5.03m x 4.32m (inc stairs))
Enjoying a sunny outlook with a bay style window looking out over the front garden and fields beyond neighbouring properties. A decorative feature fireplace with a tiled hearth and wood surround provides a nice focal point for the room. There is a useful under stairs storage cupboard, a coat hanging rail, an opening to the staircase and a door to.

KITCHEN 14'2 x 9 (narrowing to 5'8) (4.32m x 2.74m (narrowing to 1.52m'2.44m))

Nicely appointed with grey gloss units and working top surfaces that incorporate a composite sink with drainer, mixer tap over and attractive tiled splash backs. There are a useful range of base cupboards with wall units and display shelves over. Spaces are provided for an electric cooker with a hood over (not in working order), a fridge/freezer and a washing machine. There is a handy breakfast bar arrangement, a Worcester gas boiler, spotlighting, contemporary grey vinyl flooring, a window to the rear aspect and a part glazed door to the rear garden.

A STAIRCASE RISES AND TURNS TO FIRST FLOOR

LANDING

With loft hatch to roof space and doors off to bathroom and both bedrooms.

BEDROOM ONE 14'2 x 10'2 (inc built in cupboard) (4.32m x 3.10m (inc built in cupboard))

A comfortable double bedroom with built-in storage cupboard with hanging rail and twin windows to the front aspect

BEDROOM TWO 10' x 9' (inc door recess) (3.05m x 2.74m (inc door recess))

With window to rear aspect

BATHROOM

With fitted suite comprising a low-level WC, pedestal wash hand basin and a panelled bath with shower screen and attachment over. The walls are partly tiled, with grey vinyl flooring and obscure glazed window to the rear aspect.

OUTSIDE

The front garden enjoys a sunny outlook and is laid largely to lawn with a pathway which leads on to the property. To the rear is a neatly enclosed garden with a pleasant patio, a lawned area with shrubs and plants at the borders, a shed and a pathway to the rear gate.

PARKING

There is a communal parking area close to the property.

SERVICES

Mains electricity, gas, water and drainage

COUNCIL TAX

Council Tax Band B

AGENTS NOTE ONE

We are advised that the property benefits from right of way that runs behind the rear garden and enables access without having to go through the property itself.

AGENTS NOTE TWO

Neighbouring properties also have a similar right of way to the one above to access the rear of their properties where needed.





DIRECTIONS

From Helston town centre proceed down Coinagehall Street, at the bottom, bear left into Monument Road. Turn right at the first mini roundabout and left at the second roundabout towards Porthleven. Take the first turning on the left and proceed up the hill into Furry Way. The property can be found at the head of the cul-de-sac.

VIEWING

To view this property or any other property we are offering for sale, simply call the number on the reverse of these details.

MOBILE AND BROADBAND

To check the broadband coverage for this property please visit -

<https://www.openreach.com/fibre-broadband>

To check the mobile phone coverage please visit -

<https://checker.ofcom.org.uk/>

ANTI-MONEY LAUNDERING

We are required by law to ask all purchasers for verified ID prior to instructing a sale

PROOF OF FINANCE - PURCHASERS

Prior to agreeing a sale, we will require proof of financial ability to purchase which will include an agreement in principle for a mortgage and/or proof of cash funds.

DATE DETAILS PREPARED.

1st April 2025



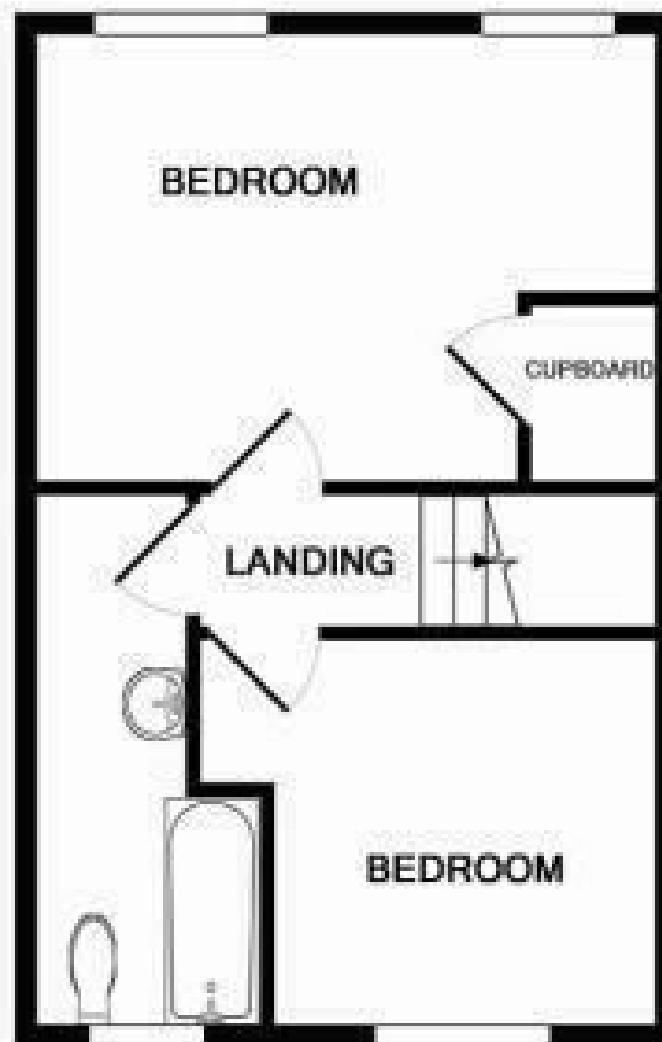
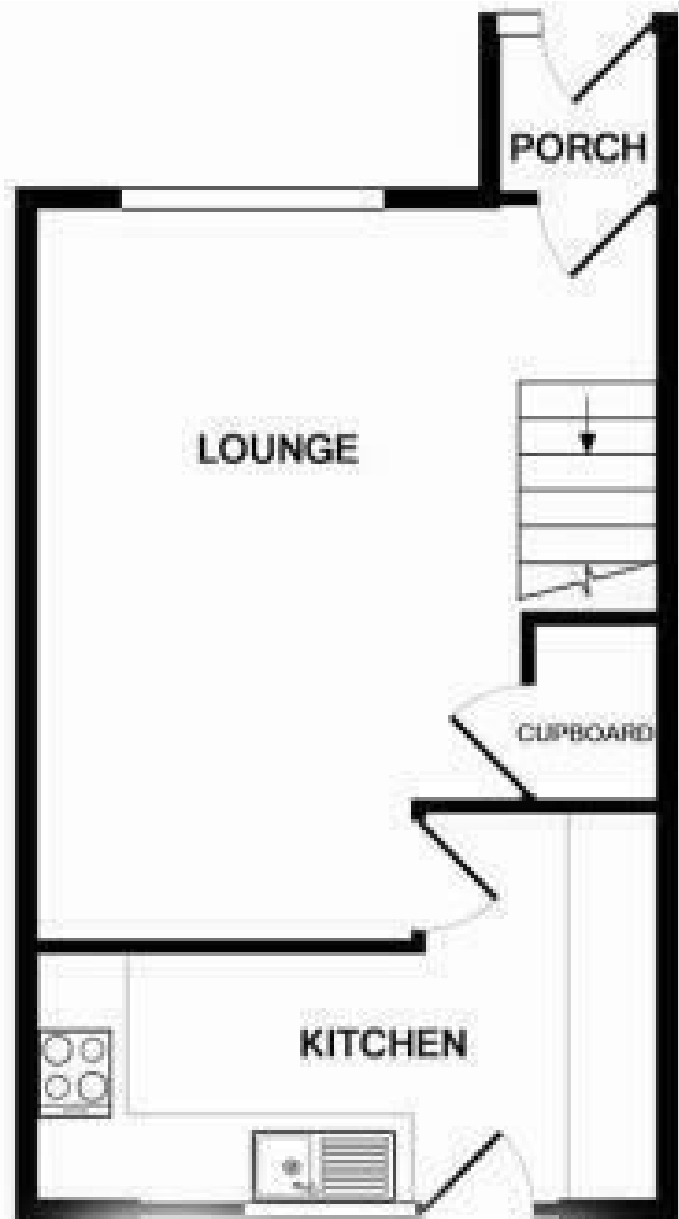

Energy Efficiency Rating		
	Current	Potential
Very energy efficient - lower running costs		
(92 plus) A		86
(81-91) B		
(69-80) C	71	
(55-68) D		
(39-54) E		
(21-38) F		
(1-20) G		
Not energy efficient - higher running costs		
England & Wales		EU Directive 2002/91/EC

These particulars are set out as a general outline in accordance with the Property Misdescriptions Act (1991) only for the guidance of intending purchasers or lessees, and do not constitute any part of an offer or contract. Details are given without any responsibility, and any intending purchasers, lessees or third parties should not rely on them as statements or representations of fact, but must satisfy themselves by inspection or otherwise as to the correctness of each of them. We have not carried out a structural survey and the services, appliances and specific fittings have not been tested. All photographs, measurements, floor plans and distances referred to are given as a guide only and should not be relied upon for the purchase of a property or any other figures or fittings. Gardens, roof terraces, balconies and communal gardens as well as tenure and lease details cannot have their accuracy guaranteed for intending purchasers. Lease details, service ground rent (where applicable) are given as a guide only and should be checked and confirmed by your solicitor prior to exchange of contracts.



Christophers Estate Agents

5 Wendron Street, Helston, TR13 8PT

01326 565566 | property@christophers.uk.com | christophers.uk.com

CHRISTOPHERS
ESTATE AGENTS