



30 Nanscober Place, Helston, TR13 0SP

£220,000 Freehold

CHRISTOPHERS
ESTATE AGENTS

30 Nanscober Place

Situated in a lovely location on the edge of town, this two-bedroom property presents a fantastic opportunity for first-time buyers or small families. It enjoys a tranquil position, fronting an attractive green area with scenic views over the Cober Valley, offering easy access to beautiful wooded riverside walks.

The property itself boasts a cosy yet spacious lounge, ideal for relaxing, and a bright kitchen/breakfast room with direct access to the enclosed rear garden. Upstairs, you will find two comfortable double bedrooms and a family bathroom.

The rear garden is designed to be low maintenance, making it easy to enjoy outdoor space without hours of upkeep. The property also benefits from allocated off-road parking for added convenience.

With updated UPVC double glazed doors and windows, as well as efficient air source heating, this home combines comfort and modern living. Do not miss out on the chance to own this super property in a sought after location.







THE ACCOMMODATION COMPRISES (DIMENSIONS APPROX)

Door to entrance porch.

ENTRANCE PORCH

With panelled glazed door to lounge.

LOUNGE 15'5" x 11'8" (4.70m x 3.56m)

With radiator and window to the front offering an attractive outlook. Turning staircase to first floor with understairs storage cupboard and door to kitchen/breakfast room.

KITCHEN/BREAKFAST ROOM 11'7" x 9'6" (3.53m x 2.90m)

A lovely light room with direct access to the garden. With tiled floor fitted with a range of base and wall units including larder cupboard with work surfaces over and stainless steel sink and drainer. Space and point for fridge/freezer and space and plumbing for washing machine. Beko integrated electric oven with gas hob over and filter and light above. Radiator. Double doors and window to the rear garden.

FIRST FLOOR LANDING

With loft access and doors to various rooms.

BEDROOM ONE 11'7" x 9'6" (3.53m x 2.90m)

With radiator and window to the rear overlooking the garden.

BEDROOM TWO 11'8" x 7'2" (3.56m x 2.18m)

With radiator and window to rear offering an attractive view across the Cober Valley.

BATHROOM 8' x 4'6" (2.44m x 1.37m)

With a suite comprising a bath with wall mounted shower attachment over, wash handbasin in a vanity unit with useful cupboard below, low level W.C., chrome effect ladder style radiator and useful large storage cupboard.

OUTSIDE

To the front of the property is a token lawned area with path to the front door. The main gardens lie to the rear of the property and are designed for ease of maintenance comprising of a patio area with gravelled tiers. The entire garden is enclosed by fencing with a pedestrian access gate to the parking space where there is space for two vehicles parked in tandem.

SERVICES

Mains water, electricity, gas and drainage. Full fibre connection. Air source heating.

DIRECTIONS

From Helston town centre proceed up Wendron Street and along Godolphin Road at the Turnpike Roundabouts turn left signposted Redruth. Follow this road passing the Fire Station on the left hand-side and immediately after this turn left at the mini-roundabout into the Water-ma-Trout Industrial Estate. Proceed straight on and as one descends the hill go over the small mini-roundabout and take the next turning right. Proceed down this road and bear left, proceed down the hill to the bottom and the property will be found on your left hand side.





VIEWING

To view this property, or any other property, we are offering for sale, simply call the number on the reverse of these details.

COUNCIL TAX

Council Tax Band B

MOBILE AND BROADBAND

To check the broadband coverage for this property please visit -

<https://www.openreach.com/fibre-broadband>

To check the mobile phone coverage please visit -

<https://checker.ofcom.org.uk/>

ANTI-MONEY LAUNDERING

We are required by law to ask all purchasers for verified ID prior to instructing a sale

PROOF OF FINANCE - PURCHASERS

Prior to agreeing a sale, we will require proof of financial ability to purchase which will include an agreement in principle for a mortgage and/or proof of cash funds.

DATE DETAILS PREPARED

25th February, 2025.

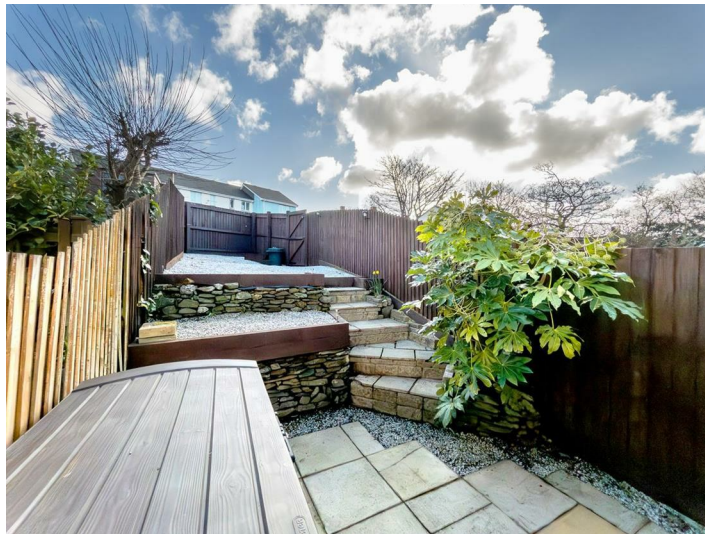

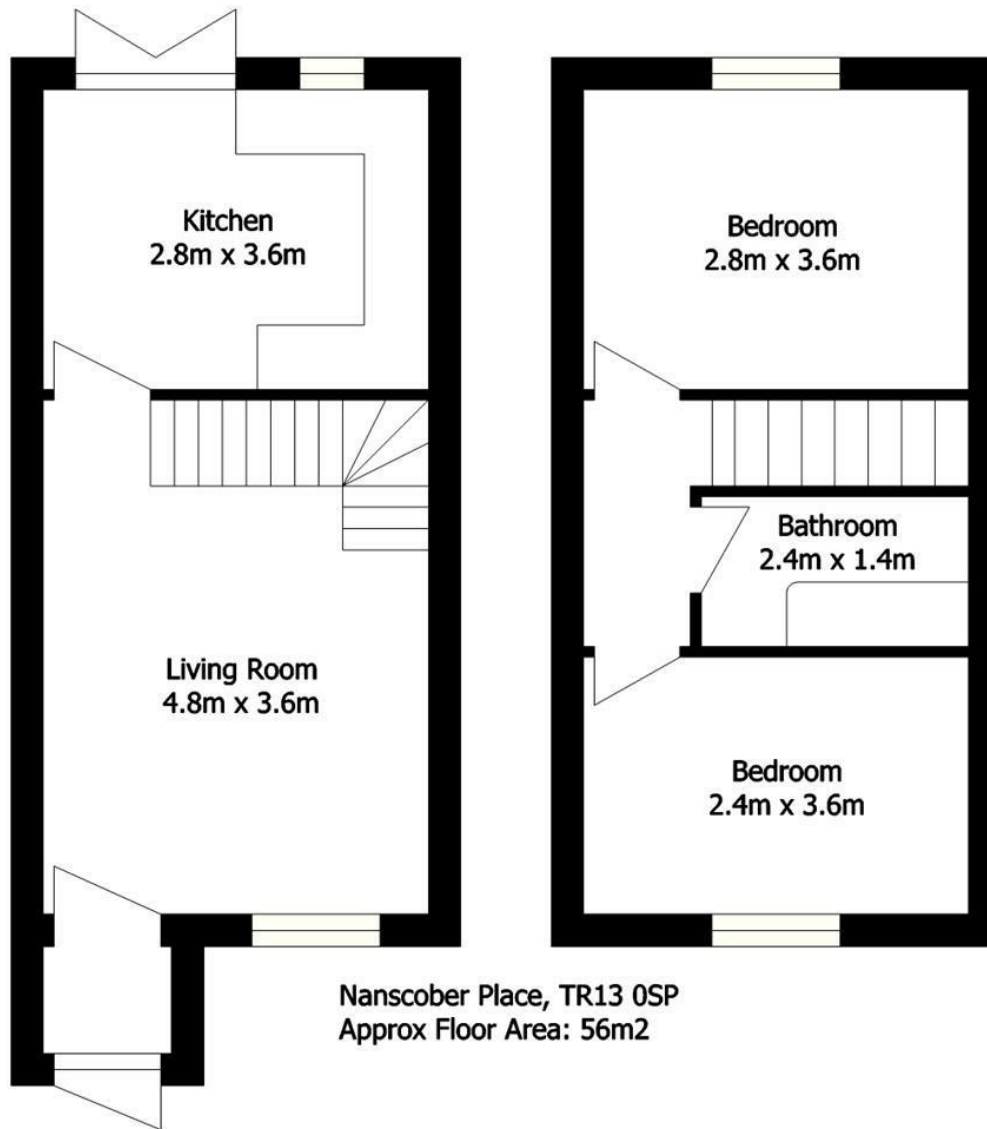

Nanscober Place, TR13 0SP
Approx Floor Area: 56m²

| Energy Efficiency Rating | | Current | Potential |
|---|--|-------------------------|--|
| Very energy efficient - lower running costs | | | |
| (92 plus) A | | | <div style="border: 1px solid black; padding: 5px; text-align: center;">91</div> |
| (81-91) B | | | |
| (69-80) C | | 72 | |
| (55-68) D | | | |
| (39-54) E | | | |
| (21-38) F | | | |
| (1-20) G | | | |
| Not energy efficient - higher running costs | | | |
| England & Wales | | EU Directive 2002/91/EC | |

These particulars are set out as a general outline in accordance with the Property Misdescriptions Act (1991) only for the guidance of intending purchasers or lessees, and do not constitute any part of an offer or contract. Details are given without any responsibility, and any intending purchasers, lessees or third parties should not rely on them as statements or representations of fact, but must satisfy themselves by inspection or otherwise as to the correctness of each of them. We have not carried out a structural survey and the services, appliances and specific fittings have not been tested. All photographs, measurements, floor plans and distances referred to are given as a guide only and should not be relied upon for the purchase of a property or any other fixtures or fittings. Gardens, roof terraces, balconies and communal gardens as well as fixtures and fittings cannot have their accuracy guaranteed for intending purchasers. Lease details, service ground rent (where applicable) are given as a guide only and should be checked and confirmed by your solicitor prior to exchange of contracts.



Christophers Estate Agents

5 Wendron Street, Helston, TR13 8PT

01326 565566 | property@christophers.uk.com | christophers.uk.com

CHRISTOPHERS
ESTATE AGENTS