



13 Castle Green, Helston, TR13 8EY

£224,950 Freehold

CHRISTOPHERS
ESTATE AGENTS

13 Castle Green

- TWO BEDROOMS
- TERRACED COTTAGE
- GARDEN
- OUTBUILDING
- FEATURE FIREPLACE
- FREEHOLD
- COUNCIL TAX BAND B
- EPC - E42

Situated in the delightful terraces of Castle Green is this two bedroom, mid terraced cottage. The residence, which benefits from double glazing, has many character features from an attractive local stone facade, beamed ceiling and a feature fireplace which houses a wood burner.

In brief, the accommodation comprises a lounge, kitchen/diner and on the first floor a shower room and two bedrooms. To the outside is a pleasant garden to the front whilst to the rear of the property is an outbuilding which houses some utilities.

Helston itself is a bustling market town that stands as a gateway to The Lizard Peninsula which is designated as an area of outstanding natural beauty with many beautiful beaches, coves and cliff top walks. The town has amenities that include national stores, supermarkets, doctors' surgeries, churches and also many clubs and societies. There are a number of well regarded primary schools, a comprehensive school with sixth form college and a leisure centre with indoor heated pool.

DOOR TO







LOUNGE 11'6" x 8'

With outlook to the front and a feature fireplace with tiled hearth and wood mantel over housing a wood burner. Door to

KITCHEN/DINER 11'3" x 9'3"

Comprising working top surfaces incorporating a sink unit with drainer and mixer tap over, cupboards and drawers under and wall cupboards over. Built in appliances include an oven with hob over and there is an outlook and door to the outside. There are partially tiled walls, beamed ceiling, under stairs cupboard and stairs to the first floor.

STAIRS AND LANDING

With access to the loft, doors to all remaining rooms.

SHOWER ROOM

Comprising a shower cubicle, pedestal wash basin and a close coupled w.c.. There is an obscured window to the rear.

BEDROOM ONE 10' x 8'

With outlook to the front and having built in wardrobes.

BEDROOM TWO 9' x 5'9" (maximum measurements)

With outlook to the rear and having built in wardrobes.

OUTSIDE

To the front of the property is a pleasant garden which is mainly stone chipped for ease of maintenance and has well established plants and shrubs. To the rear of the property is a pathway which leads to an outbuilding which houses some utilities and plumbing for a washing machine.

AGENTS NOTE

We are advised there is a right of way over the path to the rear of the residence in favour of neighbouring properties.

SERVICES

Mains electricity, water and drainage.

VIEWING

To view this property or any other property we are offering for sale, simply call the number on the reverse of these details.

DIRECTIONS

From Helston town centre proceed down Coinagehall Street, bearing left down Monument Road, crossing the roundabouts, taking the A394 which is signposted to Penzance. You will come to a set of traffic lights at the pedestrian crossing, turn right here. Take the next right in to the car park where you will see the property on the left hand side identifiable by our For Sale board.

AGENTS NOTE

We are advised by the owners that their buildings' insurance excludes cover for flooding.

MOBILE AND BROADBAND COVERAGE

To check the broadband coverage for this property please visit -

<https://www.openreach.com/fibre-broadband>

To check the mobile phone coverage please visit -

<https://checker.ofcom.org.uk/>

CONSERVATION AREA

We understand this property is located in a conservation area. For details of conservation areas visit Cornwall Mapping and use the Council's interactive map.





COUNCIL TAX BAND

Band B

ANTI MONEY LAUNDERING REGULATIONS - PURCHASER

We are required by law to ask all purchasers for verified ID prior to instructing a sale.

PROOF OF FUNDS - PURCHASERS

Prior to agreeing a sale, we will require proof of financial ability to purchase which will include an agreement in principle for a mortgage and/or proof of cash funds.

DATE DETAILS PREPARED

6th September 2024



GROUND FLOOR
235 sq.ft. (21.8 sq.m.) approx.

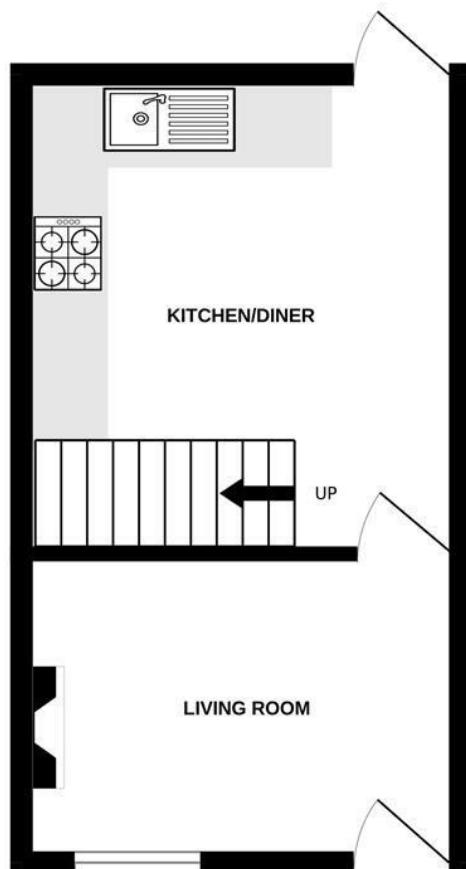

1ST FLOOR
237 sq.ft. (22.0 sq.m.) approx.

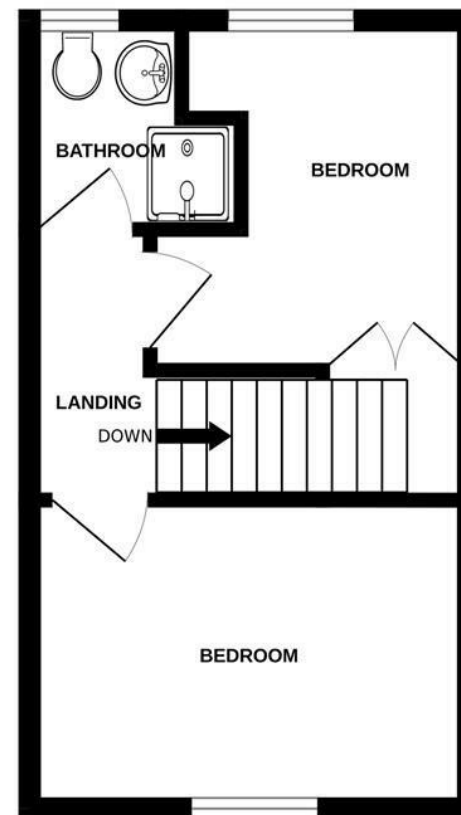

TOTAL FLOOR AREA : 472 sq.ft. (43.9 sq.m.) approx.

Whilst every attempt has been made to ensure the accuracy of the floorplan contained here, measurements of doors, windows, rooms and any other items are approximate and no responsibility is taken for any error, omission or mis-statement. This plan is for illustrative purposes only and should be used as such by any prospective purchaser. The services, systems and appliances shown have not been tested and no guarantee as to their operability or efficiency can be given.

Made with Metropix ©2024



These particulars are set out as a general outline in accordance with the Property Misdescriptions Act (1991) only for the guidance of intending purchasers or lessees, and do not constitute any part of an offer or contract. Details are given without any responsibility, and any intending purchasers, lessees or third parties should not rely on them as statements or representations of fact, but must satisfy themselves by inspection or otherwise as to the correctness of each of them. We have not carried out a structural survey and the services, appliances and specific fittings have not been tested. All photographs, measurements, floor plans and distances referred to are given as a guide only and should not be relied upon for the purchase of carpets or any other fixtures or fittings. Gardens, roof terraces, balconies and communal gardens as well as tenure and lease details cannot have their accuracy guaranteed for intending purchasers. Lesser details, service ground rent (where applicable) are given as a guide only and should be checked and confirmed by your solicitor prior to exchange of contracts.



Christophers Estate Agents

5 Wendron Street, Helston, TR13 8PT

01326 565566 | property@christophers.uk.com | christophers.uk.com

CHRISTOPHERS
ESTATE AGENTS