



## Rose Street, Rodbourne, SN2 2HJ

**Asking Price £199,950**

- New to the Market
- Modern Kitchen
- Double Garage
- No Onward Chain
- Three Bedroom House
- Bathroom Suite
- Close to Local Amenities
- Spacious Open Plan Living Room/Diner
- Enclosed Garden
- Ideal First Time Buy or Investment

**We are delighted to present a well-positioned, three-bedroom mid-terrace house situated in the highly desirable area of Rodbourne, Swindon. This property features an entrance hallway, a spacious open-plan living room/diner, a modern kitchen, three bedrooms, and a family bathroom suite. Additionally, the house benefits from an enclosed garden with access to a double garage. This property is being offered with no onward chain.**

**EPC Rating - D**

**Council Tax Band - B**

**Heating Type - Gas Central Heating**

**Freehold**







GROUND FLOOR  
441 sq.ft. (41.0 sq.m.) approx.

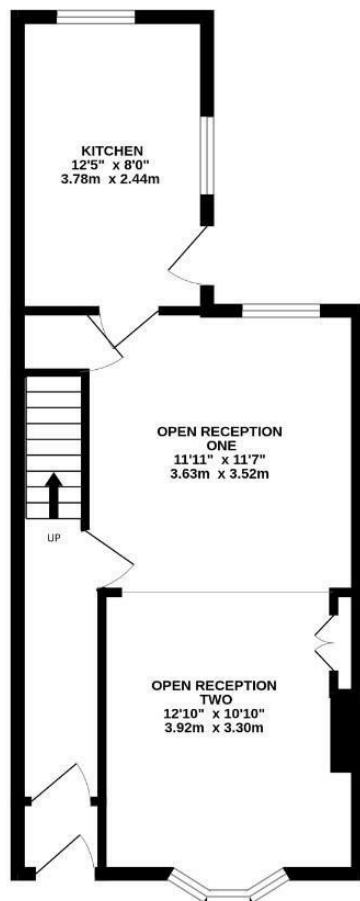

1ST FLOOR  
434 sq.ft. (40.3 sq.m.) approx.



TOTAL FLOOR AREA : 875 sq.ft. (81.3 sq.m.) approx.

Whilst every attempt has been made to ensure the accuracy of the floorplan contained here, measurements of doors, windows, rooms and any other items are approximate and no responsibility is taken for any error, omission or mis-statement. This plan is for illustrative purposes only and should be used as such by any prospective purchaser. The services, systems and appliances shown have not been tested and no guarantee as to their operability or efficiency can be given.  
Made with Metropix ©2025