



Dryden Street, Town Centre, Swindon, SN1 5LA

Asking Price £175,000

- New to the Market
- Two Double Bedrooms
- Gas Central Heating
- No Onward Chain
- Two Reception Rooms
- Ground Floor Bathroom Suite
- Central Location
- Kitchen with Appliances
- Enclosed Garden with Gated Rear Access
- Ideal Investment or First Time Purchase

We are delighted to present a well-positioned two-bedroom terrace house situated in the heart of Swindon town centre. This property offers an excellent opportunity for either investment or as a first-time home. The accommodation includes two reception rooms, a kitchen with appliances, two double bedrooms, and a ground floor bathroom suite. Additionally, the property features an enclosed garden with gated rear access. This property is available with no onward chain.

EPC Rating - C

Council Tax Band - B

Heating Type - Gas Central Heating

Freehold





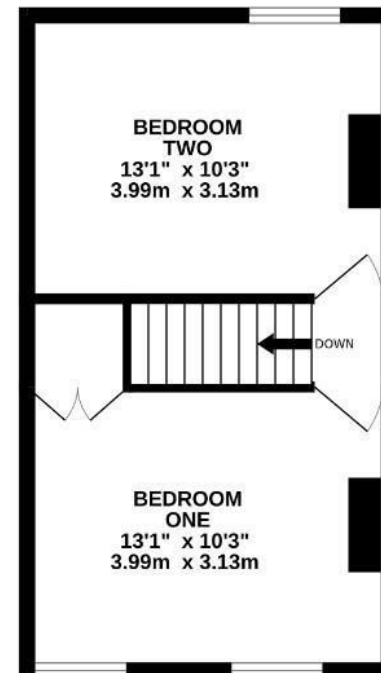
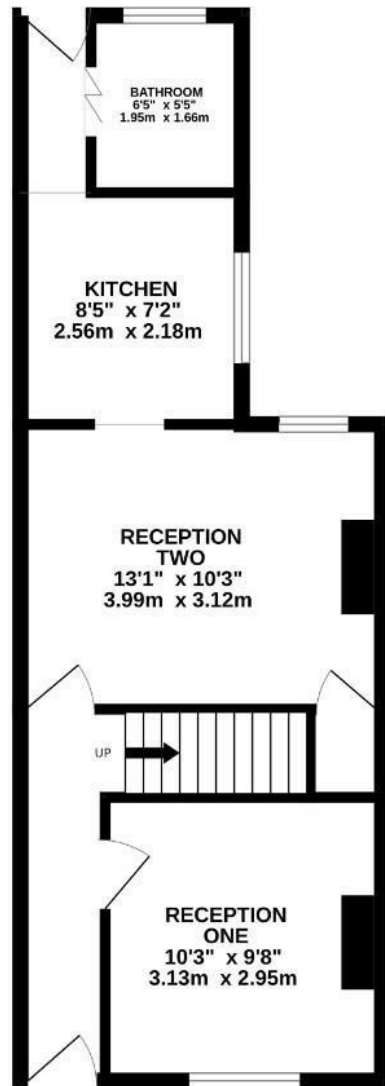

TOTAL FLOOR AREA : 724 sq.ft. (67.3 sq.m.) approx.

Whilst every attempt has been made to ensure the accuracy of the floorplan contained here, measurements of doors, windows, rooms and any other items are approximate and no responsibility is taken for any error, omission or mis-statement. This plan is for illustrative purposes only and should be used as such by any prospective purchaser. The services, systems and appliances shown have not been tested and no guarantee as to their operability or efficiency can be given.
Made with Metropix 6/2025