



Oxford House, Redhouse Way, Redhouse, SN25 2GJ

Asking Price £150,000

- New to the Market
- Living Room / Diner
- Bathroom Suite
- No Onward Chain
- Sought After Location
- Fully Fitted Kitchen
- Garage & Parking for One Car
- Two Bedroom Top Floor Apartment
- Two Double Bedrooms
- Ideal First Time Buy or Buy to Let Investment

We are excited to present this beautifully positioned, two-double-bedroom top-floor apartment, located in the desirable area of North Swindon. Consisting of; spacious hallway, living room/diner with bay effect windows, fully fitted kitchen, two double bedrooms and bathroom suite. The property includes a garage, one parking space and additional visitor parking. Overlooking a well-maintained park, it is within walking distance of the local village center and offers convenient access to schools, amenities, and the A419. Plus, there's No Onward Chain.

EPC Rating - C

Council Tax Band - C

Heating Type - Gas Central Heating

Leasehold

135 Years Remaining

Approx £2,124.31 Service Charge Per Year (January-December 2025)

Approx £189.00 Ground Rent Per Year (Half Payment Every 6-Months)





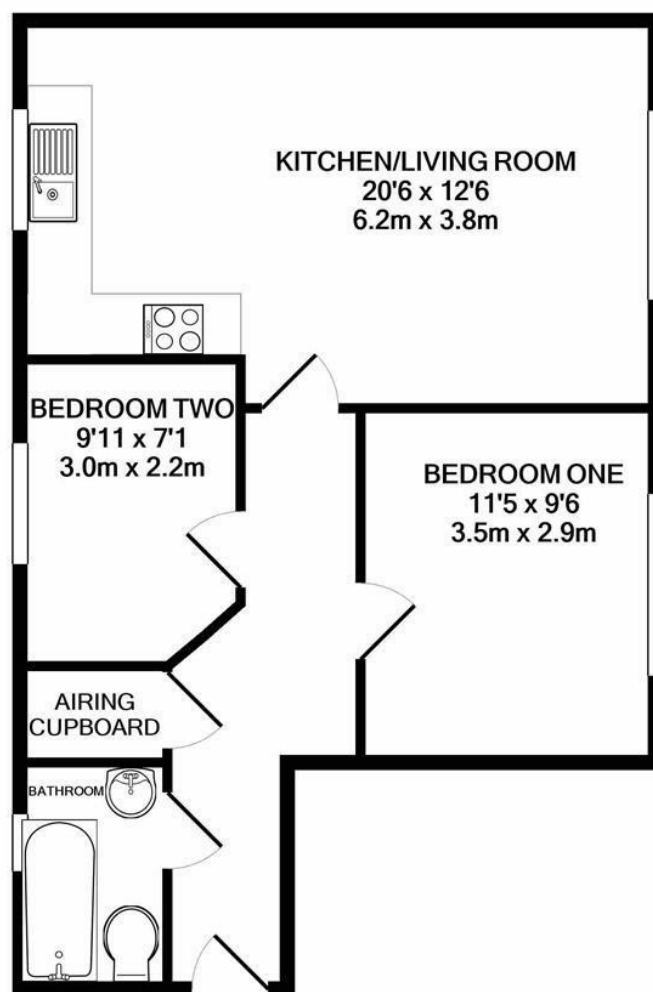

TOTAL APPROX. FLOOR AREA 555 SQ.FT. (51.6 SQ.M.)

Whilst every attempt has been made to ensure the accuracy of the floor plan contained here, measurements of doors, windows, rooms and any other items are approximate and no responsibility is taken for any error, omission, or mis-statement. This plan is for illustrative purposes only and should be used as such by any prospective purchaser. The services, systems and appliances shown have not been tested and no guarantee as to their operability or efficiency can be given