



## Windrush, Highworth, SN6 7EB

**Asking Price £295,000**

- New to the Market
- Modern Kitchen/Diner with Integral Appliances
- Home Office Garage Conversion
- Large Corner Plot with Potential to Extend S.T.P.P.
- Three Bedroom Semi-Detached Family Home
- Three Good Sized Bedrooms
- Maintenance Free Rear Garden with Gated Access
- Open Plan Living Room with Feature Log Burner
- Stylish Fully Tiled Bathroom Suite
- Rear Driveway Parking



Ridgeway are delighted to offer the market a beautifully positioned Three Bedroom Family Home, that has been modernized by the current vendors to an incredibly high standard. This property is situated on an end plot within the much sought after area of Highworth. The accommodation comprises of a Entrance Hallway, Open Plan Living Room with Feature Log Burner, Modern Kitchen/Diner with Integral Appliances, Three Good Sized Bedrooms and a Stylish Fully Tiled Bathroom Suite. This wonderful home also benefits from a Home Office Garage Conversion, Maintenance Free Rear Garden with Gated Access and Rear Driveway Parking.

Epc Rating- D  
Council Tax Band- B  
Gas Central Heating  
Freehold

Note; In accordance with the Estate Agency Act Of 1979, we are obliged to let you know that the owners are in connection with our agency.







GROUND FLOOR  
393 sq.ft. (36.5 sq.m.) approx.

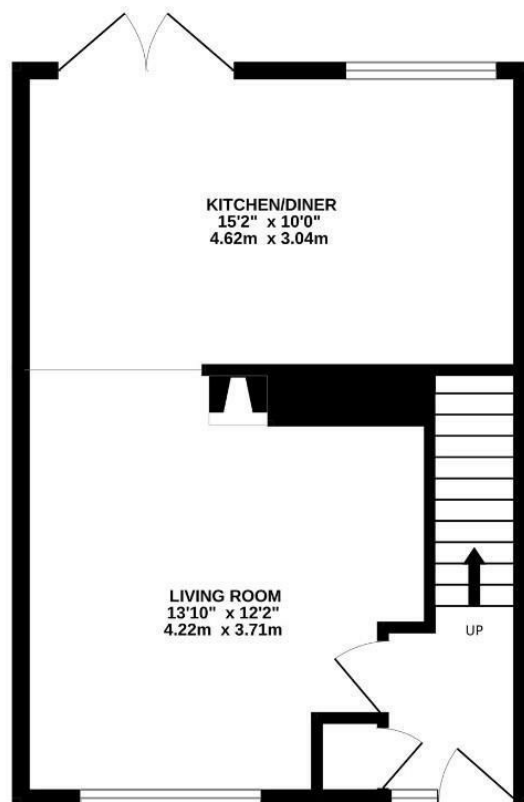

1ST FLOOR  
405 sq.ft. (37.6 sq.m.) approx.

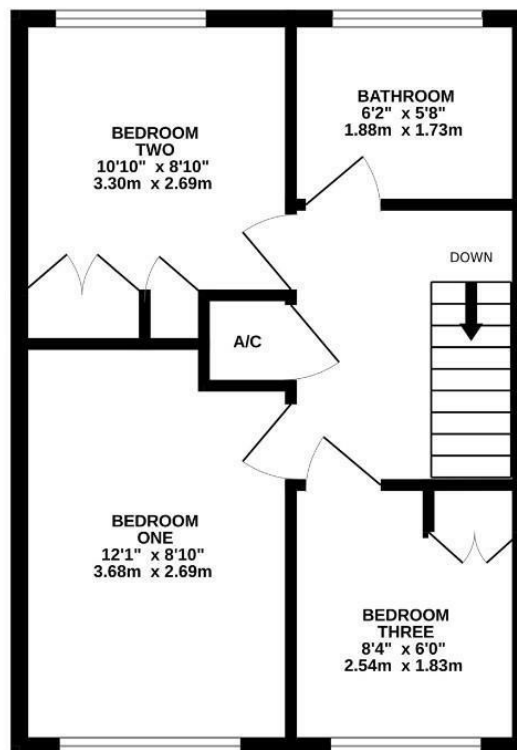

GARDEN ROOM  
121 sq.ft. (11.2 sq.m.) approx.

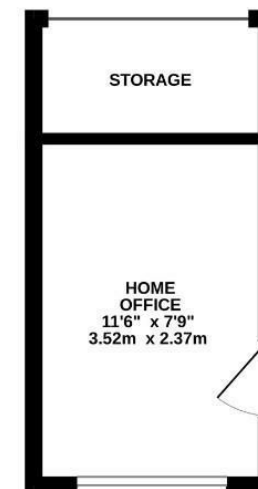

TOTAL FLOOR AREA : 918 sq.ft. (85.3 sq.m.) approx.

Whilst every attempt has been made to ensure the accuracy of the floorplan contained here, measurements of doors, windows, rooms and any other items are approximate and no responsibility is taken for any error, omission or mis-statement. This plan is for illustrative purposes only and should be used as such by any prospective purchaser. The services, systems and appliances shown have not been tested and no guarantee as to their operability or efficiency can be given.

Made with Metropix ©2025