



Priam House, Fire Fly Avenue, SN2 2EH

Asking Price £155,000

- New to the Market
- French Doors to Balcony
- Secured Allocated Parking
- Ideal Investment or First Time Home
- One Bedroom Top Floor Apartment
- Double Bedroom
- Sought After Location
- Large Open Plan Living Room/Kitchen
- Bathroom Suite
- Close to Local Amenities

Ridgeway Estate Agents is excited to present a spacious one-bedroom, top-floor apartment in the heart of Swindon's heritage district. This well-maintained property features: entrance hallway, open-plan living room/kitchen with French doors leading to a private balcony, double bedroom, bathroom suite and allocated parking. No Onward Chain.

The apartment is ideally located just a stone's throw from the McArthurGlen Designer Outlet Village and within walking distance of both the town centre and the railway station.

EPC Rating- C
Council Tax Band- B
Heating Type- Electric Heating
Leasehold

985 Years Remaining
Approx £1,546.76 Service Charge Per Year (Includes Building Insurance)
£200.00 Ground Rent Per Year





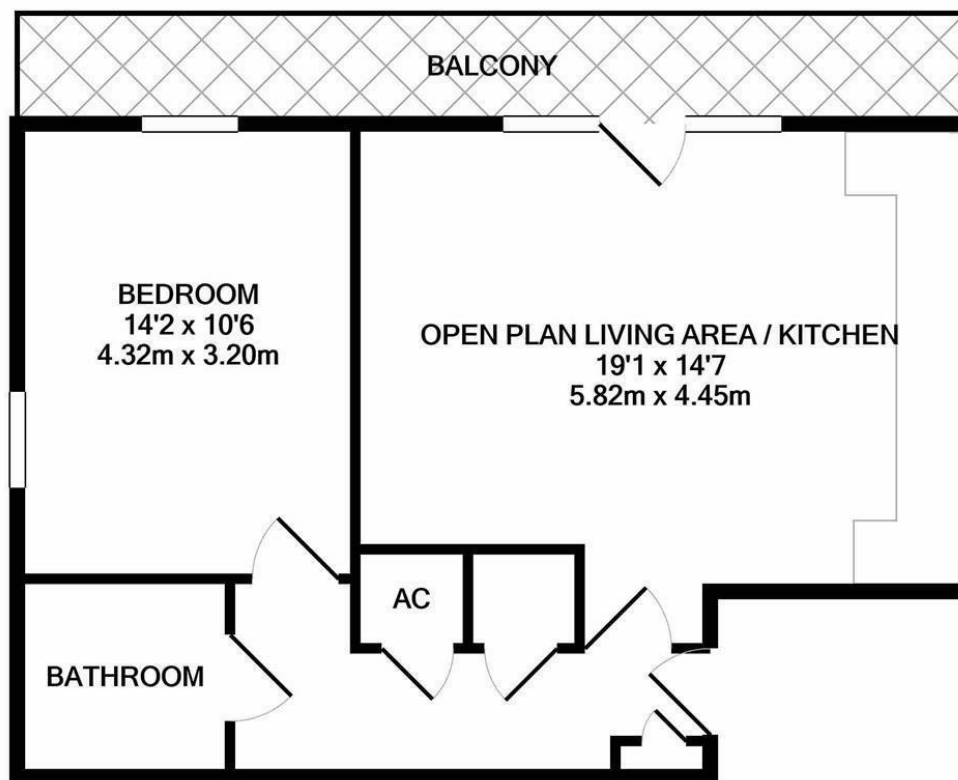

TOTAL APPROX. FLOOR AREA 556 SQ.FT. (51.6 SQ.M.)

Whilst every attempt has been made to ensure the accuracy of the floor plan contained here, measurements of doors, windows, rooms and any other items are approximate and no responsibility is taken for any error, omission, or mis-statement. This plan is for illustrative purposes only and should be used as such by any prospective purchaser. The services, systems and appliances shown have not been tested and no guarantee as to their operability or efficiency can be given

Made with Metropix ©2022