



Flat 3 The Hendre, Overton Park Road, Cheltenham,

Asking Price £180,000

- New to the Market
- Double Bedroom
- Close to Local Amenities
- No Onward Chain
- Living/Dining Room
- Bathroom Suite with Shower Over
- Sought After Location
- Compact Fitted Kitchen
- Allocated Parking Space
- Ideal Investment or First Time Buy

GROUND FLOOR
464 sq.ft. (43.1 sq.m.) approx.

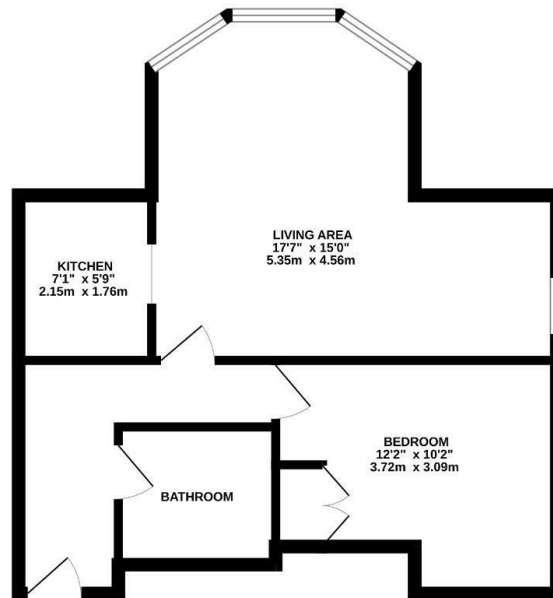

TOTAL FLOOR AREA: 464 sq.ft. (43.1 sq.m.) approx.
Whilst every attempt has been made to ensure the accuracy of the floorplan contained herein, measurements of doors, windows, rooms and any other items are approximate and no responsibility is taken for any error, omission or misstatement. This plan is for illustrative purposes only and should be used as such for any prospective purchaser. The services, systems and appliances shown have not been tested and no guarantee as to their capability or efficiency can be given.
Made with Metropix 10/2025

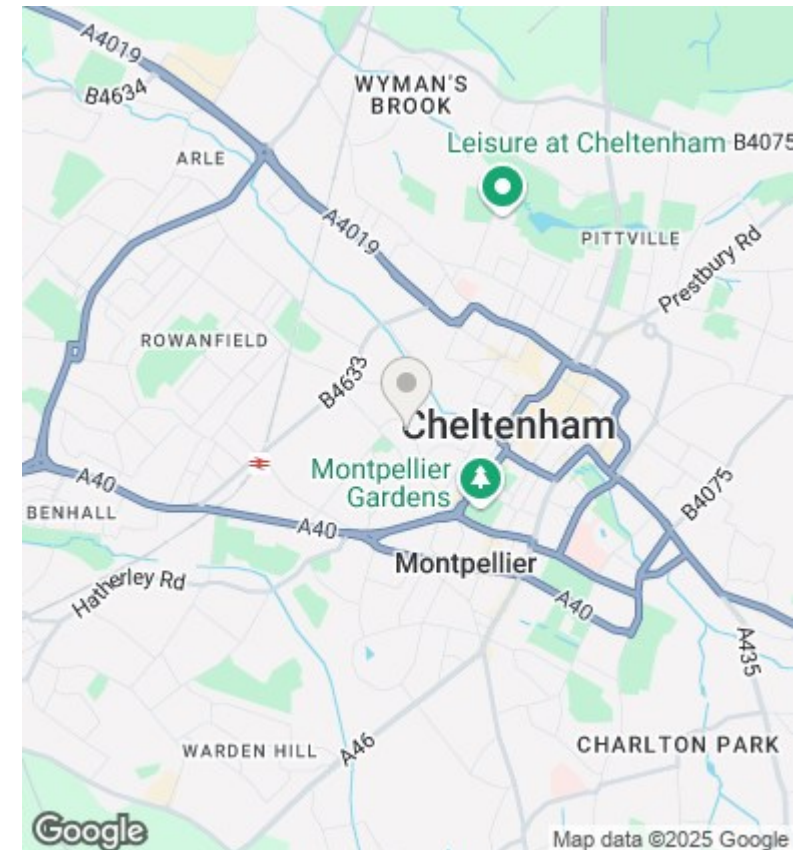

Directions

Viewings

Viewings by arrangement only. Call 01793 530167 to make an appointment.

Council Tax Band

C

EPC Rating:

D

Energy Efficiency Rating		
	Current	Potential
Very energy efficient - lower running costs		
(92-plus) A		
(81-91) B		78
(69-80) C	64	
(55-68) D		
(39-54) E		
(21-38) F		
(1-20) G		
Not energy efficient - higher running costs		
England & Wales		EU Directive 2002/91/EC